

CLAY BUTTE SE  
41° 45' N  
109° 15' W

UNITED STATES  
DEPARTMENT OF THE INTERIOR  
GEOLOGICAL SURVEY

RELiance QUADRANGLE  
WYOMING-SWEETWATER CO.  
7.5 MINUTE SERIES (TOPOGRAPHIC)  
NW 1/4 ROCK SPRINGS 15' QUADRANGLE

OPEN FILE REPORT 79-1021  
PLATE 27 OF 32

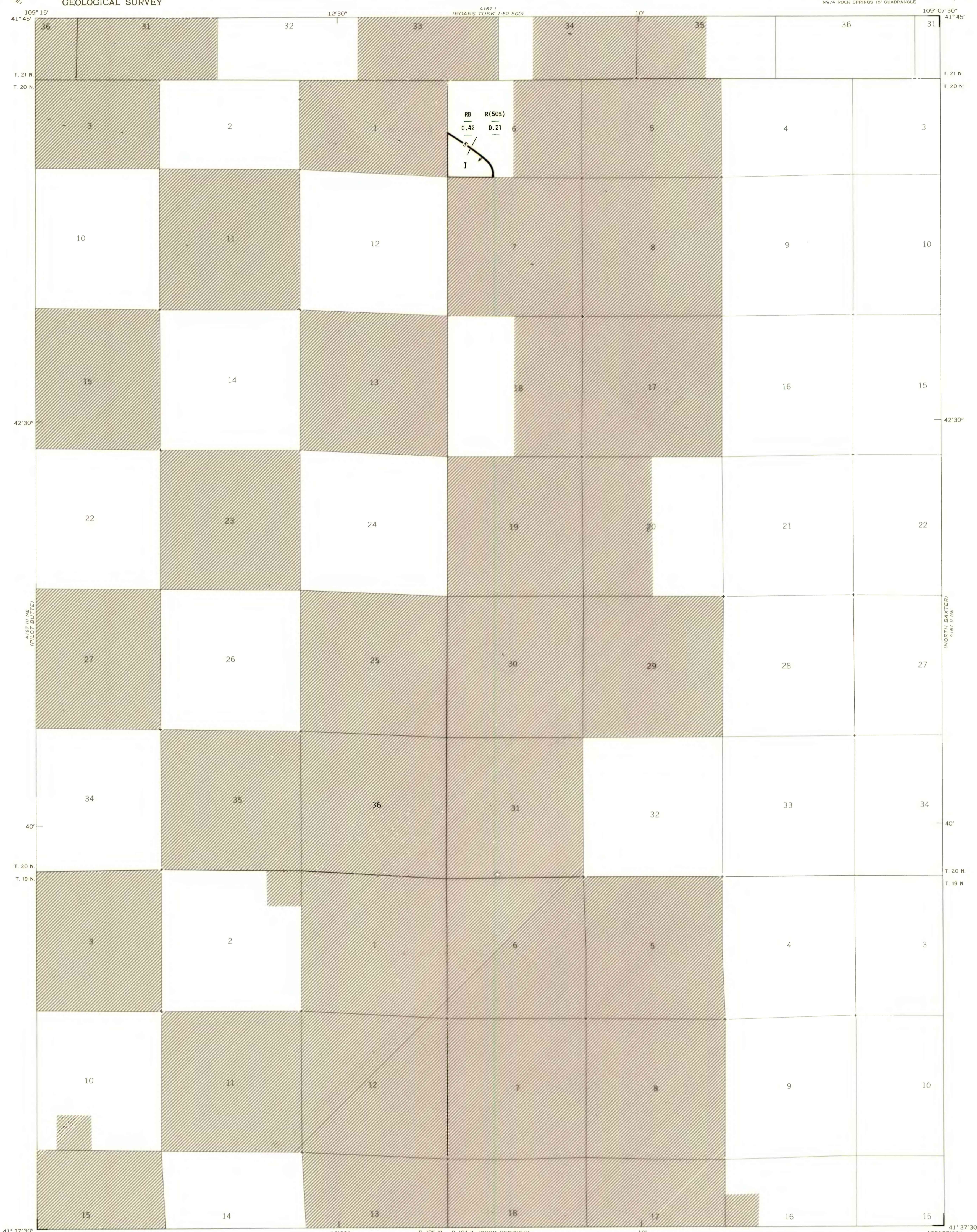

EXPLANATION

- NON-FEDERAL COAL LAND - Land for which the Federal Government does not own the coal rights.
- ISOPACH - Showing thickness of coal, in feet. Arrow points toward area where coal bed is 5 feet or more thick.
- RS-3 - Rock Springs No. 3 COAL BED SYMBOL AND NAME
- RB R(50%) (Measured)  
0.42 0.21 (Indicated)  
0.42 0.21 (Inferred)
- IDENTIFIED COAL RESOURCES - Showing totals for Reserve Base (RB) and Reserves (R), in millions of short tons, for each section or part of section of non-leased Federal coal land, both within and beyond the striping-limit line. Reserve (R) tonnage is calculated by multiplying the Reserve Base (RB) tonnage by the appropriate recovery factor. Dash indicates no resource in that category.

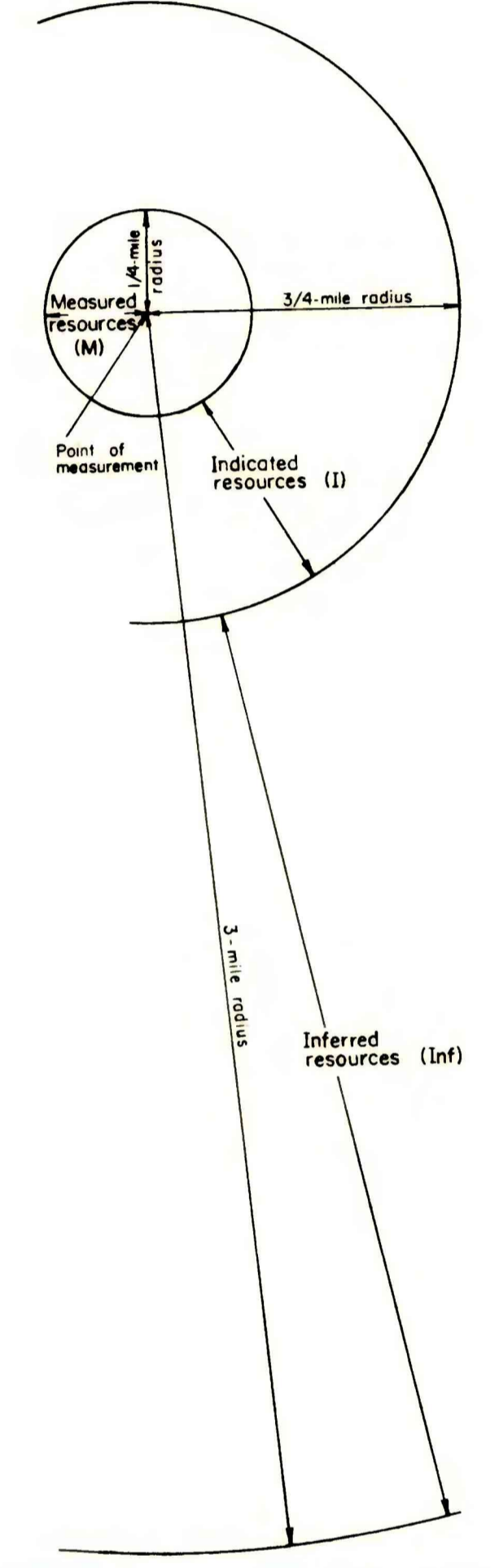

BOUNDARY LINES - Enclosing areas of measured (M), indicated (I), and inferred (Inf) coal resources.

To convert feet to meters, multiply feet by 0.3048.

To convert short tons to metric tons, multiply short tons by 0.9072.

To convert miles to kilometers, multiply miles by 1.609.

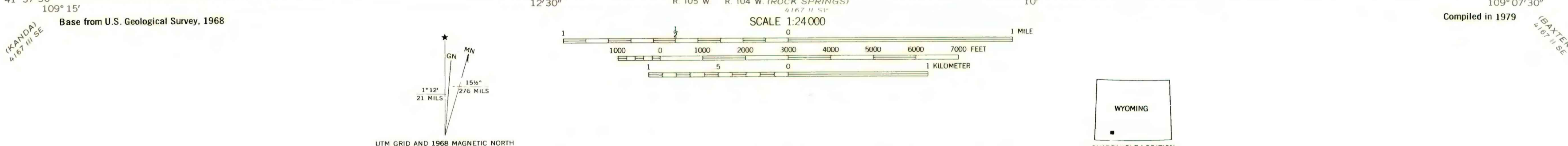

**COAL RESOURCE OCCURRENCE MAP OF THE RELIANCE QUADRANGLE, SWEETWATER COUNTY, WYOMING**  
 BY  
**DAMES & MOORE**  
 1979

This report has not been edited for conformity with U.S. Geological Survey editorial standards or stratigraphic nomenclature.