

EXPLANATION

-  ISOPACHS - Showing thickness of coal, in feet. Long dashed where inferred. Isopach interval 1 foot.
 -  DRILL HOLE - Showing thickness of coal, in feet.
 -  POINT OF MEASUREMENT - Showing thickness of coal, in feet. Includes all points of measurement other than drill holes.
 - FR - Fillmore Ranch
 - COAL BED SYMBOL AND NAME
 -  TRACE OF COAL BED OUTCROP - Showing symbol of name of coal bed as listed above. Arrow points toward coal-bearing area. Dashed where inferred.
 -  INFERRED LIMIT OF BURNED AND CLINKERED COAL - Arrow points toward area of baked and fused rock.
 -  3,000-FOOT OVERBURDEN ISOPACH - Showing depth limit beyond which resources are not considered. Arrow points toward area where overburden is 3,000 feet or less thick.
 -  TRACE OF FAULT - Bar and ball on down-thrown side when direction of movement is known. Dashed where inferred or approximately located.
- To convert feet to meters, multiply feet by 0.3048.

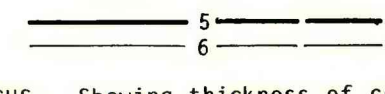
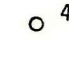
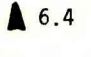
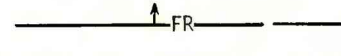
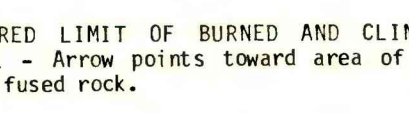
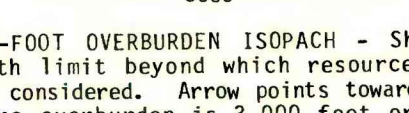
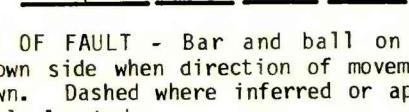
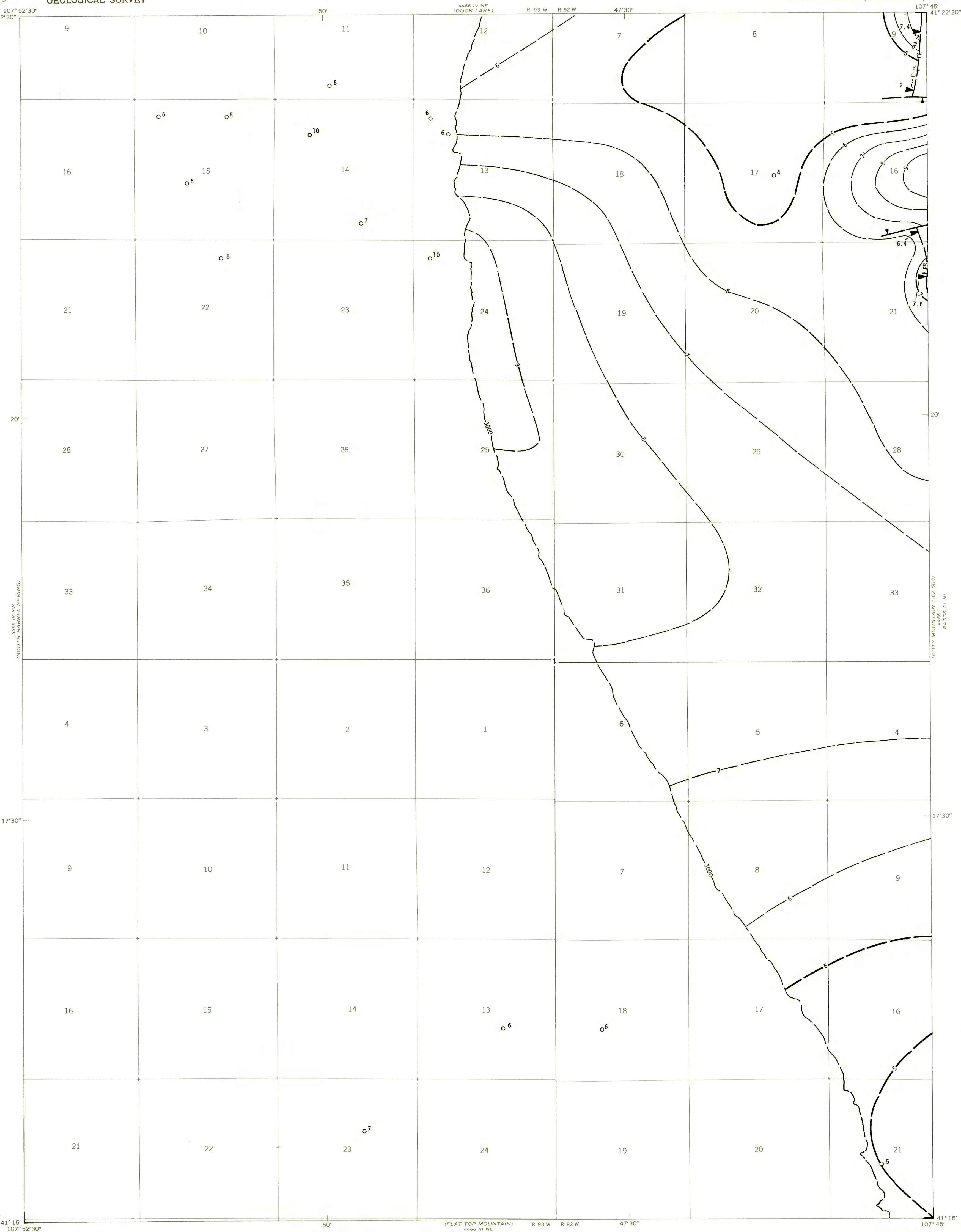

**COAL RESOURCE OCCURRENCE MAP OF THE MEXICAN FLATS
QUADRANGLE, CARBON COUNTY, WYOMING**
BY
DAMES & MOORE
1979

This report has not been edited for conformity with U.S. Geological Survey editorial standards or stratigraphic nomenclature.