

EXPLANATION

— 1800 —
OVERBURDEN ISOPACHS - Showing thickness of overburden, in feet, from surface to top of coal bed. Dashed where vertical accuracy possibly not within 40 feet. Isopach interval 200 feet (61 m).

○ 1714
DRILL HOLE - Showing thickness of overburden, in feet, from surface to top of coal bed.

COAL BED SYMBOLS AND NAMES - Coal beds identified by bracketed numbers are not formally named, but are numbered for identification purposes in this quadrangle only.

—●—
TRACE OF FAULT - Bar and ball on down-thrown side when direction of movement is known. Dashed where inferred or approximately located.

To convert feet to meters, multiply feet by 0.3048.

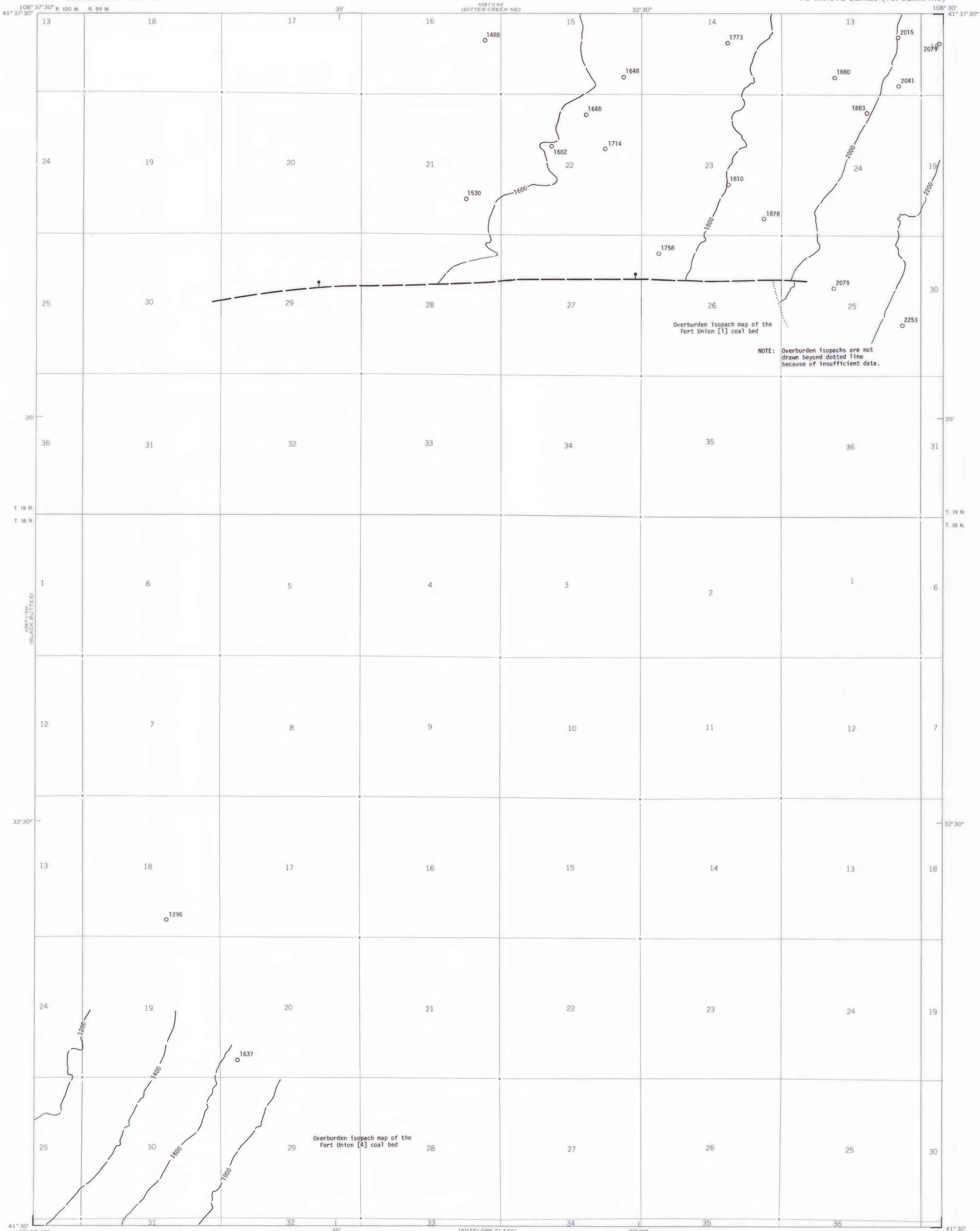

NOTE: Overburden isopachs are not drawn beyond dotted line because of insufficient data.

Overburden isopach map of the Fort Union [4] coal bed

COAL RESOURCE OCCURRENCE MAP OF THE BITTER CREEK QUADRANGLE, SWEETWATER COUNTY, WYOMING

BY
DAMES & MOORE
1979

This report has not been edited for conformity with U.S. Geological Survey editorial standards or stratigraphic nomenclature.

PLATE 5
OVERBURDEN ISOPACH MAPS OF THE FORT UNION [1] AND [4] COAL BEDS

1871-1897 (1898-1900 NW)
 1898-1900 (1901-1904 NW)
 1898-1900 (1905-1908 NW)
 1898-1900 (1909-1912 NW)

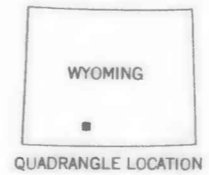
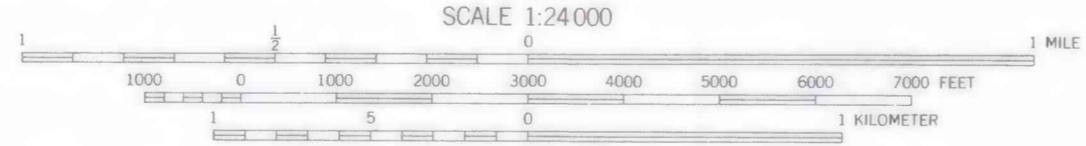
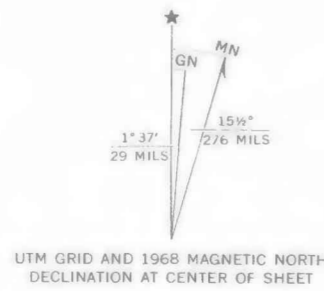

Compiled in 1977/1978

Base from U.S. Geological Survey, 1968