

100° 16' 30" W
162° 50' 00"

UNITED STATES
DEPARTMENT OF THE INTERIOR
GEOLOGICAL SURVEY

BROWNS HILL QUADRANGLE
WYOMING-CARBON CO.
7.5 MINUTE SERIES (TOPOGRAPHIC)

OPEN FILE REPORT 79-1034

PLATE 21 OF 29

107° 22' 30" W
162° 50' 00"

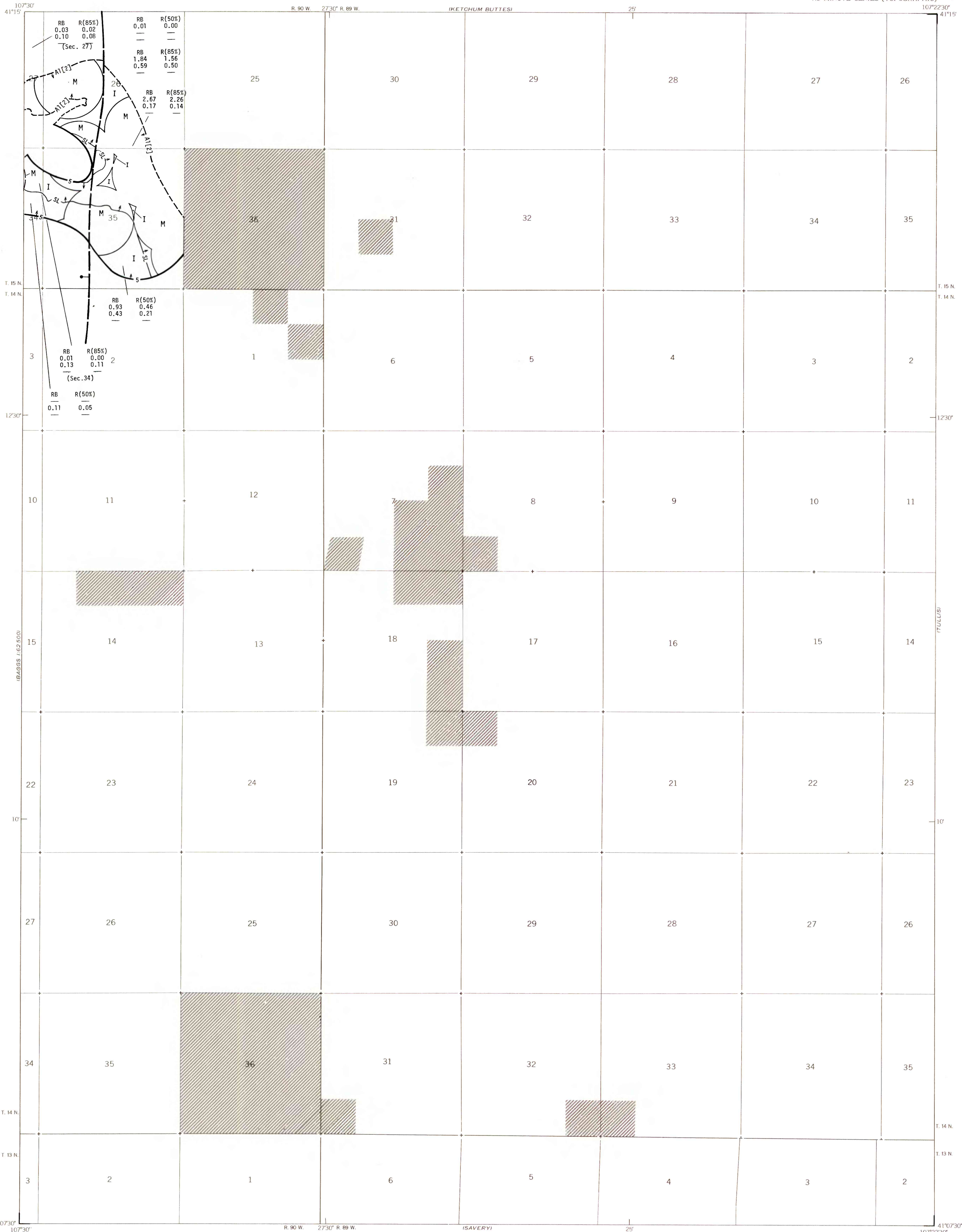

EXPLANATION

NON-FEDERAL COAL LAND - Land for which the Federal Government does not own the coal rights.

ISOPACH - Showing thickness of coal, in feet. Arrow points toward area where coal bed is 5 feet or more thick.

A1[2] - Almond [2]
COAL BED SYMBOL AND NAME - Coal bed identified by bracketed numbers is not formally named, but is numbered for identification purposes in this quadrangle only.

TRACE OF COAL BED OUTCROP - Showing symbol of name of coal bed as listed above. Arrow points toward coal-bearing area. Short dashed where inferred by present authors.

STRIPPING-LIMIT LINE - Boundary for surface mining (in this quadrangle, the 200-foot-overburden isopach). Arrow points toward the area suitable for surface mining where the recovery factor is 85 percent, and away from the area suitable for subsurface mining (down dip to the 3,000-foot-overburden isopach) where the recovery factor is 50 percent.

RB	R(85%)	RB	R(50%)
1.84	1.56	0.01	0.00
0.59	0.50	—	—
—	—	—	—

(Measured)
(Indicated)
(Inferred)

IDENTIFIED COAL RESOURCES - Showing totals for Reserve Base (RB) and Reserves (R), in millions of short tons, for each section or part of section of non-leased federal coal land, both within and beyond the stripping-limit line. Reserve (R) tonnage is calculated by multiplying the Reserve Base (RB) tonnage by the appropriate recovery factor. Dash indicates no resource in that category.

TRACE OF FAULT - Bar and ball on downthrown side. Dashed where inferred or approximately located.

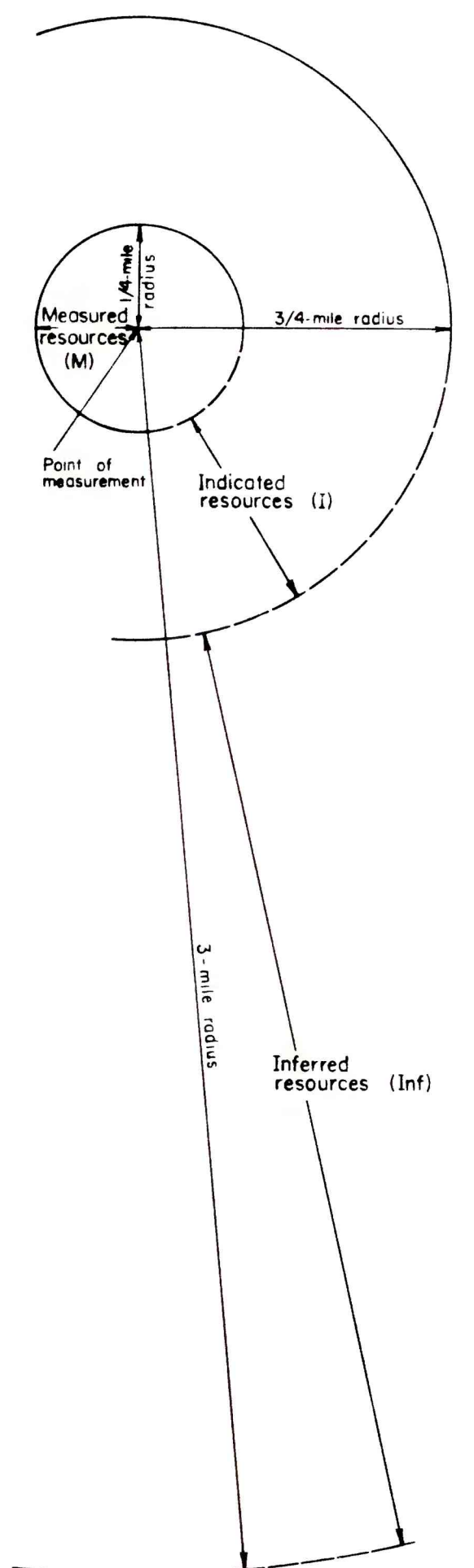

BOUNDARY LINES - Enclosing areas of measured (M), indicated (I), and inferred (Inf) coal resources. Dashed where projected from adjacent quadrangles.

To convert feet to meters, multiply feet by 0.3048.

To convert short tons to metric tons, multiply short tons by 0.9072.

To convert miles to kilometers, multiply miles by 1.6093.

This report has not been edited for conformity with U.S. Geological Survey editorial standards or stratigraphic nomenclature.

107° 30' W
162° 50' 00"

Base from U.S. Geological Survey, 1961

Compiled in 1979

107° 30' W
162° 50' 00"

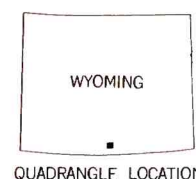
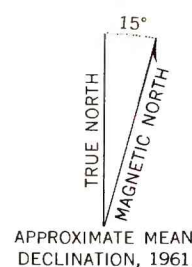

COAL RESOURCE OCCURRENCE MAP OF THE BROWNS HILL QUADRANGLE, CARBON COUNTY, WYOMING BY DAMES & MOORE 1979

PLATE 21
AREAL DISTRIBUTION
AND IDENTIFIED RESOURCES
MAP OF
THE ALMOND [2] COAL BED