

UNITED STATES  
DEPARTMENT OF THE INTERIOR  
GEOLOGICAL SURVEY

SOUTHEAST BAGGS QUADRANGLE  
WYOMING - COLORADO  
7.5 MINUTE SERIES (TOPOGRAPHIC)

PLATE 2 OF 20

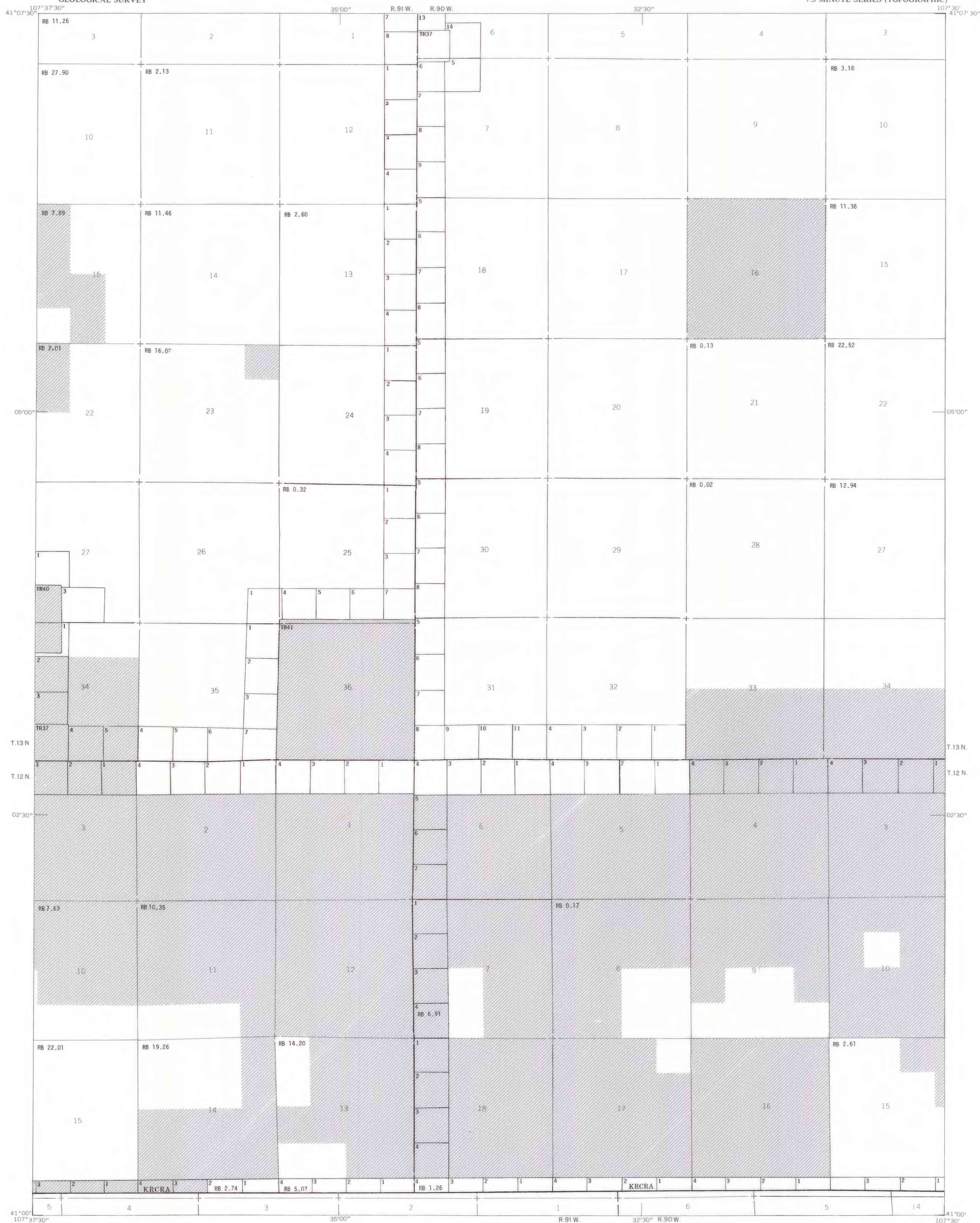

EXPLANATION

KRCRA  
KRCRA BOUNDARY (Proposed) -  
Label within KRCRA boundary.

NON-FEDERAL COAL LAND -  
Land for which the Federal  
Government does not own the  
coal rights.

TOTAL RESERVE BASE (RB) OF FEDERAL COAL PER SECTION - In millions of short tons, calculated for each section of Federal land following the guidelines given in U.S. Geol. Survey Bulletin 1450-B. To convert short tons to metric tons, multiply short tons by 0.9072.

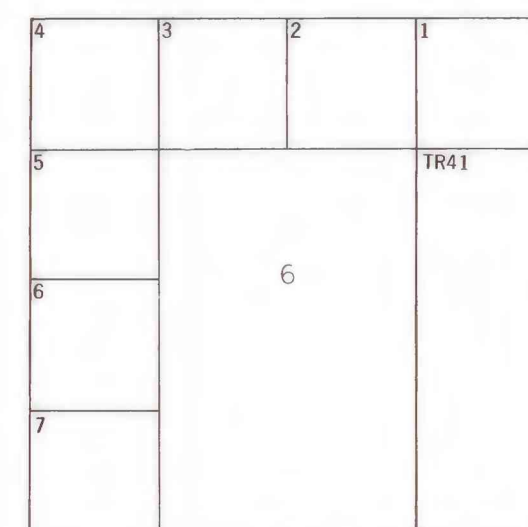

SECTION OF LAND - Showing lots and lot numbers; and tracts and tract numbers.

NOTE: BLM Coal Ownership Data current as of August 1, 1977.

REFERENCES

Barclay, C. S. V., Jobin, D. A., and Storrs, J. P., 1978, Minutes for the revision of the Rawlins (Little Snake River) Known Recoverable Coal Resource Area, Carbon and Sweetwater Counties, Wyoming, January 31, 1978; U.S. Geological Survey Conservation Division, unpublished report, 15 p.

U.S. Bureau of Mines and U.S. Geological Survey, 1976, Coal resource classification system of the U.S. Bureau of Mines and U.S. Geological Survey; U.S. Geol. Survey Bull. 1450-B, 7 p.

Base from U.S. Geological Survey, 1957

SCALE 1:24,000

Compiled in 1979

This report has not been edited for conformity with U.S. Geological Survey editorial standards or stratigraphic nomenclature.

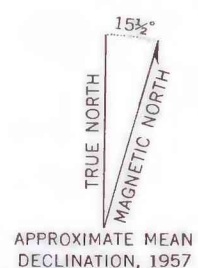

APPROXIMATE MEAN DECLINATION, 1957

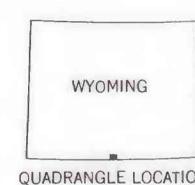

COAL RESOURCE OCCURRENCE MAP OF THE SOUTHEAST QUARTER OF THE BAGGS  
15-MINUTE QUADRANGLE, CARBON COUNTY, WYOMING  
BY  
DAMES & MOORE  
1979

PLATE 2  
BOUNDARY AND COAL  
DATA MAP