

UNITED STATES
DEPARTMENT OF THE INTERIOR
GEOLOGICAL SURVEY

SOUTHEAST BAGGS QUADRANGLE
WYOMING - COLORADO
7.5 MINUTE SERIES (TOPOGRAPHIC)

PLATE 14 OF 20

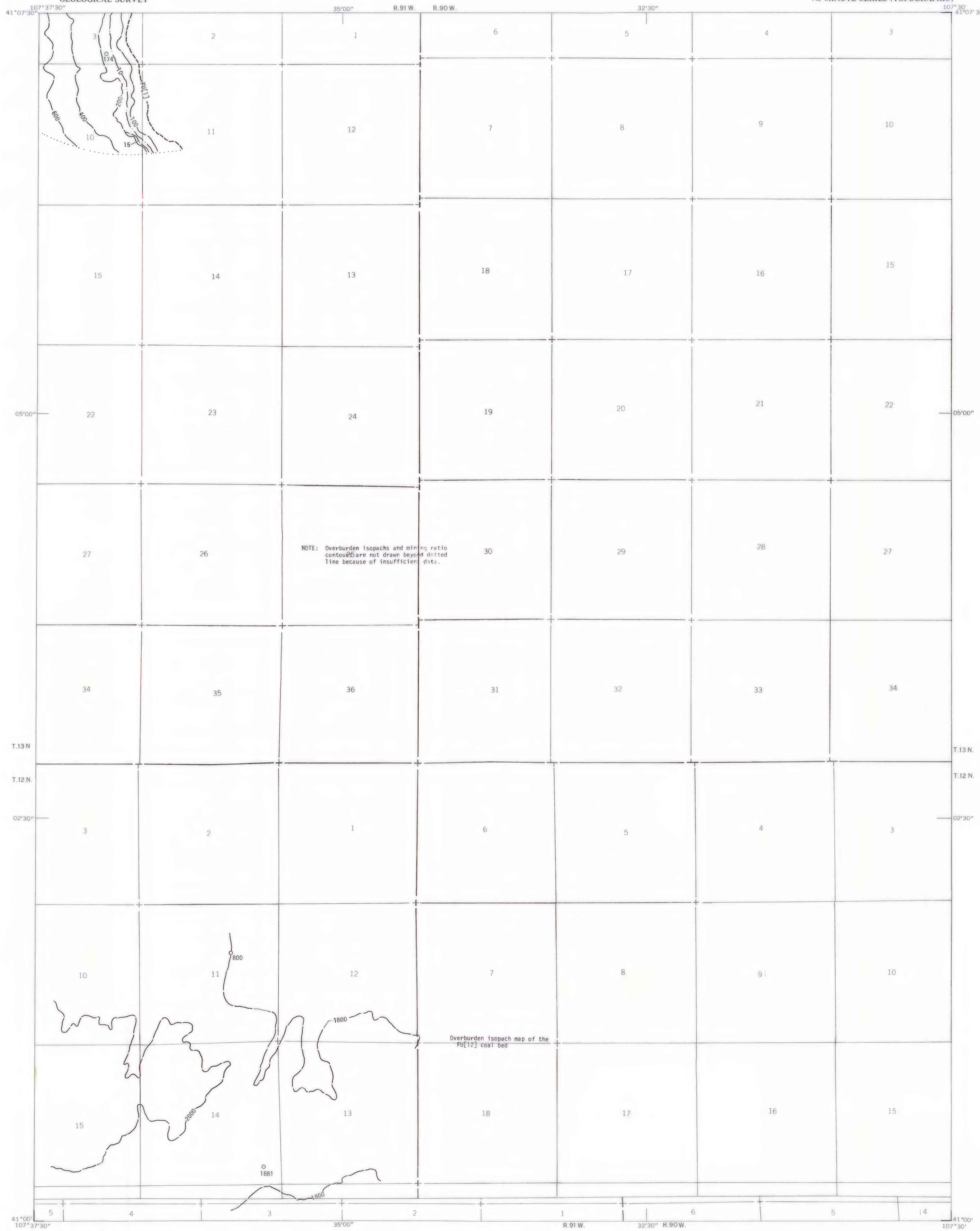

EXPLANATION

— 400 —
OVERBURDEN ISOPACHS - Showing thickness of overburden, in feet, from surface to top of coal bed. Dashed where vertical accuracy possibly not within 40 feet. Isopach interval 100 feet (31 m) over strip-pable coal and 200 feet (61 m) beyond the stripping-limit line.

○ 174
DRILL HOLE - Showing thickness of overburden, in feet, from surface to top of coal bed.

— 10 —
MINING-RATIO CONTOUR - Number indicates cubic yards of overburden per ton of recoverable coal by surface mining methods. Contours shown only in areas underlain by coal of Reserve Base thickness within the stripping-limit (in this quadrangle, the 200-foot-overburden isopach). To convert mining ratio to cubic meters of overburden per metric ton of recoverable coal, multiply mining ratio by 0.8428.

FU[12] - Fort Union [12]
FU[1] - Fort Union [1]
COAL BED SYMBOLS AND NAMES - Coal beds identified by bracketed numbers are not formally named, but are numbered for identification purposes in this quadrangle only.

----- FU[1] -----
TRACE OF COAL BED OUTCROP - Showing symbol of name of coal bed as listed above. Short dashed where inferred by present authors.

To convert feet to meters, multiply feet by 0.3048.

NOTE: Overburden isopachs and mining ratio contours are not drawn beyond dotted line because of insufficient data.

Overburden isopach map of the
FU[12] coal bed

Base from U.S. Geological Survey, 1957

Compiled in 1979

SCALE 1:24,000

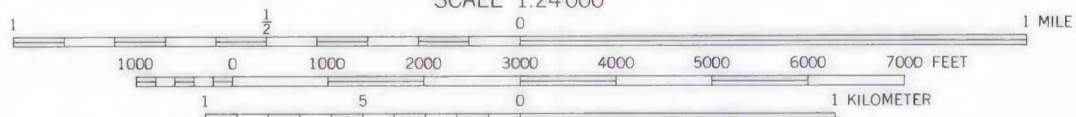

This report has not been edited for conformity with U.S. Geological Survey editorial standards or stratigraphic nomenclature.

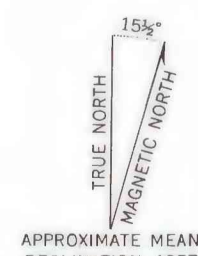

APPROXIMATE MEAN DECLINATION, 1997

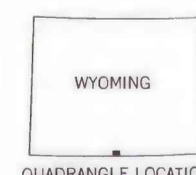

**COAL RESOURCE OCCURRENCE MAP OF THE SOUTHEAST QUARTER OF THE BAGGS
15-MINUTE QUADRANGLE, CARBON COUNTY, WYOMING**
BY
DAMES & MOORE
1979

PLATE 14

OVERBURDEN ISOPACH AND MINING RATIO
MAP OF THE FORT UNION [1]
COAL BED, AND OVERBURDEN ISOPACH
MAP OF THE FORT UNION [2] COAL BED