

This report has not been edited for conformity with Geological Survey editorial standards or stratigraphic nomenclature.

EXPLANATION

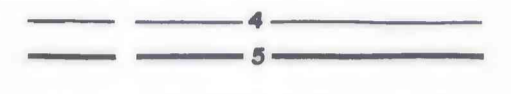

ISOPACHS OF THE MENEPEE CLEARY NO. 3 COAL BED—Showing thickness in feet. Isopach interval 1 foot (0.3 meter). Isopachs dashed where inferred.

○ ○ DRILL HOLE—Showing thickness of the Menepee Cleary No. 3 coal bed in feet.

To convert feet to meters, multiply feet by 0.3048.

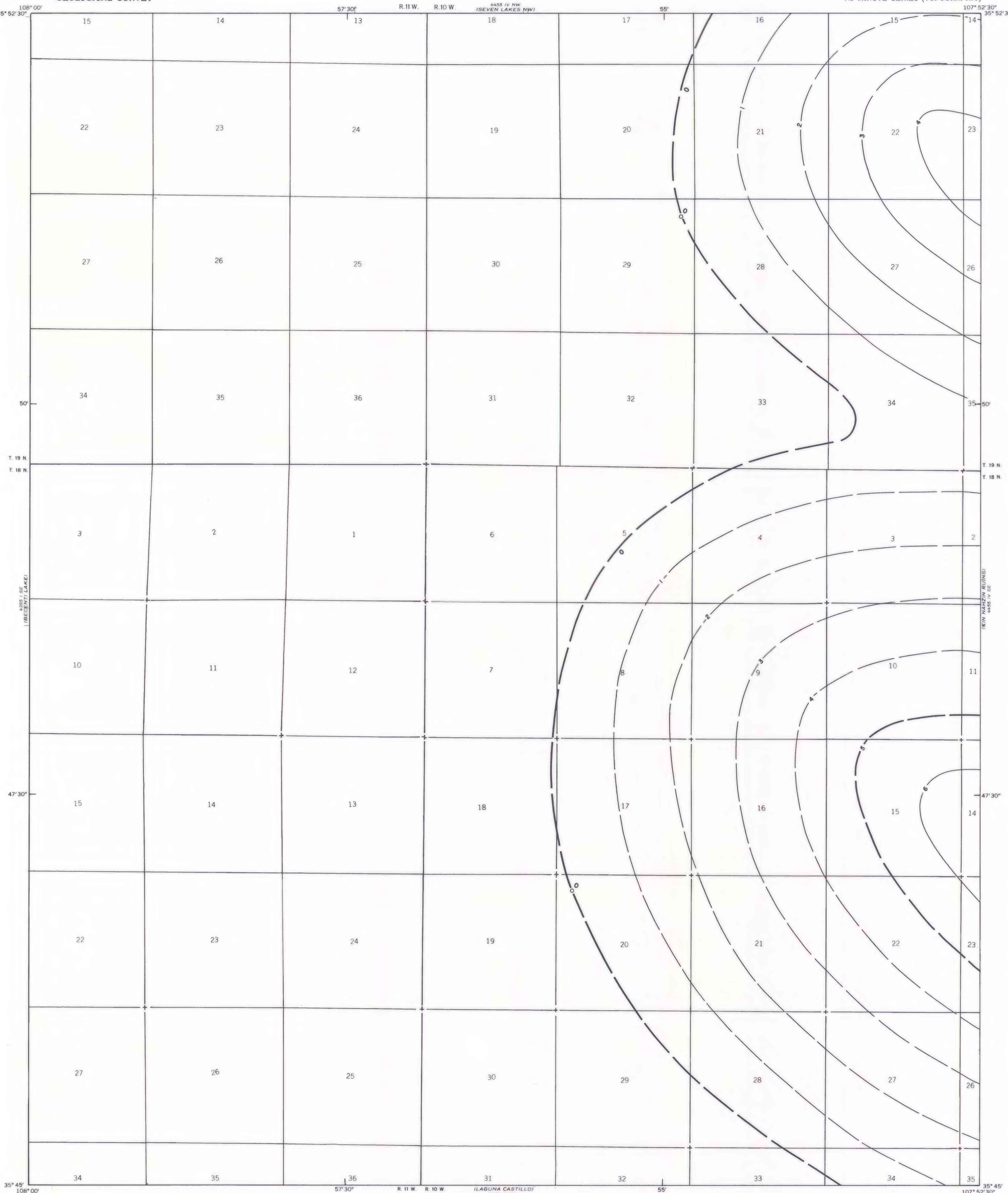

Base from U.S. Geological Survey, 1970

Compiled in 1978

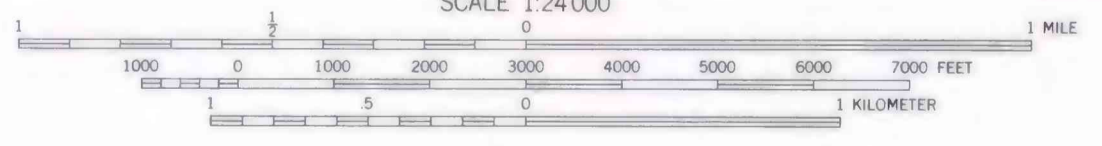
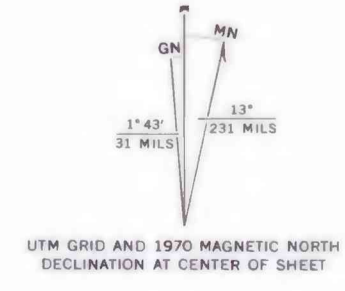

**COAL RESOURCE OCCURRENCE MAP OF THE SEVEN LAKES
QUADRANGLE, MCKINLEY COUNTY, NEW MEXICO**

BY
BERGE EXPLORATION, INC.
1979

PLATE 4
ISOPACH MAP OF THE
MENEPEE CLEARY NO. 3 COAL BED