

EXPLANATION

- GL 5870
NR 300
R 1089
C 4(Fr 1)
R 90
C 3(Fr 2)
R 0.1
C 1.4(Fr 2)
R 0.1
C 2.2(Fr 1)
R 0.1
C 1.6(Fr 1)
R 0.6
C 4.2(Fr 1)
R 0.6
C 0.8(Fr 1)
R 0.4
- DRILL HOLE - Shown solid oil and gas.
Showing drill hole data, in feet. Index
number refers to well on Plate 3 of CRD
map.
- GL 4000
R 2.2
C 1.7(Fr 2)
R 0.3
C 1.4(Fr 2)
NRE
C 3.94(Fr 1)
R 0.2
C 3.2(Fr 1)
R 0.5
C 4.2(Fr 1)
R 0.6
C 0.8(Fr 1)
R 0.4
- LINE OF MEASURED SECTION - Showing rock
interval and coal thickness, in feet.
Index number refers to measured section on
Plate 3 of CRD map.
- GL - Ground level elevation
NR - No record
R - Rock interval
C - Coal interval
TD - Total depth
NRE - No record of
lithology; interval
thickness estimated.
- TEST HOLE AND MEASURED SECTION DATA SYMBOLS
- Fr zone - Fruitland zone
Fr 2 - Fruitland 2 bed
Fr 1 - Fruitland 1 bed
Me zone - Menefee zone
L - Local bed
- COAL BED AND LOCAL ZONE SYMBOLS AND NAMES
- GL 5990
C 0.3(Fr 3)
R 0.5
C 4.9(Fr 3)
- TRACE OF COAL BED OUTCROP - Showing coal
thickness and rock interval, in feet,
measured at triangle. Index number refers
to measured section on Plate 3 of CRD map.
Arrow points toward the coal-bearing area.
Dashed line indicates inferred outcrop,
dotted where concealed.
- FAULT - Dashed where approximately located;
bar and ball on downthrow side.
- ABANDONED COAL MINE
- PROSPECT
- To convert feet to meters, multiply feet by
0.3048.
- NR is an average of 300 feet (91 m) of casing.
Actual depth of casing not shown.

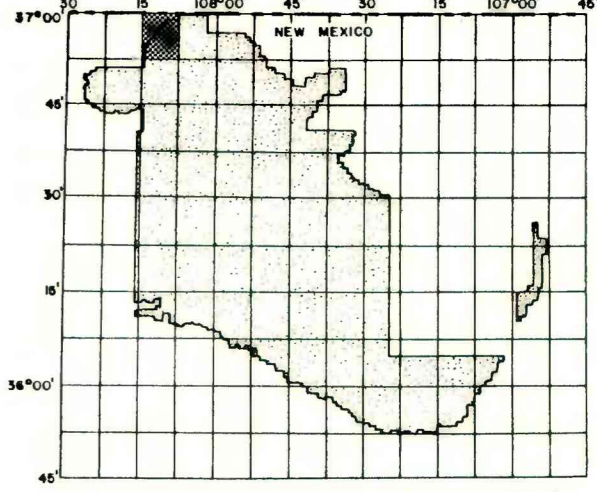
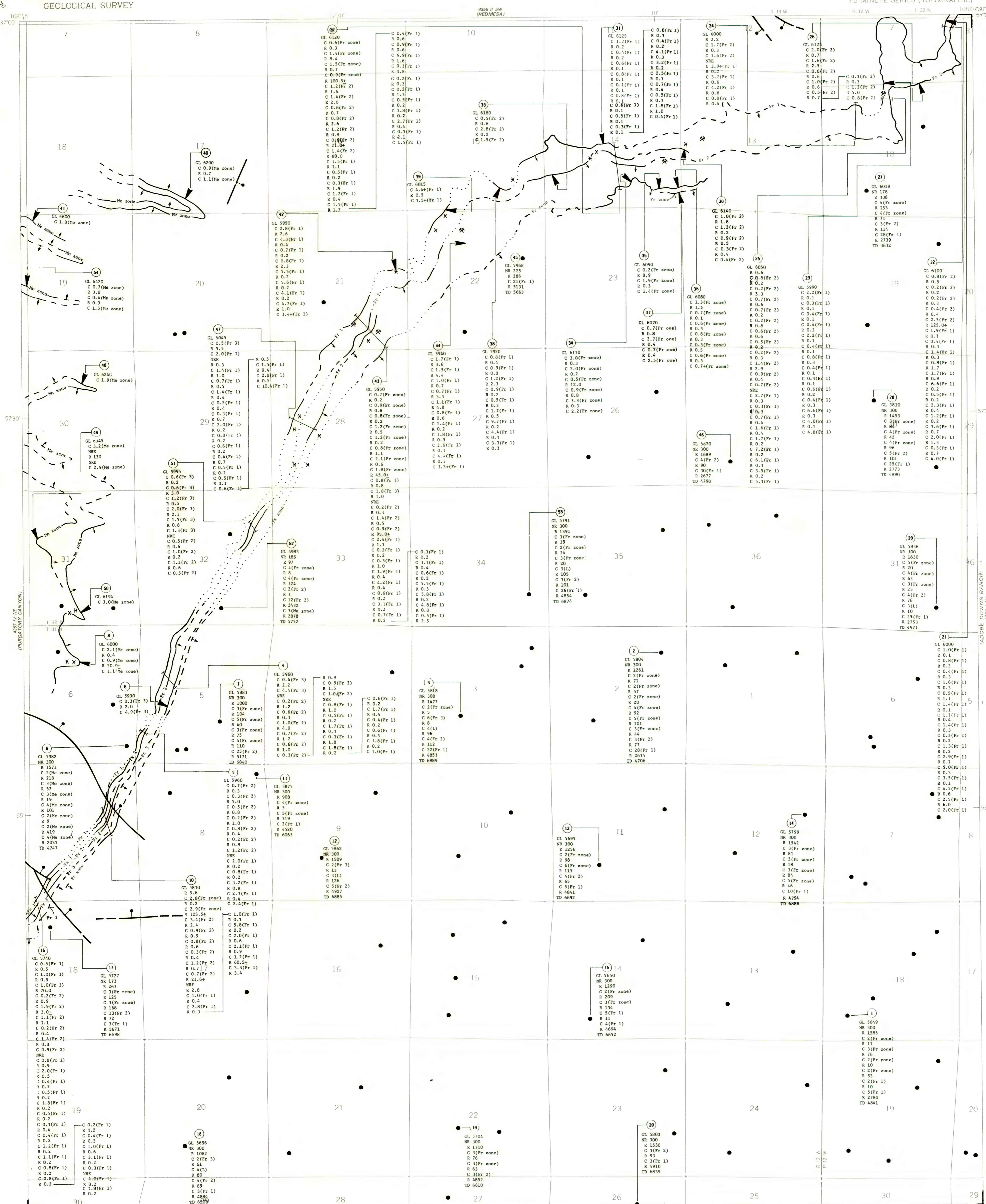

COAL RESOURCE OCCURRENCE MAP OF THE LA PLATA QUADRANGLE, SAN JUAN COUNTY, NEW MEXICO AND LA PLATA COUNTY, COLORADO

BY
DAMES & MOORE
1979

PLATE 1
COAL DATA MAP

This map was prepared under contract to the U.S. Geological Survey and has not been edited for conformity with Geological Survey editorial standards. Opinions and conclusions expressed herein do not necessarily represent those of the Geological Survey.

Base from U.S. Geological Survey, 1963

SCALE 1:24,000

CONTOUR INTERVAL 20 FEET
NATIONAL GEODETIC VERTICAL DATUM OF 1929

UTM GRID AND 1979 MAGNETIC NORTH DECLINATION AT CENTER OF SHEET

QUADRANGLE LOCATION

Compiled in 1979