

EXPLANATION

3500  
3550

STRUCTURE CONTOURS - Drawn on top of the Fruitland 1 coal bed. Contour interval 50 feet (15.2 meters). Datum is mean sea level. Contours dashed where projected through noncoal-bearing area.

DRILL HOLES - Showing altitude at the top of the Fruitland 1 coal bed, in feet.

To convert feet to meters, multiply feet by 0.3048.

Fruitland coal beds contoured as a single surface on this map are equivalent in stratigraphic position but may not be continuous.

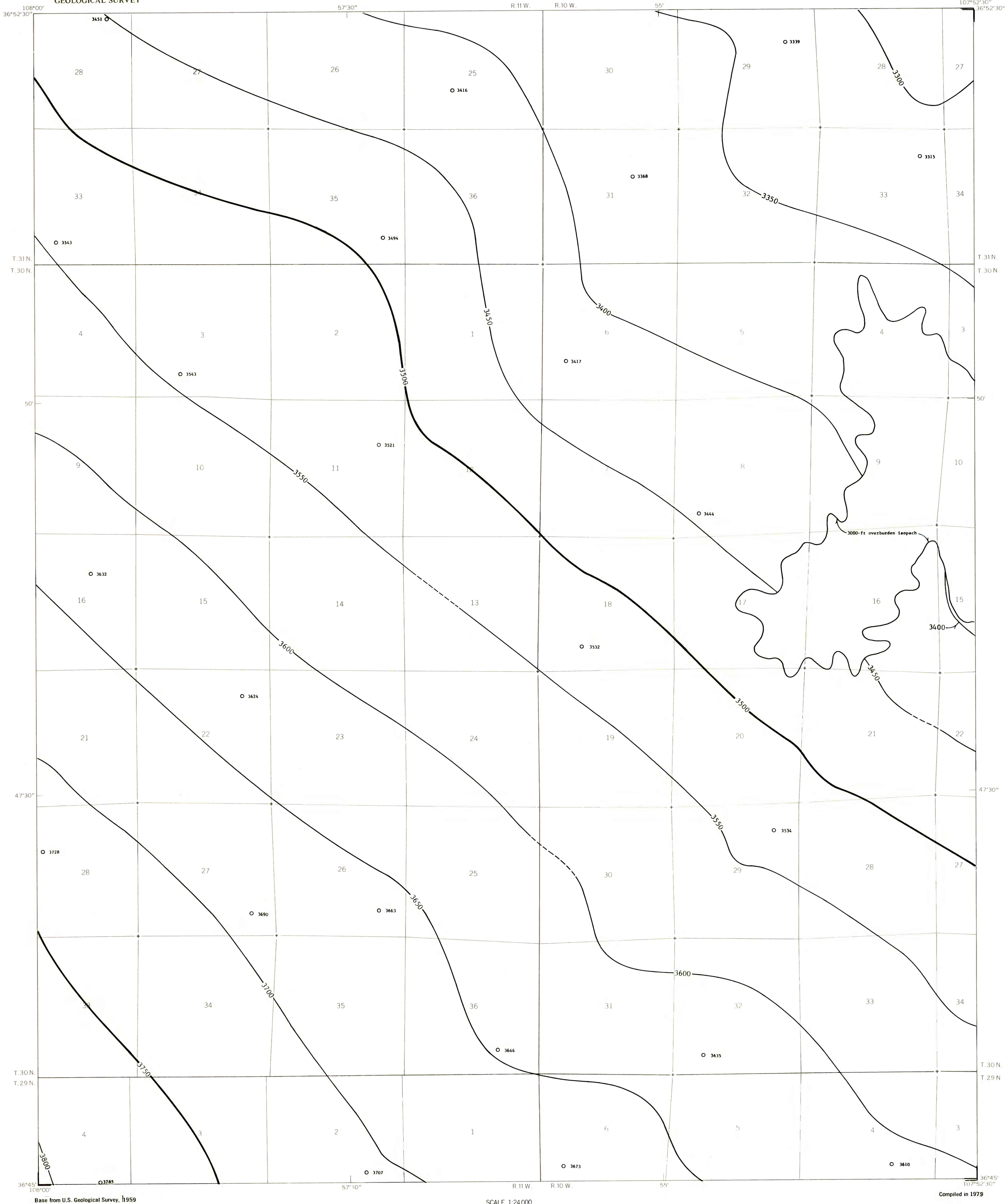

COAL RESOURCE OCCURRENCE MAP OF THE SOUTHWEST QUARTER OF THE  
AZTEC 15-MINUTE QUADRANGLE, SAN JUAN COUNTY, NEW MEXICO  
BY  
DAMES & MOORE  
1979

This map was prepared under contract to the U.S. Geological Survey and has not been edited for conformity with Geological Survey editorial standards. Opinions and conclusions expressed herein do not necessarily represent those of the Geological Survey.