

This report has not been edited for conformity with Geological Survey editorial standards or stratigraphic nomenclature.

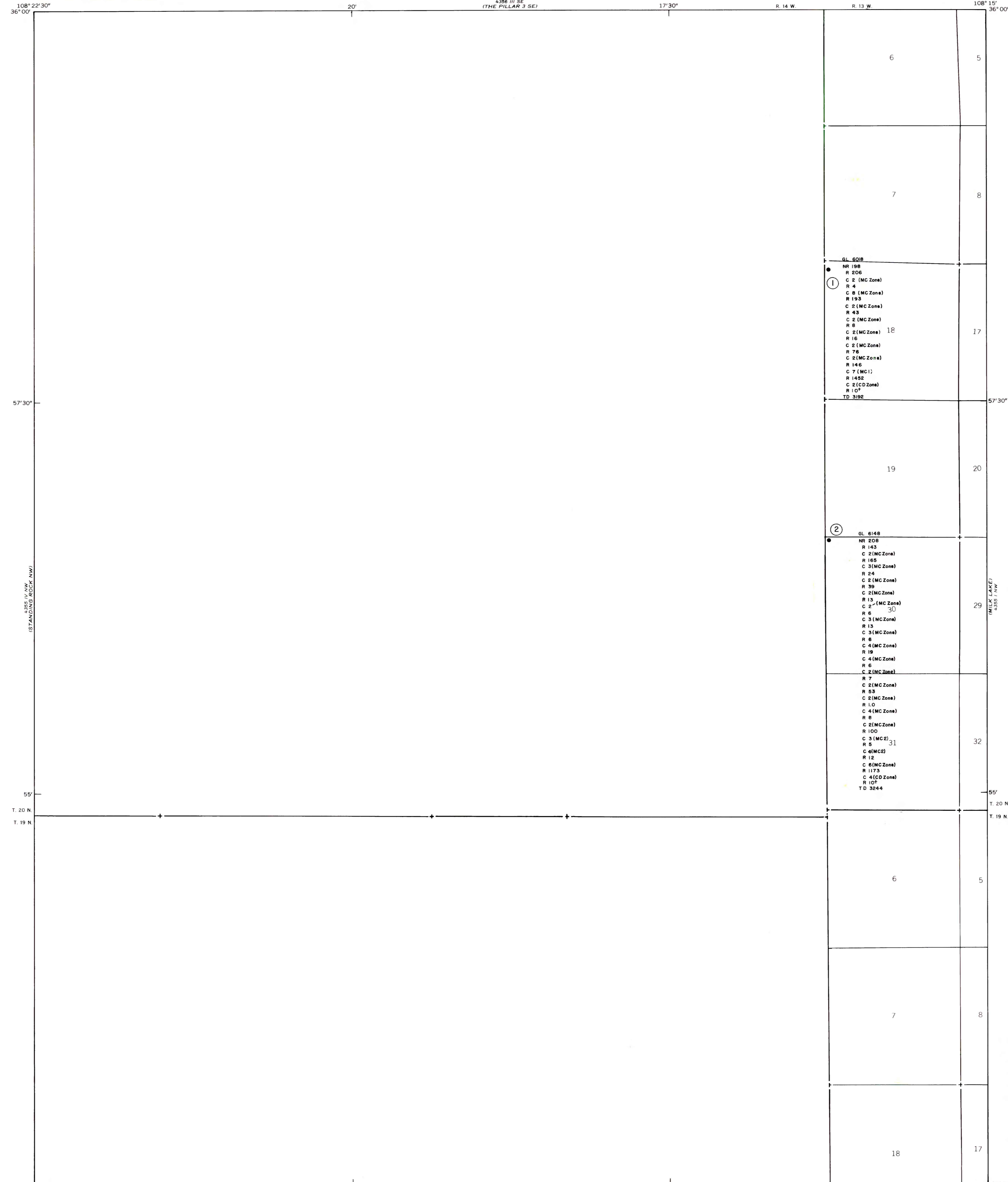

EXPLANATION

- (1) GL 6018
- NR 198
- R 206
- C 2 (MC Zone)
- R 4
- C 8 (MC Zone)
- R 193
- C 2 (MC Zone)
- R 43
- C 2 (MC Zone)
- R 8
- C 2 (MC Zone)
- R 16
- C 2 (MC Zone)
- R 76
- C 2 (MC Zone)
- R 146
- C 7 (MC1)
- R 1452
- C 2 (CD Zone)
- R 10+
- TD 3192

DRILL HOLE—Shown solid for oil and gas. Showing drill hole data, in feet. Index number refers to hole on plate 3 of CRO map or in table of text.

- GL—Ground level elevation
- NR—No record
- R—Rock interval
- C—Coal
- TD—Total depth

DRILL HOLE DATA SYMBOLS

- MC Zone—Menefee Cleary coal zone
- MC2—Menefee Cleary No. 2 coal bed
- MC1—Menefee Cleary No. 1 coal bed
- CD Zone—Crevasse Canyon Dilco coal zone

COAL BED / ZONE SYMBOLS AND NAMES

To convert feet to meters, multiply feet by 0.3048.

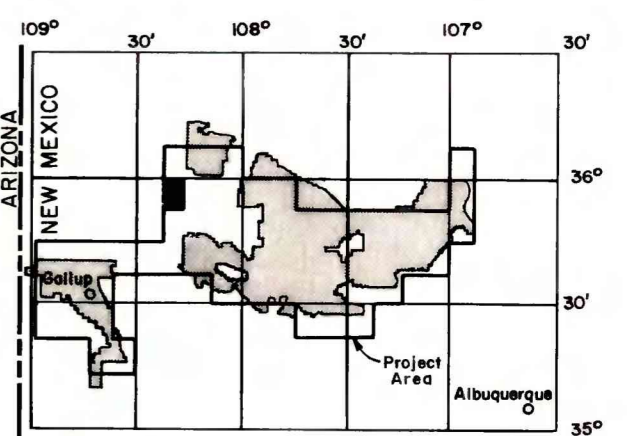

MAP SHOWING LOCATION OF QUADRANGLE (WITHIN THE PROJECT AREA) AND THE KNOWN RECOVERABLE COAL RESOURCE AREAS (STIPPLED), NEW MEXICO

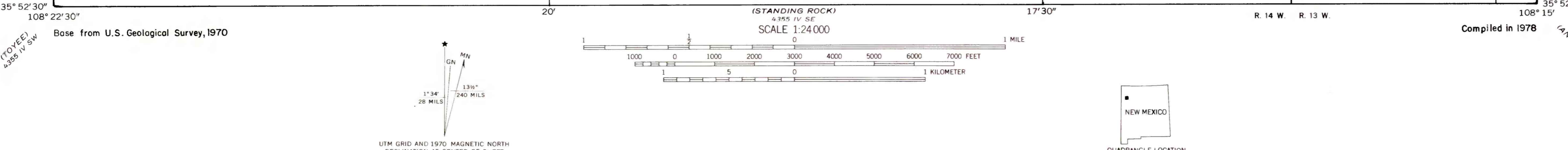

COAL RESOURCE OCCURRENCE MAP OF THE RED LAKE WELL
QUADRANGLE, MCKINLEY COUNTY, NEW MEXICO
BY
BERGE EXPLORATION, INC.
1979