

UNITED STATES  
DEPARTMENT OF THE INTERIOR  
GEOLOGICAL SURVEY

NORTHWEST DOTY MOUNTAIN QUADRANGLE  
WYOMING-CARBON CO.  
7.5 MINUTE SERIES (TOPOGRAPHIC)

PLATE 6 OF 32

EXPLANATION

OVERBURDEN ISOPACHS - Showing thickness of overburden, in feet, from surface to top of coal bed. Dashed where vertical accuracy possibly not within 40 feet. Isopach interval 100 feet (31 m) over strip-pable coal and 200 feet (61 m) beyond the stripping-limit line.

○ 313

DRILL HOLE - Showing thickness of overburden, in feet, from surface to top of coal bed.

— 10 —

MINING-RATIO CONTOUR - Number indicates cubic yards of overburden per ton of recoverable coal by surface mining methods. Contours shown only in areas underlain by coal of Reserve Base thickness within the stripping-limit (in this quadrangle, the 200-foot-overburden isopach). To convert mining ratio to cubic meters of overburden per metric ton of recoverable coal, multiply mining ratio by 0.8428.

RR - Red Rim

COAL BED SYMBOL AND NAME - Coal bed identified by bracketed numbers. Coal bed identified by bracketed numbers is not formally named, but is numbered for identification purposes in this quadrangle only.

--- RR ---

TRACE OF COAL BED OUTCROP - Showing symbol of name of coal bed as listed above. Dashed where inferred; short dashed where inferred by present authors.

To convert feet to meters, multiply feet by 0.3048.

NOTE: Overburden isopachs and mining ratio contours are not drawn beyond dotted line because of insufficient data.

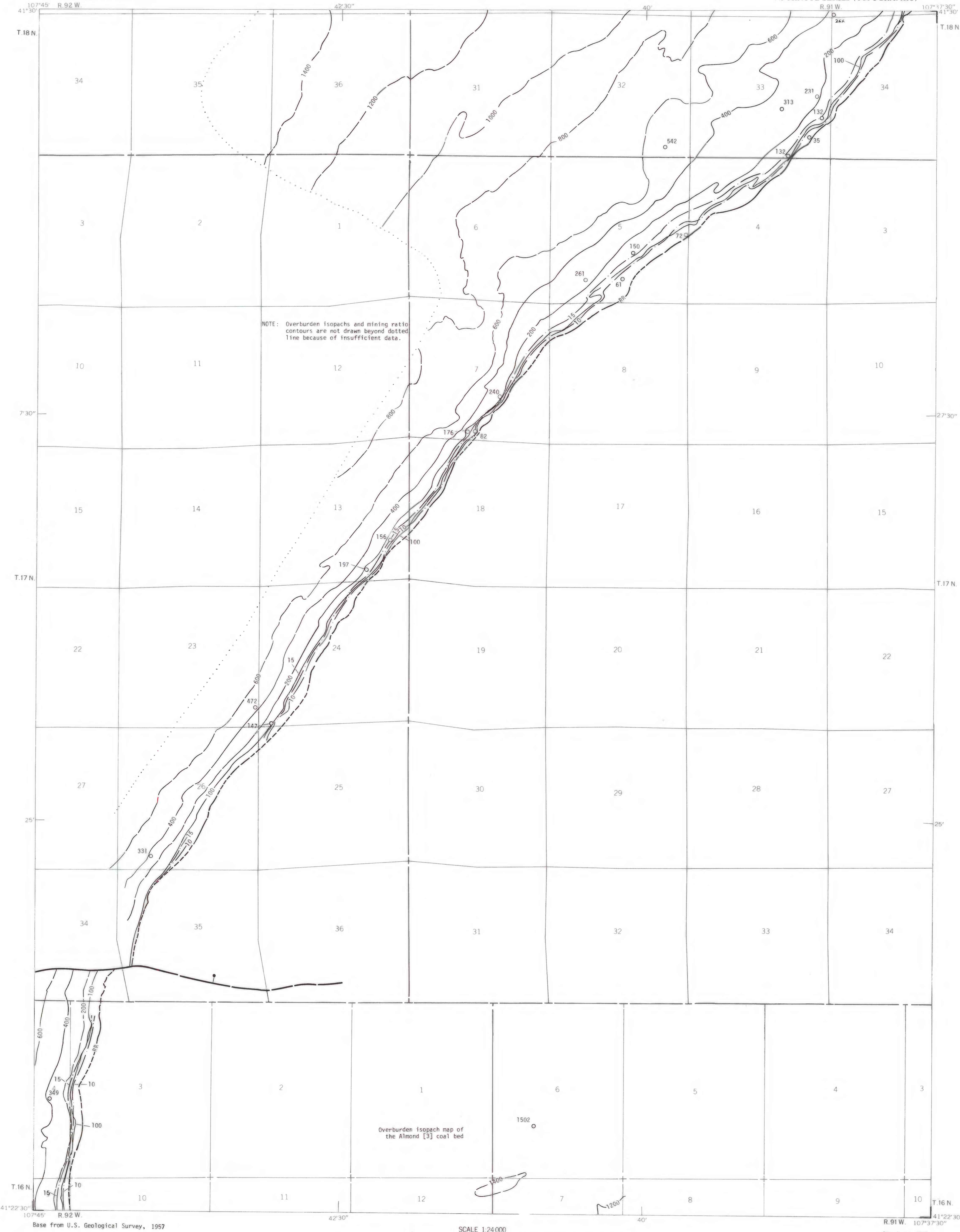

Overburden isopach map of the Almond [3] coal bed

This report has not been edited for conformity with U.S. Geological Survey editorial standards or stratigraphic nomenclature.

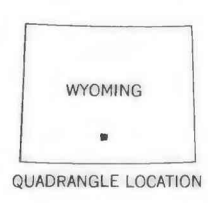
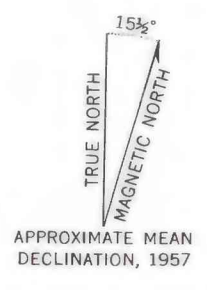

COAL RESOURCE OCCURRENCE MAP OF THE NORTHWEST QUARTER OF THE DOTY MOUNTAIN 15-MINUTE QUADRANGLE, CARBON COUNTY, WYOMING  
BY  
DAMES & MOORE  
1979