

- (80)
GL 7080
R 25
C 3(MG)
R 72
TD 100
- COAL TEST HOLE - Showing drill-hole data, in feet. Index number refers to hole on plate 3 of CRD map or in table of text.
- ✦ (10)
C 12(WC)
R 3
C 6(WC)
- MINE MEASURED SECTIONS - Abandoned mine, showing rock interval and coal thickness, in feet. Index number refers to section on plate 3 of CRD map or in table of text. Letters designate name of coal bed as listed below.
- ▲ (16)
C 4.2(WC)
- OUTCROP MEASURED SECTION - Showing rock interval and coal thickness, in feet. Index number refers to section on plate 3 of CRD map or in table of text. Letters designate name of coal bed as listed below.
- GL - Ground level elevation
NR - No record
R - Rock interval
C - Coal interval
TD - Total depth
- COAL TEST HOLE AND MEASURED-SECTION DATA SYMBOLS

- FC - Fish Creek
Lx - Lennox
Wd - Wadge
WC - Wolf Creek
LG - Lower Coal Group
LG2 - Lower Coal Group, zone 2
LG1 - Lower Coal Group, zone 1
- COAL BED SYMBOLS AND NAMES
- TRACE OF COAL BED OUTCROP - Letters designate name of coal bed as listed above. Arrow points toward coal-bearing area. Trace of outcrop modified (from original data source) to fit modern topographic map.
- COAL STRIP MINE - Showing name of mine and bed removed. Hatchures point toward mined out area. Dashed where approximately located.
- To convert feet to meters, multiply feet by 0.3048.

REFERENCES

- Bass, N. W., 1955, Unpublished field notes: U.S. Geol. Survey.
- Bass, N. W., Eby, J. B., and Campbell, M. R., 1955, Geology and mineral fuels of parts of Routt and Moffat Counties, Colorado: U.S. Geol. Survey Bull. 1027-D, p. 143-250.
- Brownfield, M. E., 1978a, Reconnaissance drilling during 1976 in the Rattlesnake Butte quadrangle, Routt County, Colorado: U.S. Geol. Survey Open-File Report 78-364, 11 p.
- 1978b, Reconnaissance drilling during 1977 in the Yampa coal field, Moffat and Routt Counties, Colorado: U.S. Geol. Survey Open-File Report 78-365, 135 p.
- 1979, Personal communication.
- Ryer, T. A., 1977, Geology and coal resources of the Foidel Creek EMRIA site and surrounding area, Routt County, Colorado: U.S. Geol. Survey Open-File Report 78-1048, 28 p.
- Schneider, G. B., 1978, Coal resources of the Fish Creek EMRIA site, Routt County, Colorado: U.S. Geol. Survey Open-File Report 78-848, 28 p.
- Stevenson, A. E., 1978, Lithologic and geophysical logs for eight holes drilled during 1978 in the Rattlesnake Butte quadrangle, Routt County, Colorado: U.S. Geol. Survey Open-File Report 78-1048, 28 p.
- U.S. Geol. Survey, 1952, Inactive coal lease No. Denver 051669, Middle Creek Mine.
- 1963a, Inactive coal lease No. Colorado 089576, United Electric Coal Co.
- 1963b, Inactive coal permit No. Colorado 093707, Energy Coal Co.

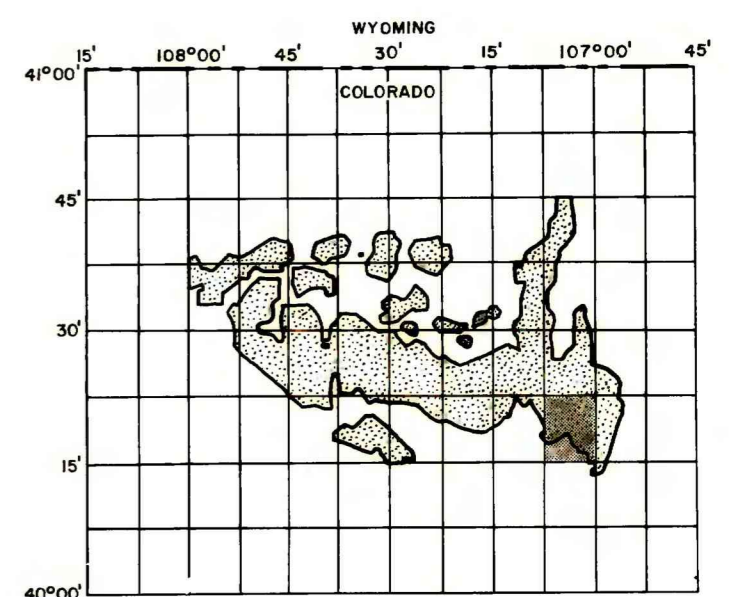

MAP SHOWING LOCATION OF THE RATTLESNAKE BUTTE QUADRANGLE (SHADED) AND THE YAMPA KNOWN RECOVERABLE COAL RESOURCE AREA (STIPPLED), COLORADO

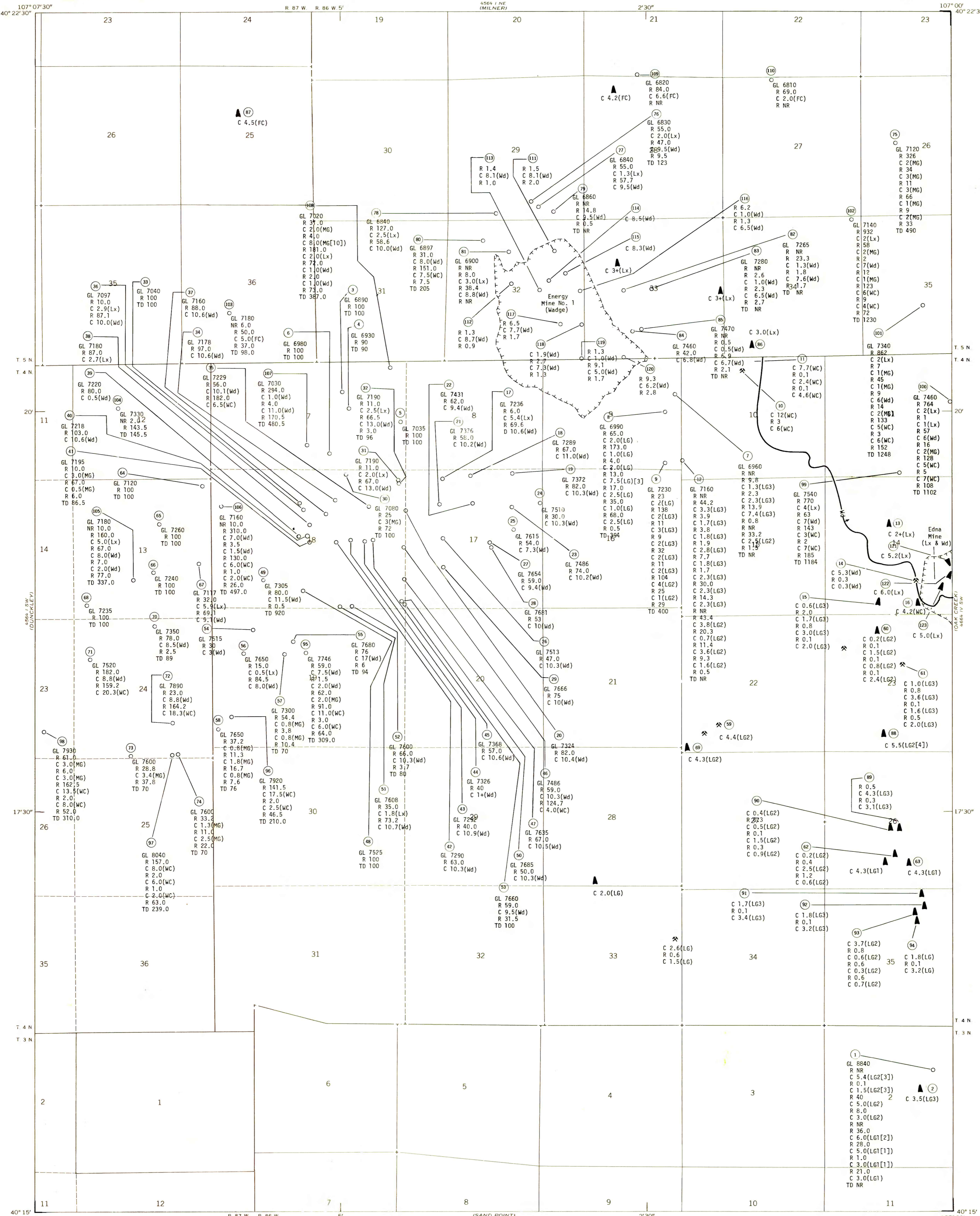

Base from U.S. Geological Survey, 1971

This report has not been edited for conformity with U.S. Geological Survey editorial standards or stratigraphic nomenclature.

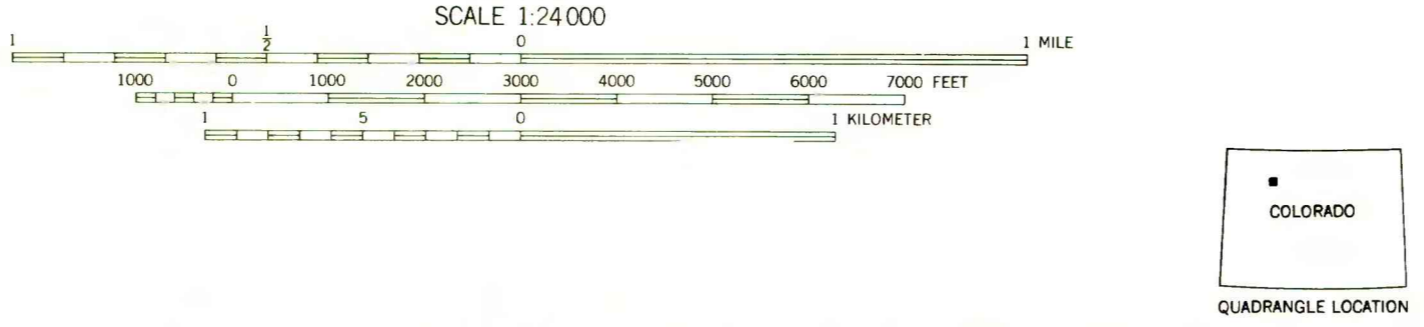
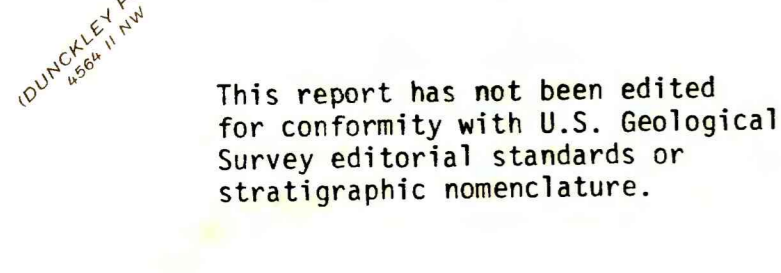

COAL RESOURCE OCCURRENCE MAP OF THE RATTLESNAKE BUTTE QUADRANGLE, ROUTT COUNTY, COLORADO
BY DAMES & MOORE
1979