

EXPLANATION

- ISOPACHS - Showing thickness of coal, in feet. Long dashed where inferred. Isopach interval 1 foot.
 - POINT OF MEASUREMENT - Showing thickness of coal, in feet. Includes all points of measurement other than drill holes.
 - INTERBEDDED COAL AND ROCK - Showing total coal thickness/total rock thickness.
 - LG3 - Lower Coal Group, zone 3
 - COAL ZONE SYMBOL AND NAME
 - TRACE OF COAL ZONE OUTCROP - Showing symbol of name of coal zone as listed above. Arrow points toward coal-bearing area. Short dashed where inferred by present authors.
 - TRACE OF FAULT - Bar and ball on downthrown side when direction of movement is known. Dashed where inferred or approximately located.
- To convert feet to meters, multiply feet by 0.3048.

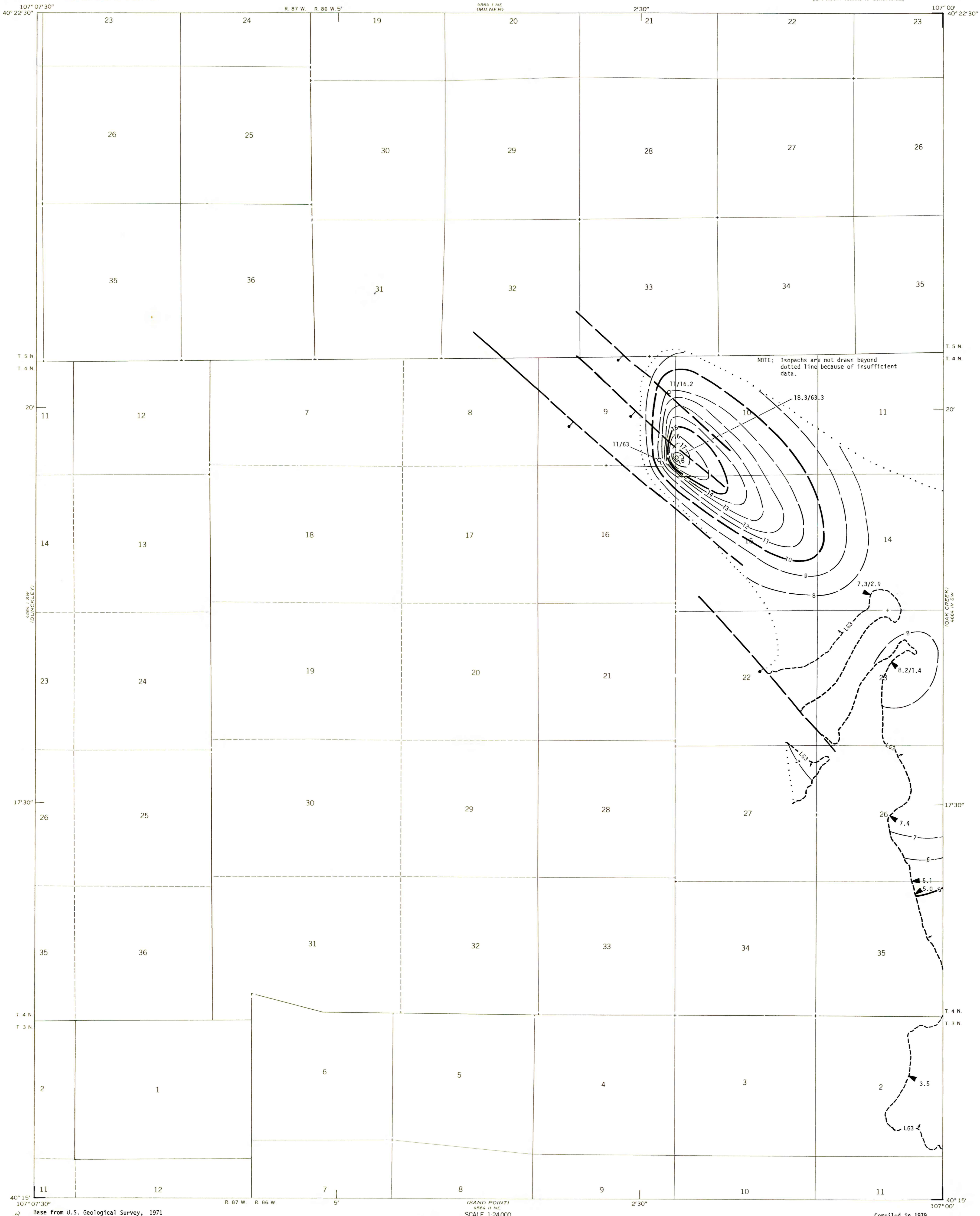

NOTE: Isopachs are not drawn beyond dotted line because of insufficient data.

Base from U.S. Geological Survey, 1971

Compiled in 1979

This report has not been edited for conformity with U.S. Geological Survey editorial standards or stratigraphic nomenclature.

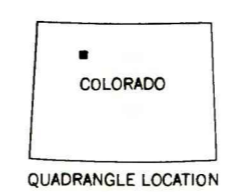
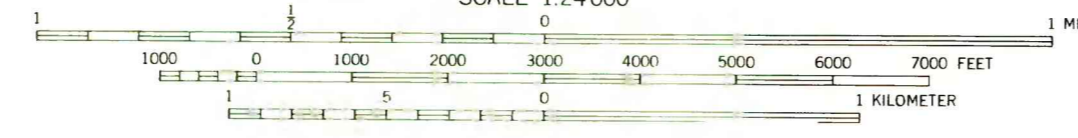
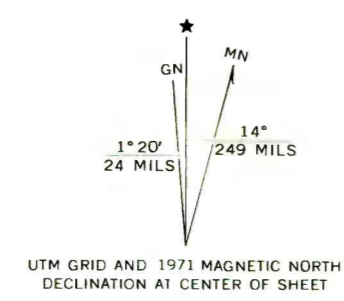

COAL RESOURCE OCCURRENCE MAP OF THE RATTLESNAKE BUTTE QUADRANGLE, ROUTT COUNTY, COLORADO
BY
DAMES & MOORE
1979