

EXPLANATION

10
11
ISOPACHS - Showing thickness of coal, in feet. Long dashed where inferred. Isopach interval 1 foot.

○10.2
DRILL HOLE - Showing thickness of coal, in feet.

▲5.6
POINT OF MEASUREMENT - Showing thickness of coal, in feet. Includes all points of measurement other than drill holes.

○9.0/2.0
INTERBEDDED COAL AND ROCK - Showing total coal thickness/total rock thickness.

Wd - Wadge
COAL BED SYMBOL AND NAME

TRACE OF COAL BED OUTCROP - Showing symbol of name of coal bed as listed above. Arrow points toward coal-bearing area. Short dashed where inferred by present authors.

TRACE OF FAULT - Bar and ball on down-thrown side when direction of movement is known. Dashed where inferred or approximately located.

Energy Mine (Wadge)
COAL STRIP MINE - Hachures point toward mined area. Dashed where approximately located.

To convert feet to meters, multiply feet by 0.3048.

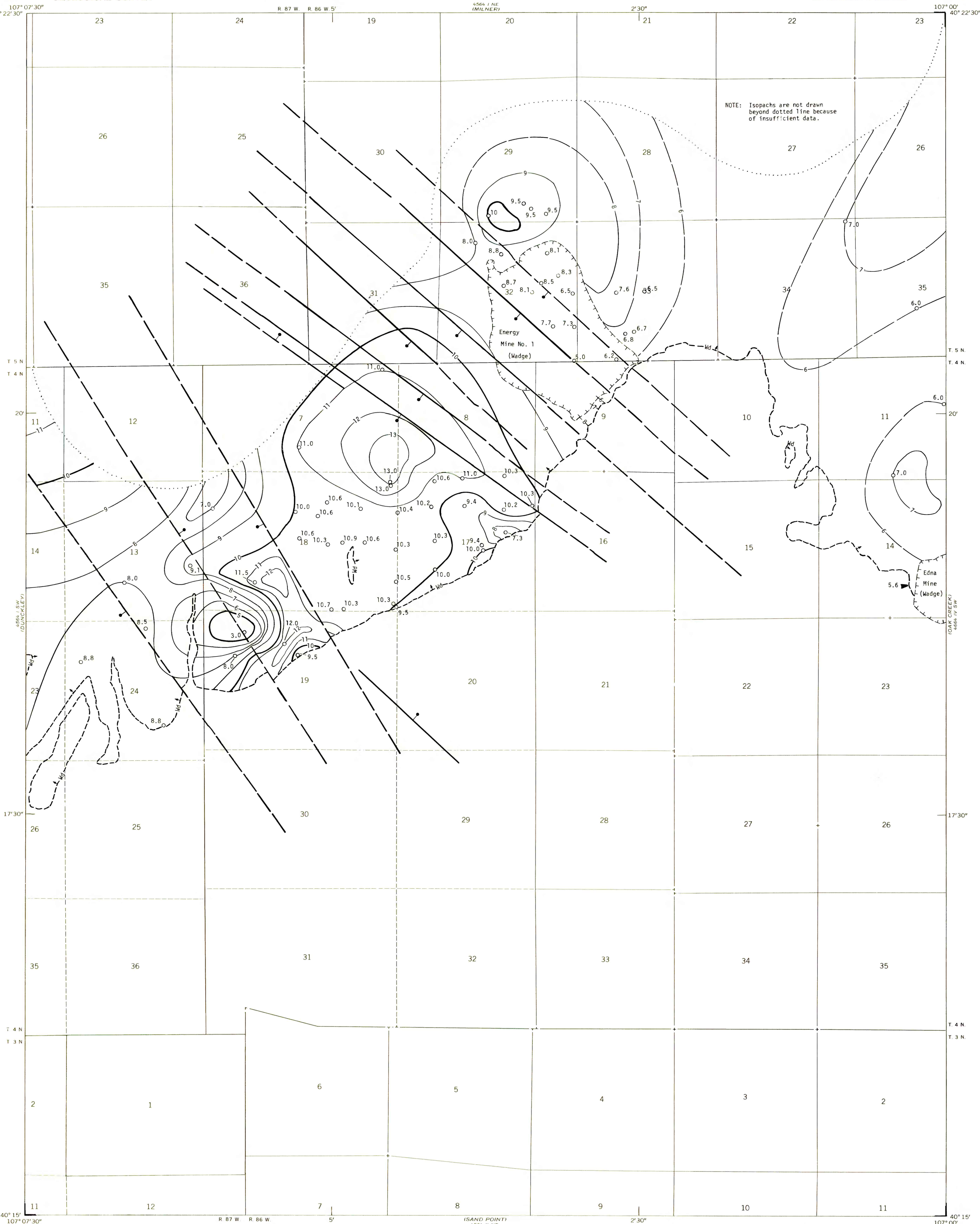

Base from U.S. Geological Survey, 1971

Compiled in 1979

This report has not been edited for conformity with U.S. Geological Survey editorial standards or stratigraphic nomenclature.

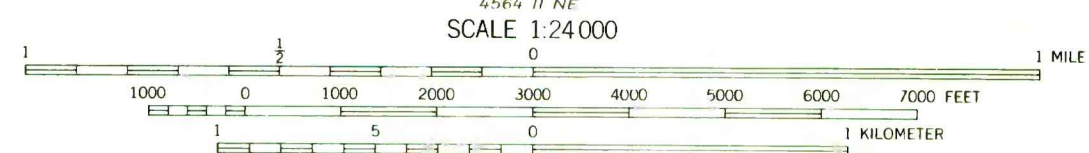
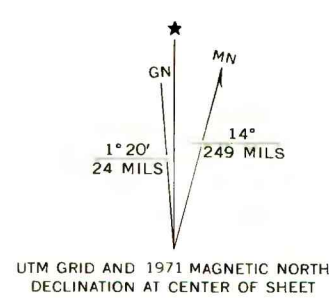

COAL RESOURCE OCCURRENCE MAP OF THE RATTLESNAKE BUTTE QUADRANGLE, ROUTT COUNTY, COLORADO

BY
DAMES & MOORE
1979