

EXPLANATION

==== 10
==== 11

ISOPACHS - Showing thickness of coal, in feet. Long dashed where inferred; short dashed where projected beyond coal-bearing area. Isopach interval 1 foot.

==== 7000
==== 7100

STRUCTURE CONTOURS - Drawn on top of coal bed. Solid where vertical accuracy within 40 feet; long dashed where vertical accuracy possibly not within 40 feet; short dashed where projected above ground surface. Contour interval 100 feet (31 m). Datum is mean sea level.

○ 6971
12.1

DRILL HOLE - Showing altitude of top of coal bed, and thickness of coal, in feet.

▲ 6820
2.0

POINT OF MEASUREMENT - Showing altitude of top of coal bed, and thickness of coal, in feet. Altitudes not shown for underground mine measured sections. Includes all points of measurement other than drill holes.

Fa - Fairfield coal group

COAL BED SYMBOL AND NAME - Coal bed identified by bracketed numbers is not formally named, but is numbered for identification purposes in this quadrangle only.

--- Fa[85] ---

TRACE OF COAL BED OUTCROP - Showing symbol of name of coal bed as listed above. Arrow points toward coal-bearing area. Short dashed where projected by present authors.

..... C
INFERRED LIMIT OF BURNED AND CLINKERED COAL - Arrow points toward area of baked and fused rock.

To convert feet to meters, multiply feet by 0.3048.

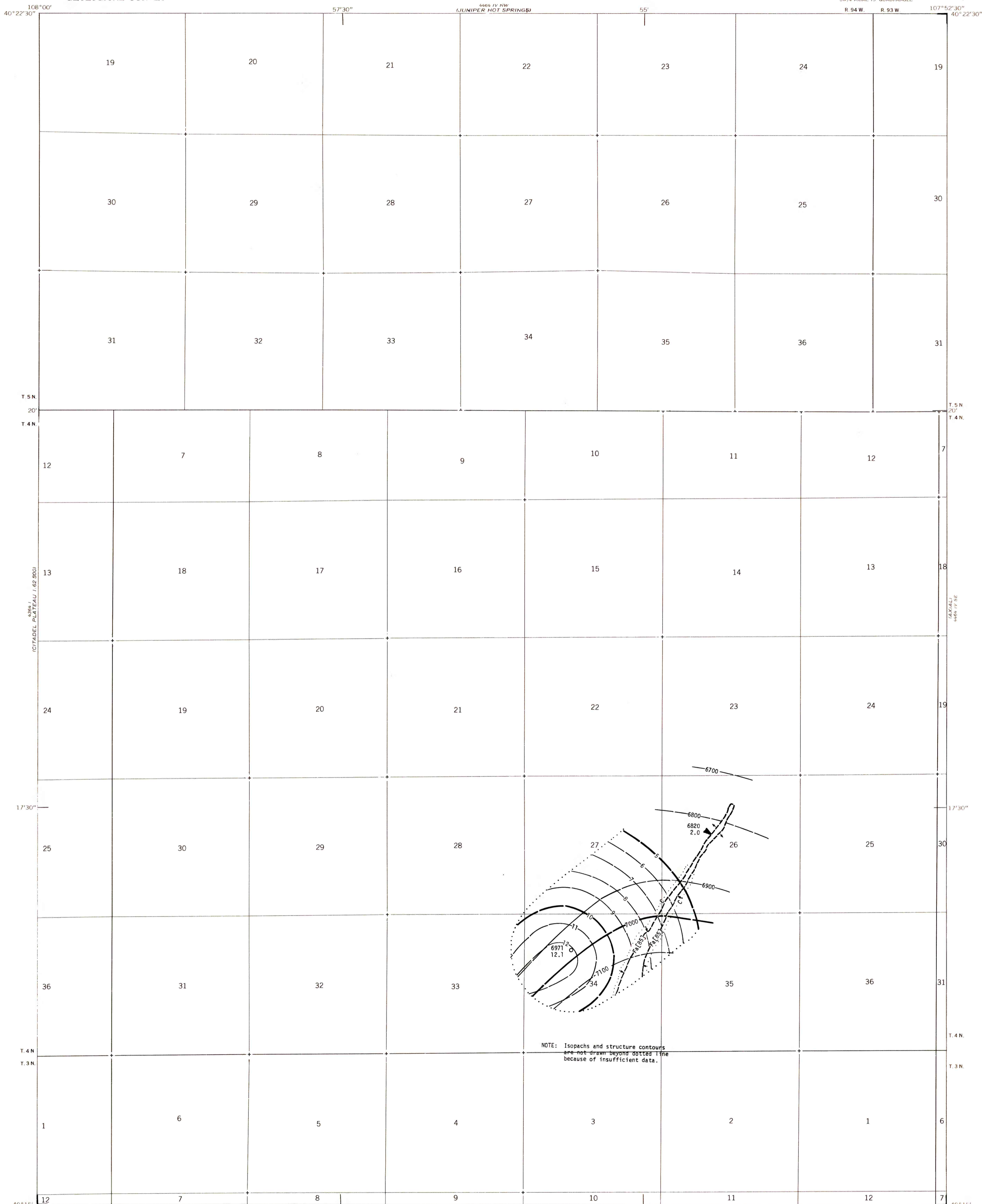

NOTE: Isopachs and structure contours are not drawn beyond dotted line because of insufficient data.

Base from U.S. Geological Survey, 1966

This report has not been edited for conformity with U.S. Geological Survey editorial standards or stratigraphic nomenclature.

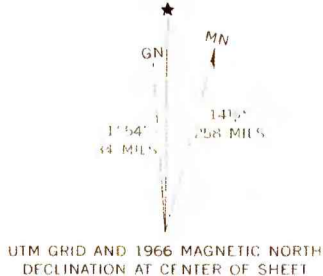

COAL RESOURCE OCCURRENCE MAP OF THE EASTON GULCH QUADRANGLE, MOFFAT COUNTY, COLORADO
BY
DAMES & MOORE
1979