

This report has not been edited for conformity with Geological Survey editorial standards or stratigraphic nomenclature.

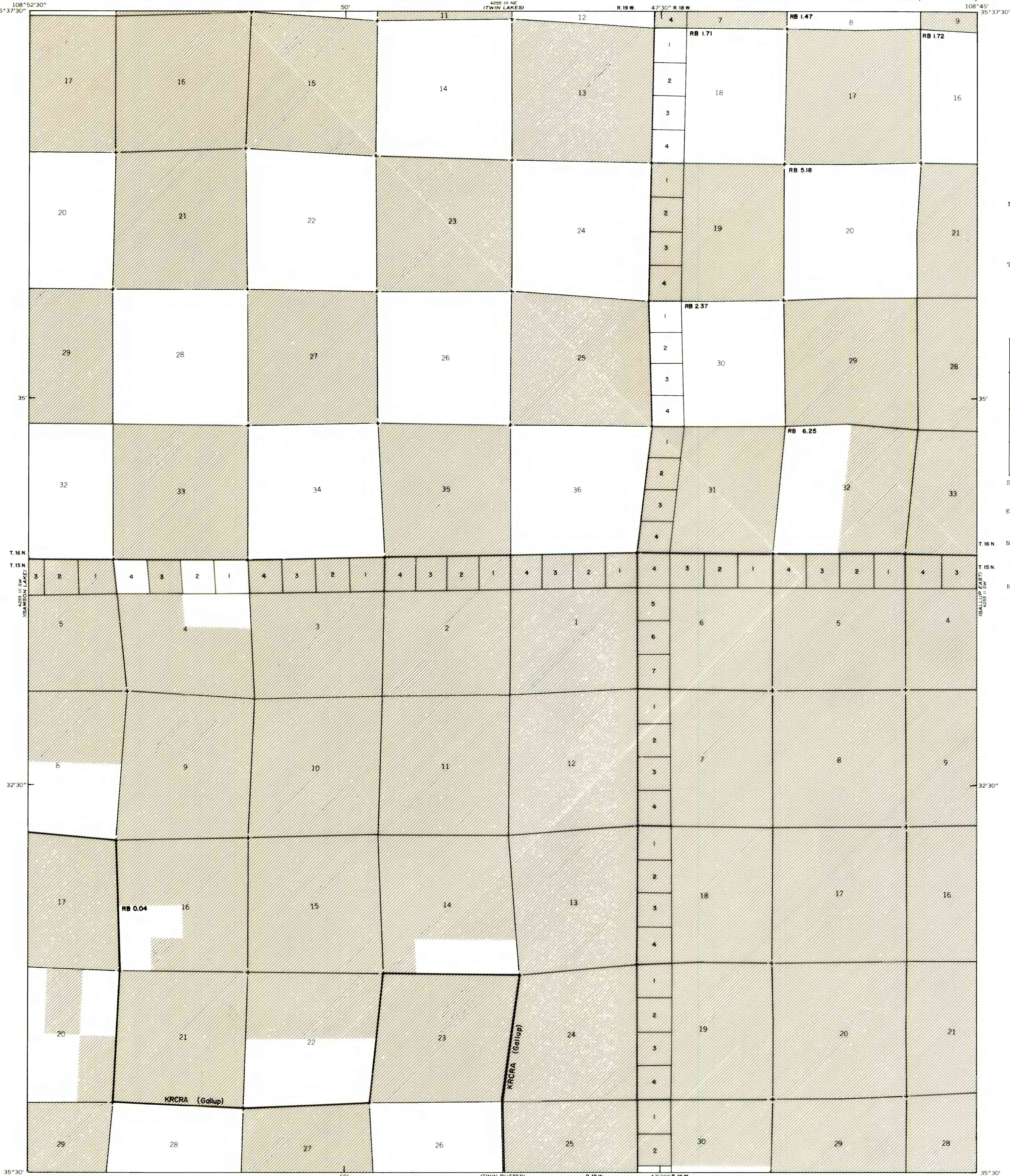

EXPLANATION

NON-FEDERAL COAL LAND—Land for which the Federal Government does not own the coal rights.

RB 5.18  
TOTAL RESERVE BASE (RB) OF COAL PER SECTION—In millions of short tons, calculated for each section of Federal land following the guidelines given in U. S. Geol. Survey Bulletin 1450-B. To convert short tons to metric tons, multiply short tons by 0.9072.

4	3	2	1
5	6		
6			
7			

SECTION OF LAND—Showing lots and lot numbers.

KRCRA (Gallup)—Known Recoverable Coal Resource Area—For Gallup area.

NOTE: Refer to coal resources section of text for departures from U. S. Geological Survey Bulletin 1450-B.

NOTE: BLM coal ownership data current as of Oct. 26, 1978.

Base from U. S. Geological Survey, 1963

Compiled in 1978

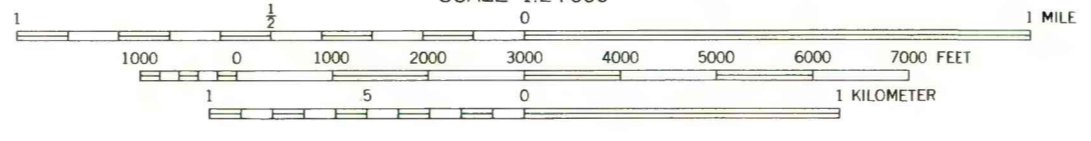
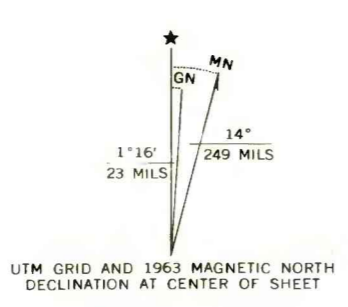

COAL RESOURCE OCCURRENCE MAP OF THE GALLUP WEST QUADRANGLE, MCKINLEY COUNTY, NEW MEXICO  
BY  
BERGE EXPLORATION, INC.  
1979