

This report has not been edited for conformity with Geological Survey editorial standards or stratigraphic nomenclature.

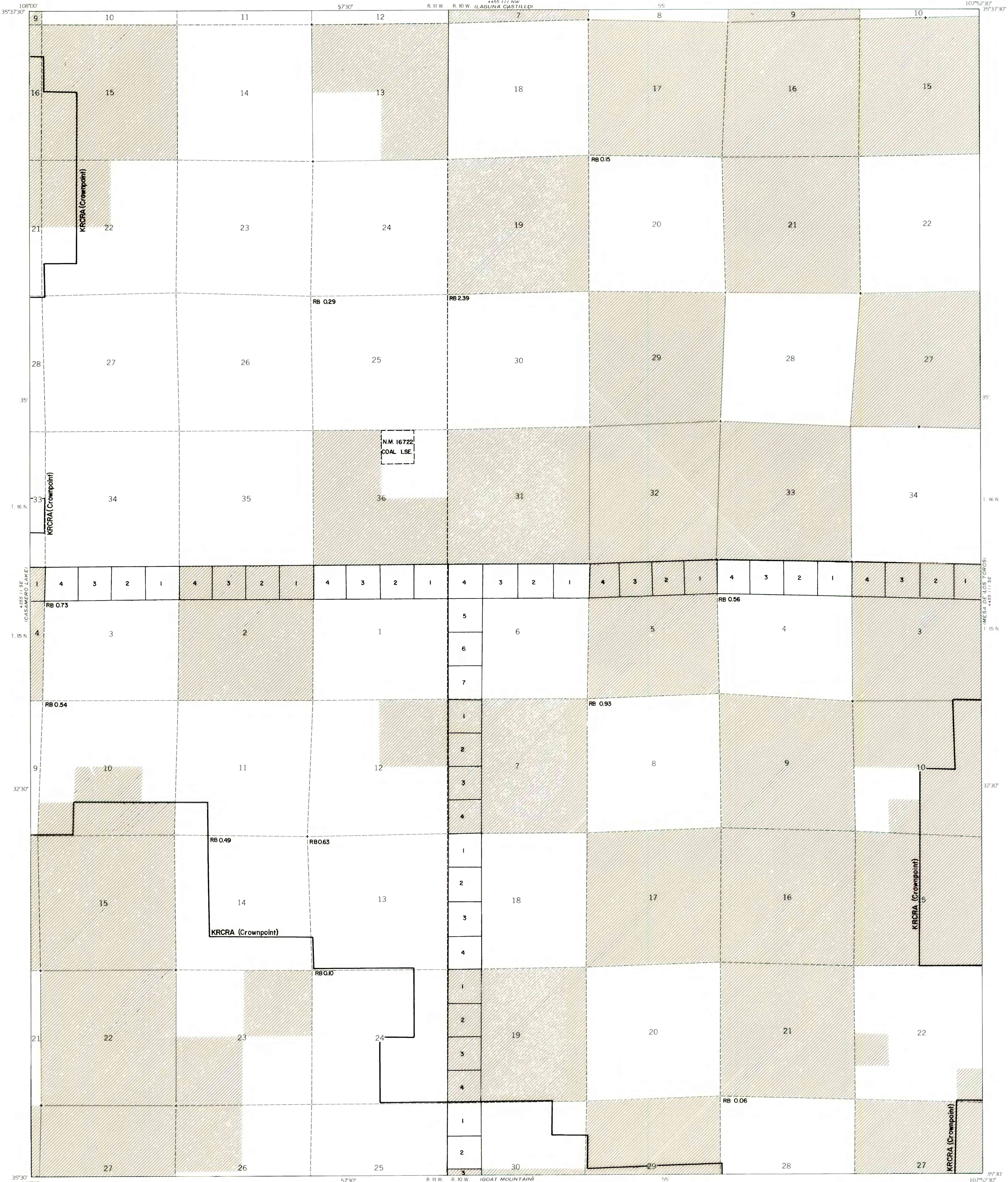

EXPLANATION

NON-FEDERAL COAL LAND—Land for which the Federal Government does not own the coal rights.

TOTAL RESERVE BASE (RB) OF COAL PER SECTION—In millions of short tons, calculated for each section of Federal land following the guidelines given in U. S. Geol. Survey Bulletin 1450-B. To convert short tons to metric tons, multiply short tons by 0.9072.

4	3	2	1
5	6		
6			
7			

SECTION OF LAND—Showing lots and lot numbers

KRCRA (Crownpoint)—Known Recoverable Coal Resource Area—for Crownpoint area.

NOTE: BLM coal ownership data current as of Oct. 26, 1978.

NOTE: Refer to coal resources section of text for departures from U. S. Geological Survey Bulletin 1450-B.

Base from U.S. Geological Survey, 1963

Compiled in 1980

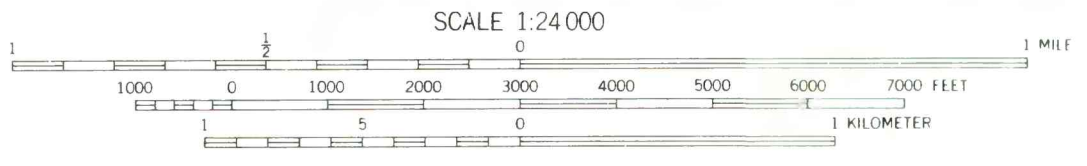
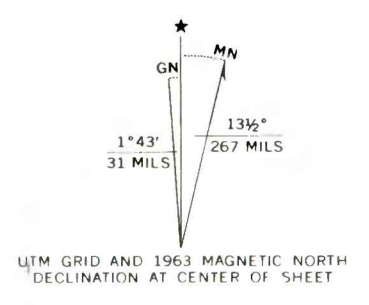

COAL RESOURCE OCCURRENCE MAP OF THE BORREGO PASS
QUADRANGLE, MCKINLEY COUNTY, NEW MEXICO
BY
BERGE EXPLORATION, INC.
1980