

Table 5.--Index of ground-water quality data for selected sites in Dade County, Florida.

Table with 10 columns: MAJ NUMBER, USGS NUMBER, WPA NUMBER, CATIONICITY, ANIONICITY, TYPE OF DATA, YEAR SAMPLED, SOURCE OF DATA, REMARKS. The table lists numerous monitoring sites across Dade County, Florida, including locations like Jackson Memorial Hospital, Miami Incineration Plant, and various agricultural and industrial sites. It includes detailed information on sampling methods, data types, and specific remarks for each site.

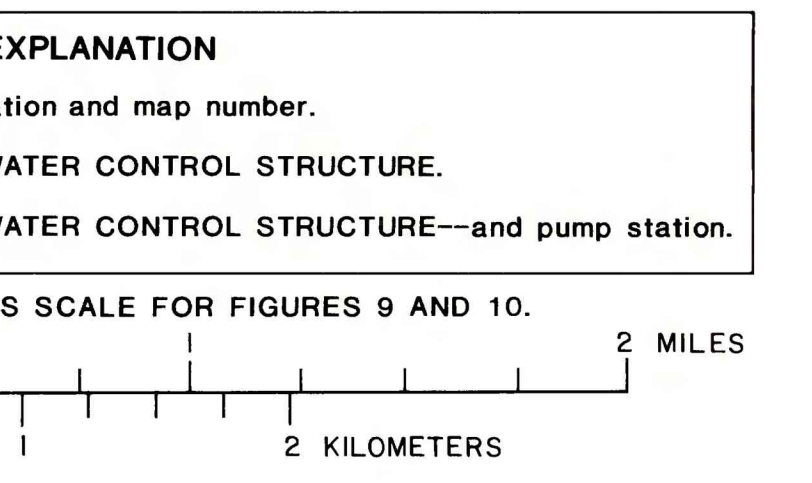
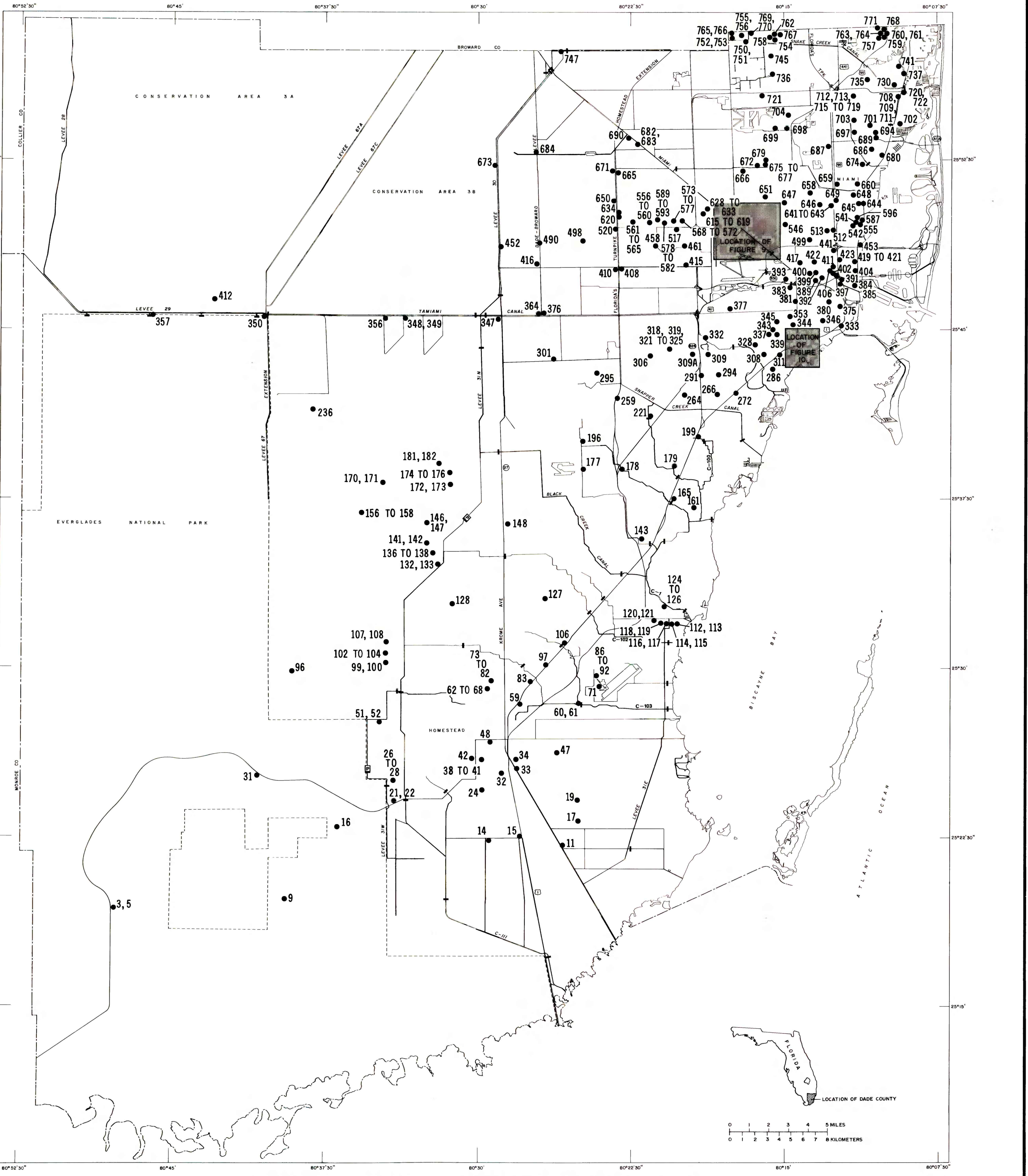

Figure 10.--Detailed view of selected area in figure 8.

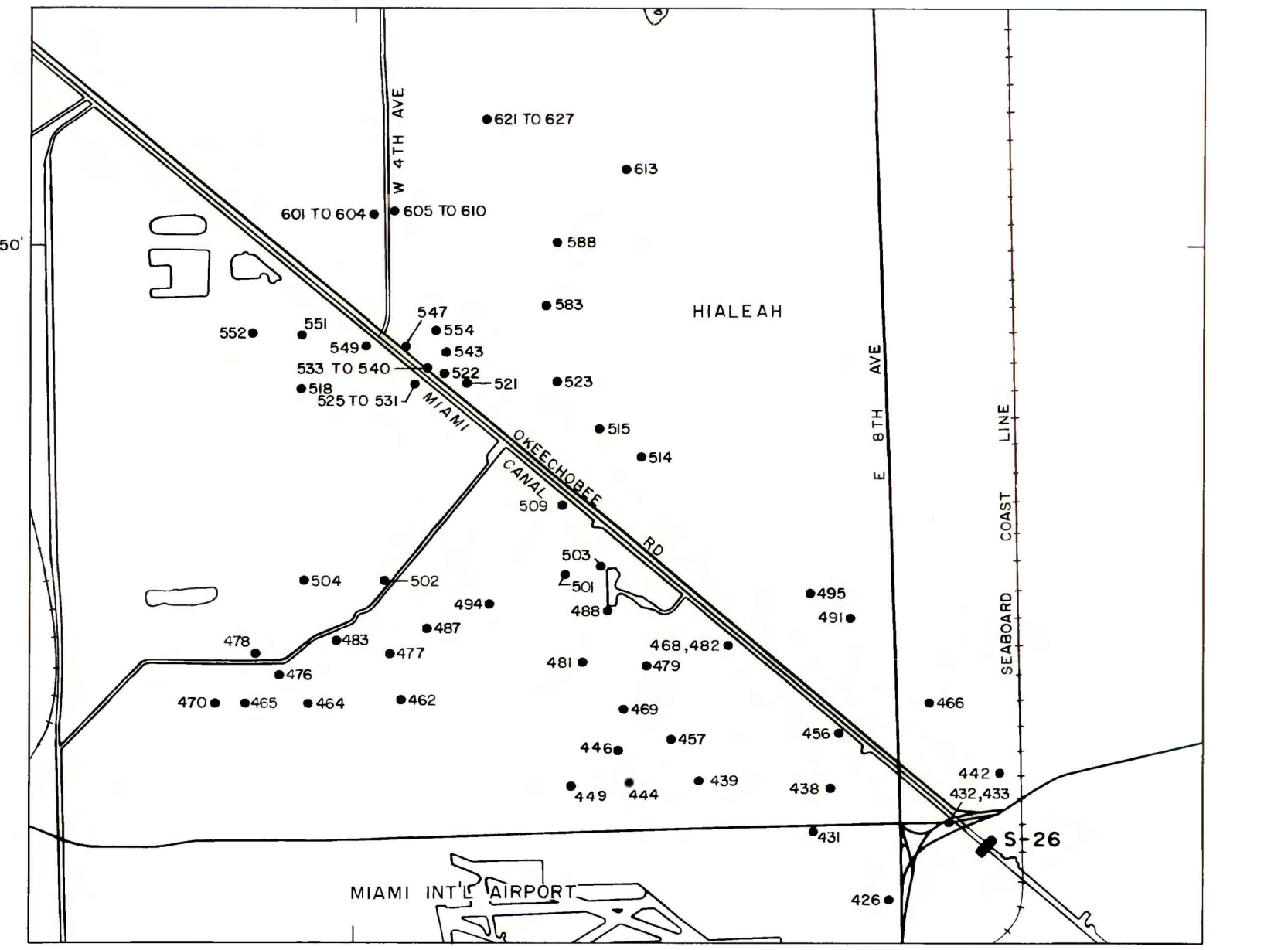

Figure 9.--Detailed view of selected area in figure 8.

INDEX OF HYDROLOGIC DATA FOR SELECTED SITES
IN DADE COUNTY, FLORIDA, 1923-80

By
R.S. Sonenshein, C.R. Causaras, and J.E. Fish
1984