

97°26'00"

97°22'30"

35°20'00"

35°20'00"

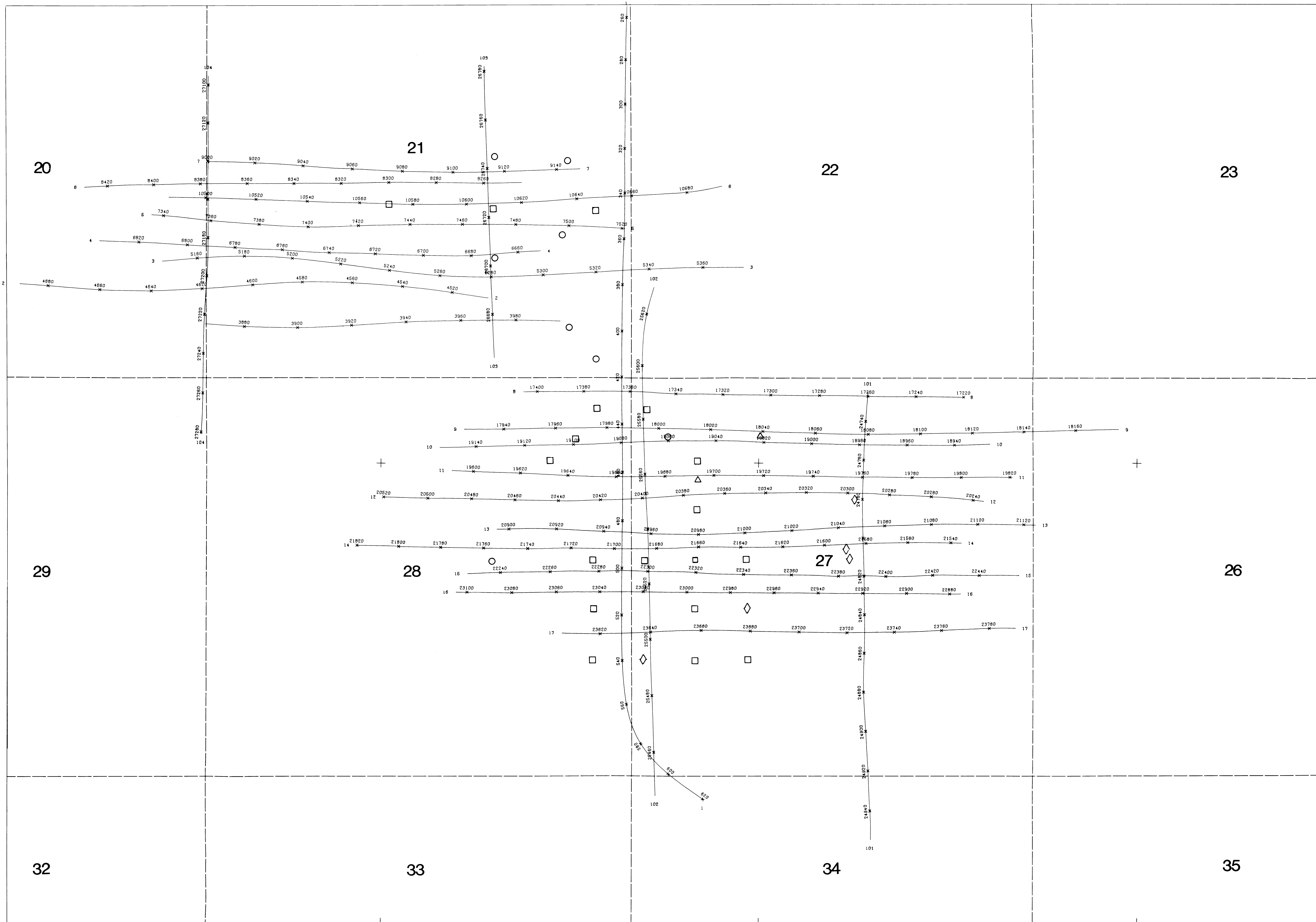

KEY

□	ABANDON WELL
◇	PROBABLE WELL
△	POSSIBLE WELL
○	ACTIVE WELL

elevation: 200 ft. above ground

PROJ.#1112  
MOORE, OK.  
1/6000.

flown by  
U.S. GEOLOGICAL SURVEY  
june 1983

processed and plotted by  
FUTURE RESOURCES

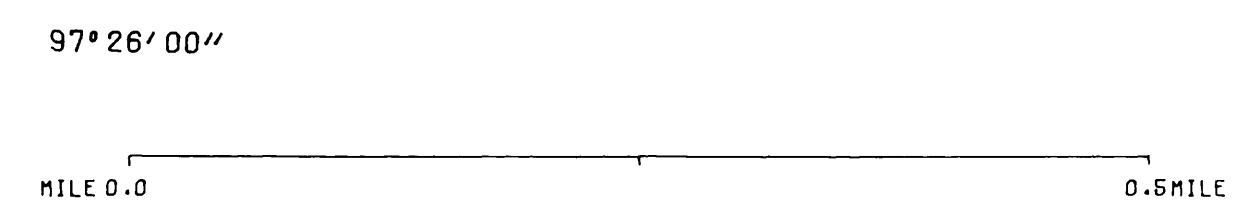

35°18'00"

35°18'00"

97°26'00"

97°22'30"