

97°39'00"

97°36'00"

35°22'00"

35°22'00"

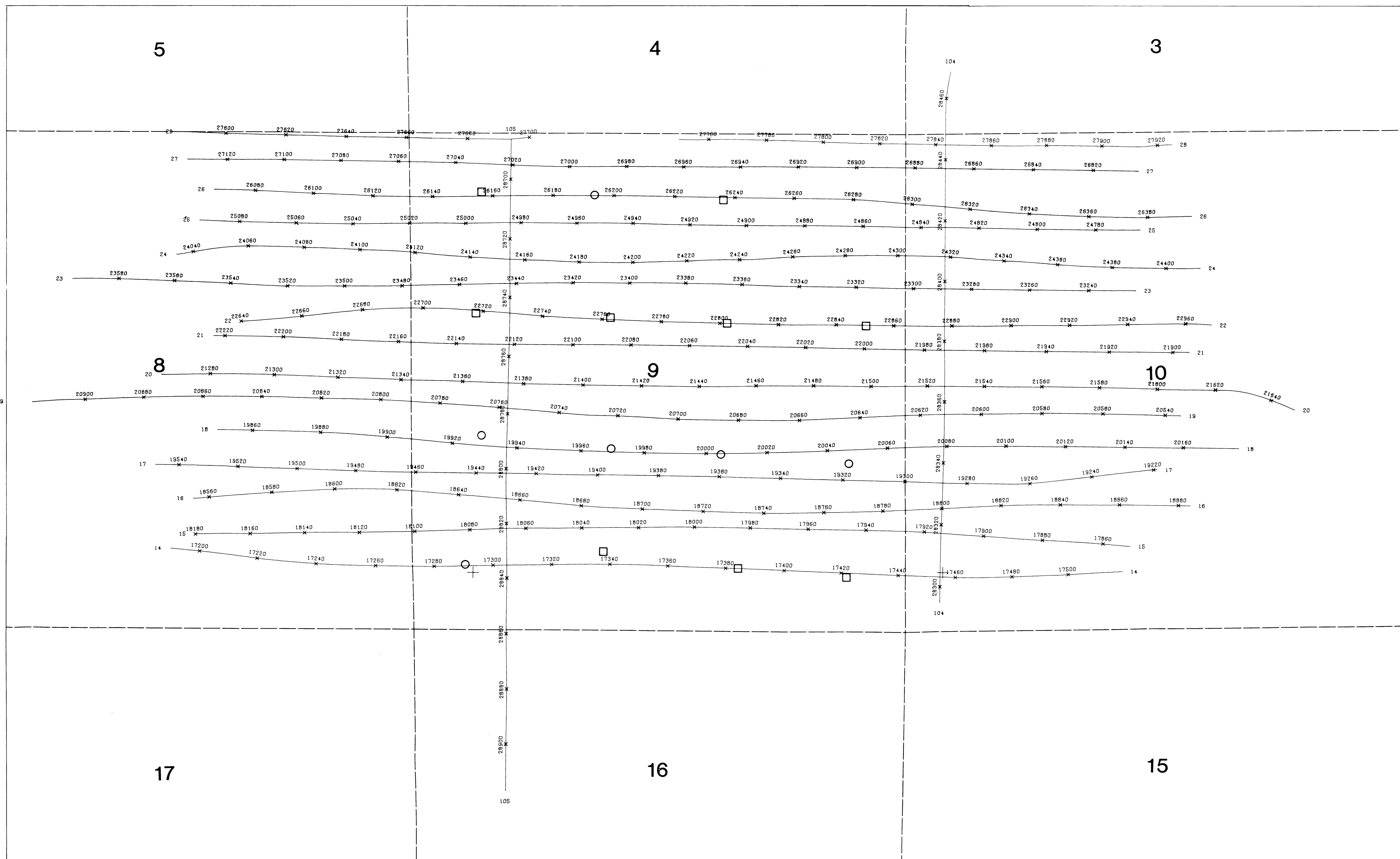

35°20'30"

35°20'30"

97°39'00" elevation: 200 ft. above ground

0.5 MILE

**KEY**

□	ABANDON WELL
◇	PROBABLE WELL
△	POSSIBLE WELL
○	ACTIVE WELL

PROJ.# 1114  
OKLAHOMA CITY, OK . sheet 1

1/6000.

flown by  
U.S. GEOLOGICAL SURVEY

june 1983

97°36'00"

processed and plotted by  
FUTURE RESOURCES