

TECHNICAL SUMMARY

Navigation: Differentially-corrected GPS
 Data reduction grid interval: 100 metres
 Terrain clearance: Helicopter 57 m, sensor 30 m
 Magnetometer 30 m
 Data sampling interval: 0.1 second
 Electromagnetic system: FUGRO RESOLVE
 Regional field removed: International Geomagnetic Reference Field 2005
 Date flown: March 16-17, 2007

Frequency Sensitivity Cell Orientation
 3300 Hz 0.12 ppm Vertical coplanar
 400 Hz 0.12 ppm Horizontal coplanar
 1500 Hz 0.12 ppm Horizontal coplanar
 2500 Hz 0.12 ppm Horizontal coplanar
 115000 Hz 0.60 ppm Horizontal coplanar
 115000 Hz 0.60 ppm Horizontal coplanar

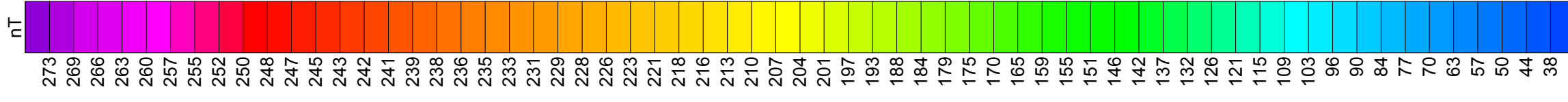
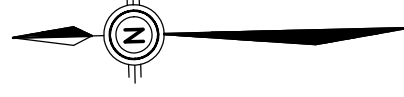

FLIGHT LINES

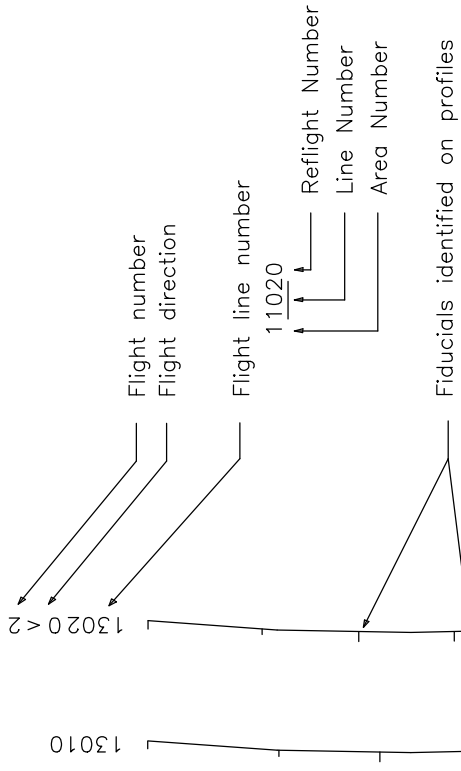

Fiducials identified on profiles

RESIDUAL MAGNETIC FIELD CONTOURS

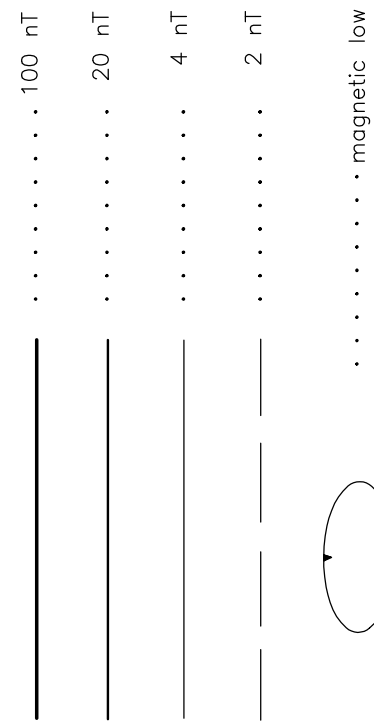

Magnetic inclination within the survey area: 63 degrees N
 Magnetic declination within the survey area: 4 degrees E

LOCATION MAP

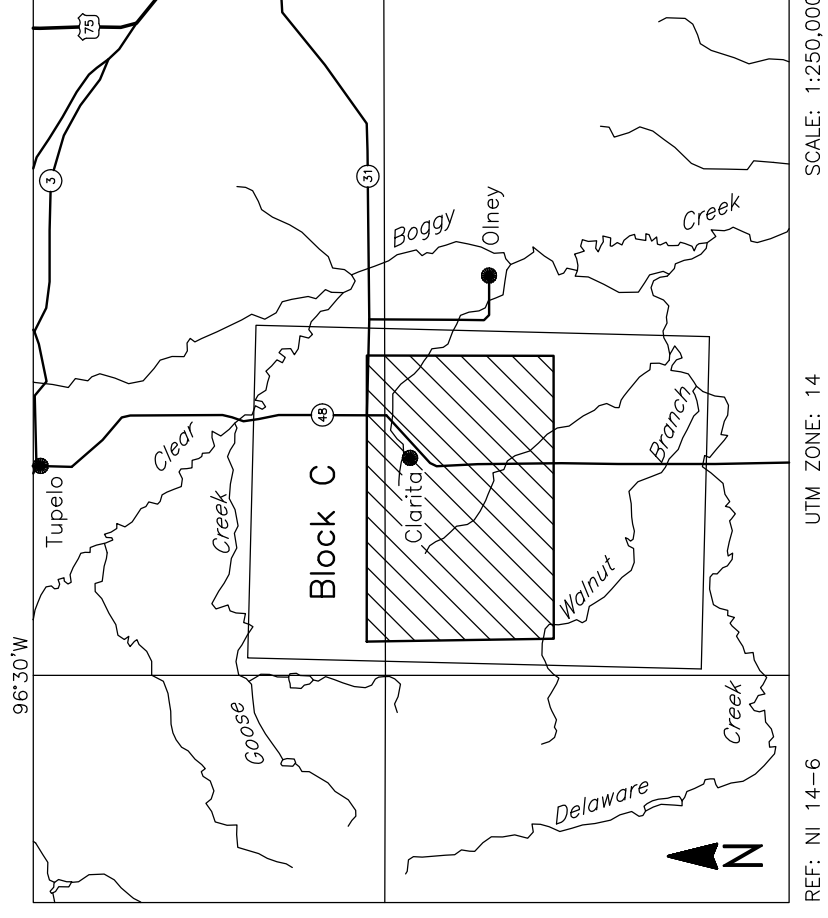

U.S. GEOLOGICAL SURVEY
 Arbuckle Simpson Aquifer Block C, Oklahoma

RESIDUAL MAGNETIC FIELD
 IGRF Removed

FUGRO RESOLVE SURVEY REF: NI 14-6 GEOPHYSICIST:
 DATE: MARCH, 2007 JOB: 06079 SHEET: 1
 Fugro Airborne Surveys

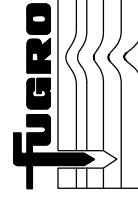
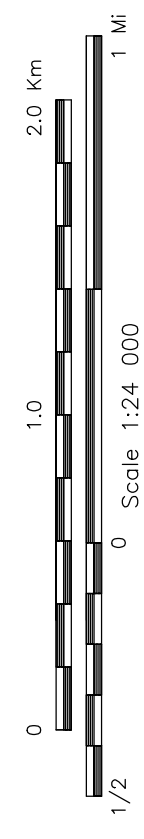

FUGRO AIRBORNE SURVEYS

