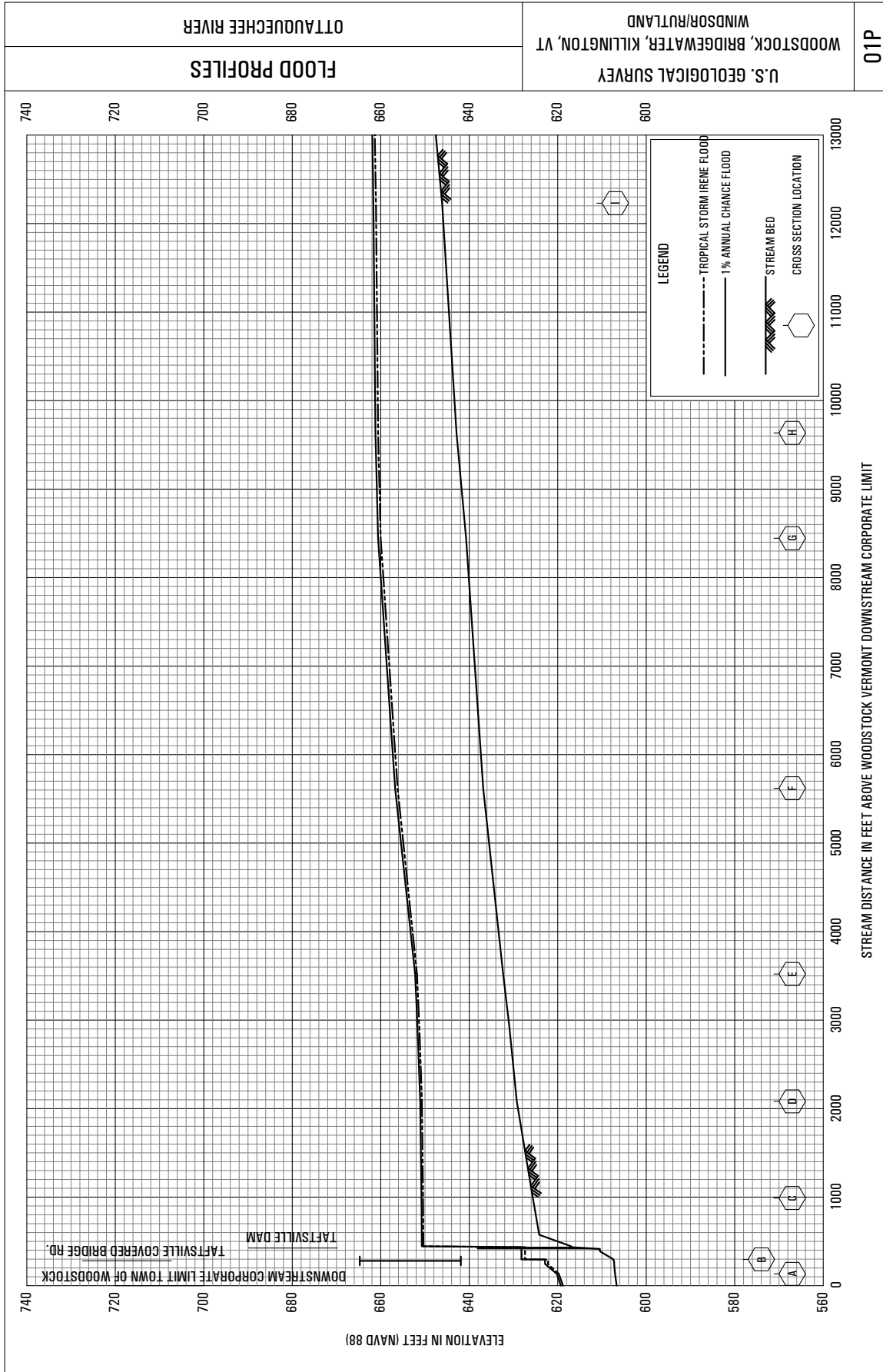


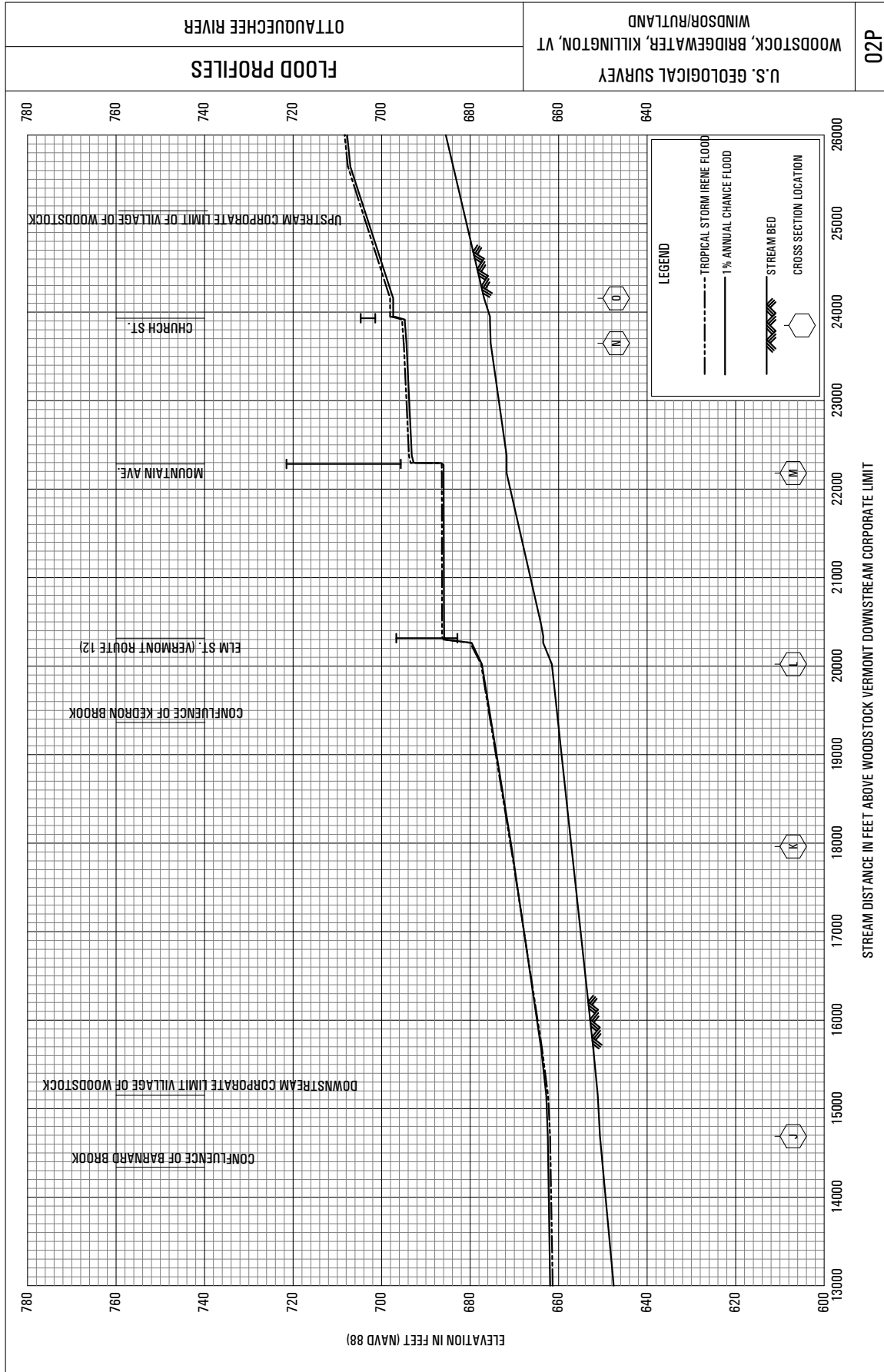
## Appendix 3. Profiles of the 1-Percent Annual Exceedance Probability Flood and the Flood of Tropical Storm Irene of August 2011 for the Ottauquechee River, Vermont

### Figures

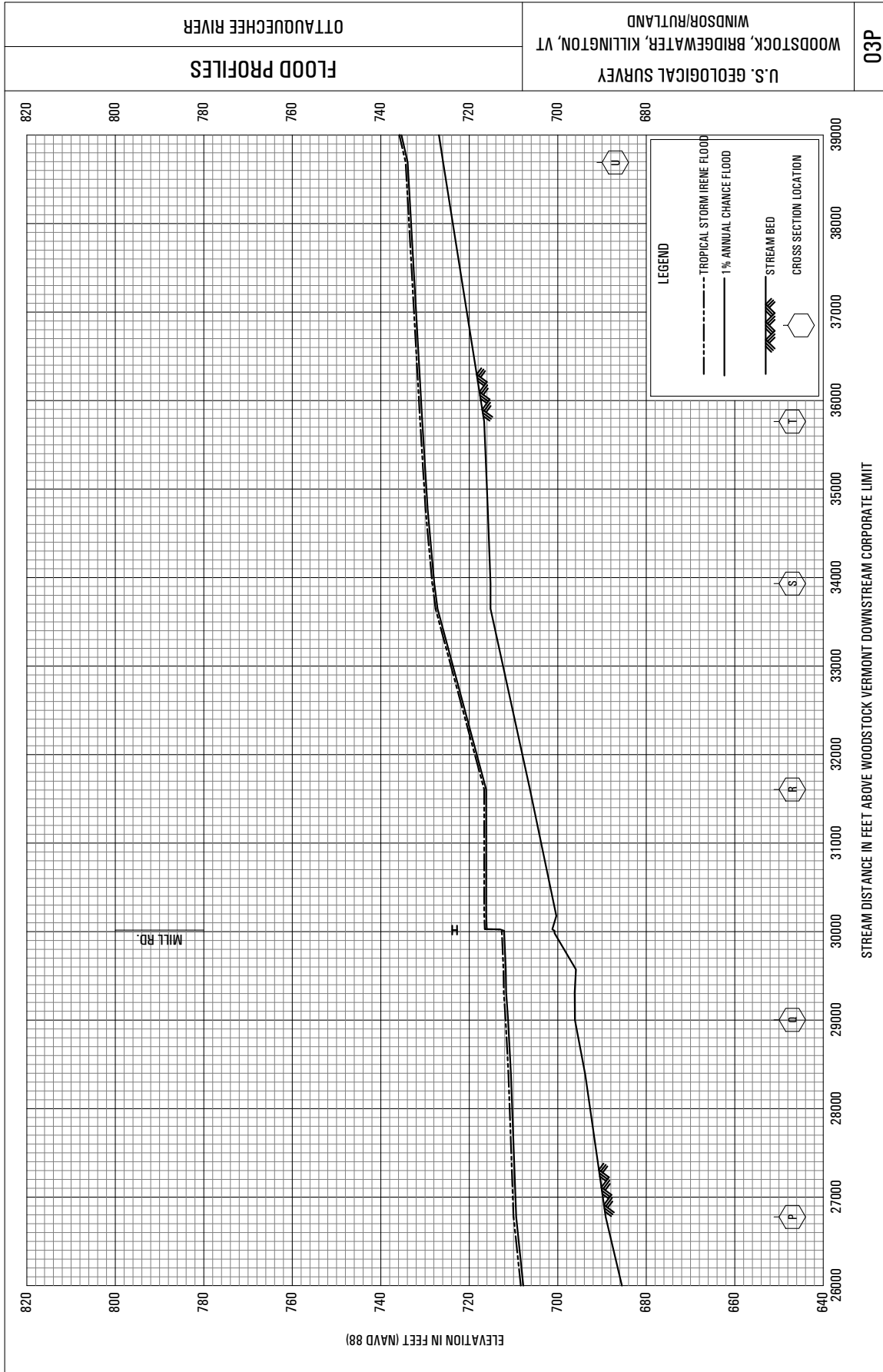
- 3-1. Profiles of the 1-percent annual exceedance probability floods and the flood of tropical storm Irene of August 2011 for cross sections A through I of the Ottauquechee River in Woodstock, Bridgewater, and Killington, Vermont ..... 3-2
- 3-2. Profiles of the 1-percent annual exceedance probability floods and the flood of tropical storm Irene of August 2011 for cross sections J through O of the Ottauquechee River in Woodstock, Bridgewater, and Killington, Vermont ..... 3-3
- 3-3. Profiles of the 1-percent annual exceedance probability floods and the flood of tropical storm Irene of August 2011 for cross sections p through U of the Ottauquechee River in Woodstock, Bridgewater, and Killington, Vermont ..... 3-4
- 3-4. Profiles of the 1-percent annual exceedance probability floods and the flood of tropical storm Irene of August 2011 for cross sections V through AA of the Ottauquechee River in Woodstock, Bridgewater, and Killington, Vermont ..... 3-5
- 3-5. Profiles of the 1-percent annual exceedance probability floods and the flood of tropical storm Irene of August 2011 for cross sections AB through AF of the Ottauquechee River in Woodstock, Bridgewater, and Killington, Vermont ..... 3-6
- 3-6. Profiles of the 1-percent annual exceedance probability floods and the flood of tropical storm Irene of August 2011 for cross sections AG through AM of the Ottauquechee River in Woodstock, Bridgewater, and Killington, Vermont ..... 3-7
- 3-7. Profiles of the 1-percent annual exceedance probability floods and the flood of tropical storm Irene of August 2011 for cross sections AN through AR of the Ottauquechee River in Woodstock, Bridgewater, and Killington, Vermont ..... 3-8
- 3-8. Profiles of the 1-percent annual exceedance probability floods and the flood of tropical storm Irene of August 2011 for cross sections AS through AZ of the Ottauquechee River in Woodstock, Bridgewater, and Killington, Vermont ..... 3-9
- 3-9. Profiles of the 1-percent annual exceedance probability floods and the flood of tropical storm Irene of August 2011 for cross sections BA through BE of the Ottauquechee River in Woodstock, Bridgewater, and Killington, Vermont ..... 3-10
- 3-10. Profiles of the 1-percent annual exceedance probability floods and the flood of tropical storm Irene of August 2011 for cross sections BF through BJ of the Ottauquechee River in Woodstock, Bridgewater, and Killington, Vermont ..... 3-11
- 3-11. Profiles of the 1-percent annual exceedance probability floods and the flood of tropical storm Irene of August 2011 for cross sections BK and BL of the Ottauquechee River in Woodstock, Bridgewater, and Killington, Vermont ..... 3-12



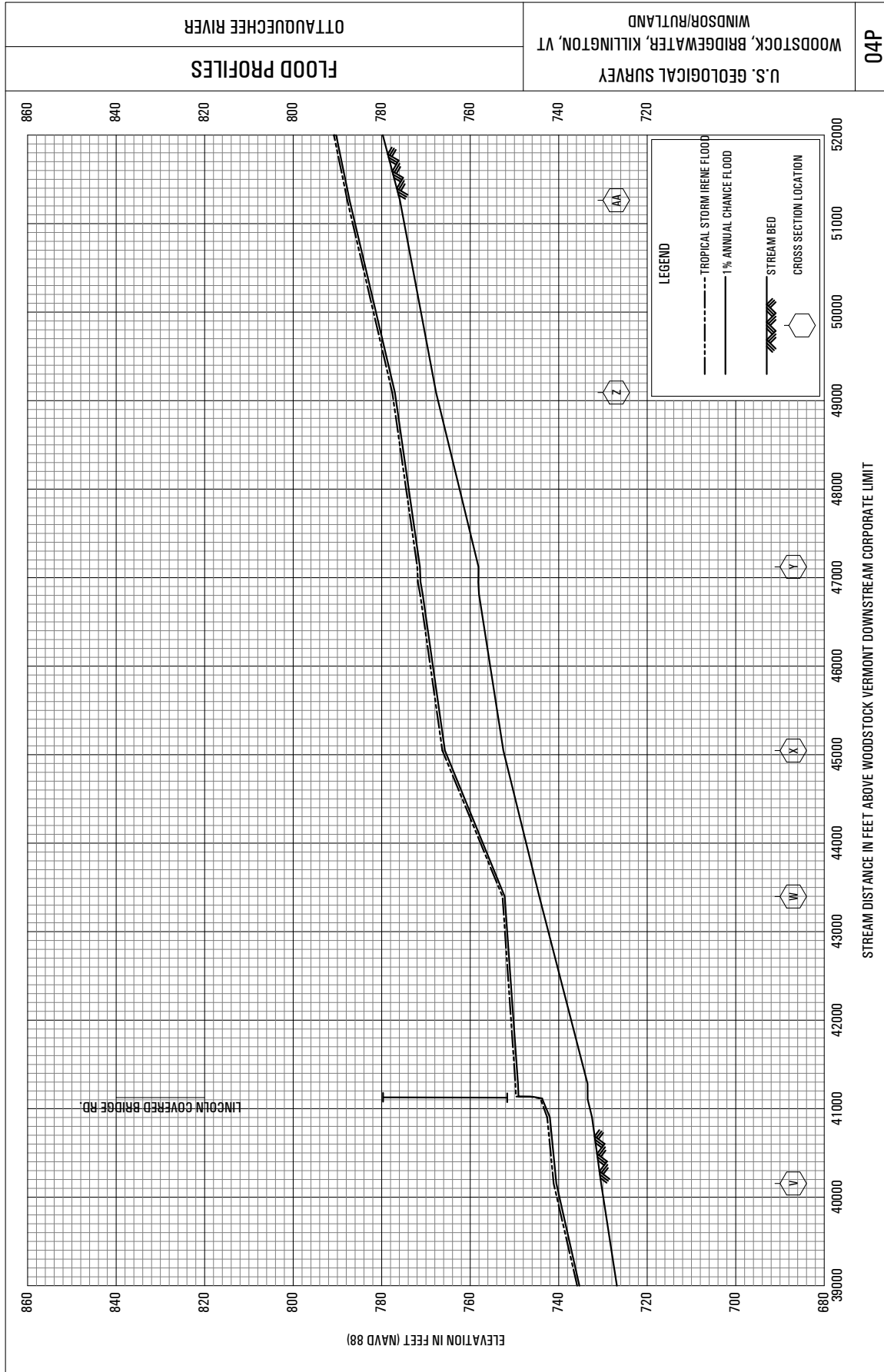
**Figure 3-1.** The 1-percent annual exceedance probability floods and the flood of tropical storm Irene of August 2011 for cross sections A through I of the Ottauquechee River in Woodstock, Bridgewater, and Killington, Vermont. NAVD 88, North American Vertical Datum of 1988; %, percent.



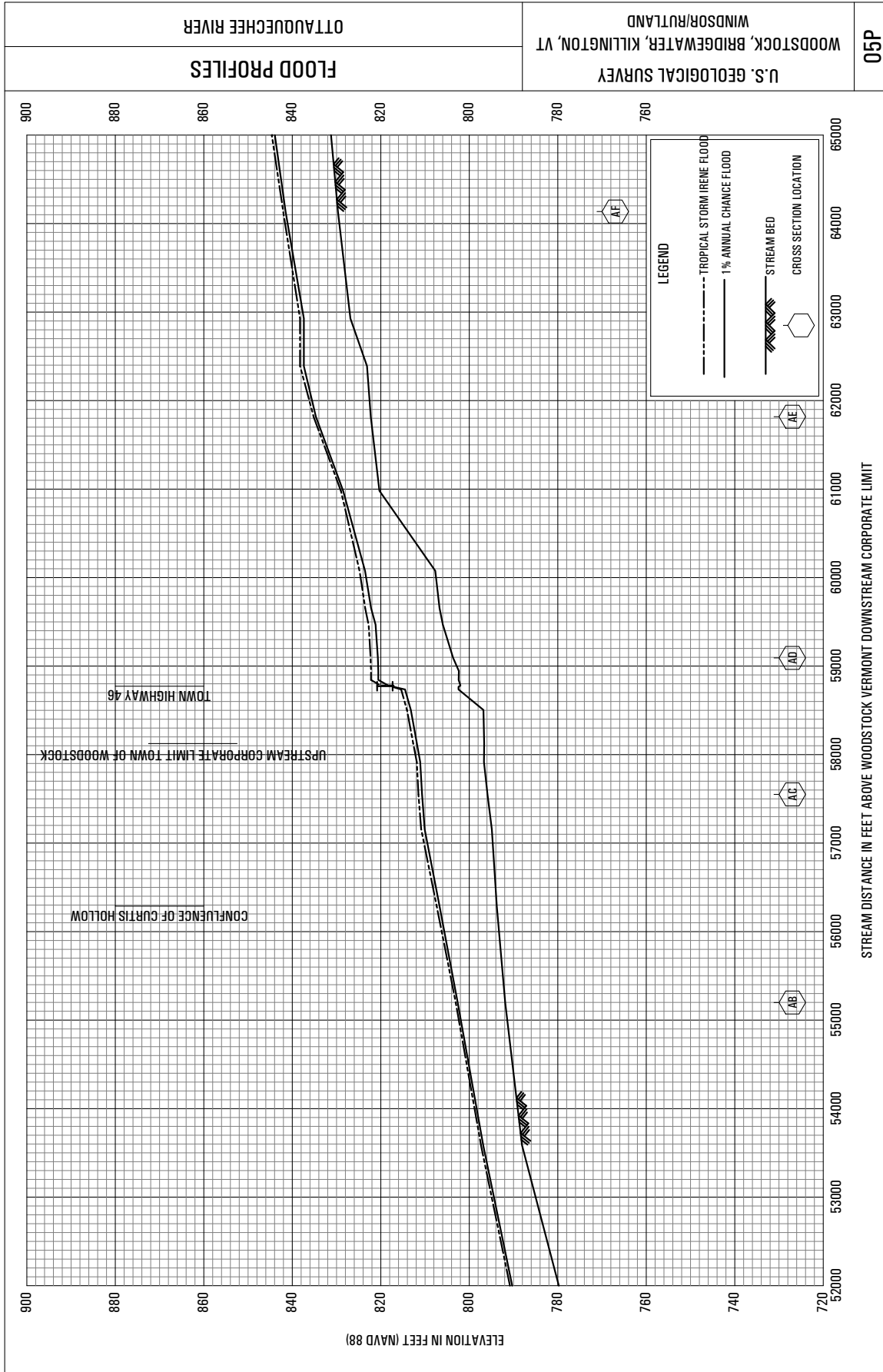
**Figure 3-2.** The 1-percent annual exceedance probability floods and the flood of tropical storm Irene of August 2011 for cross sections J through O of the Ottauquechee River in Woodstock, Bridgewater, and Killington, Vermont. NAVD 88, North American Vertical Datum of 1988; %, percent.



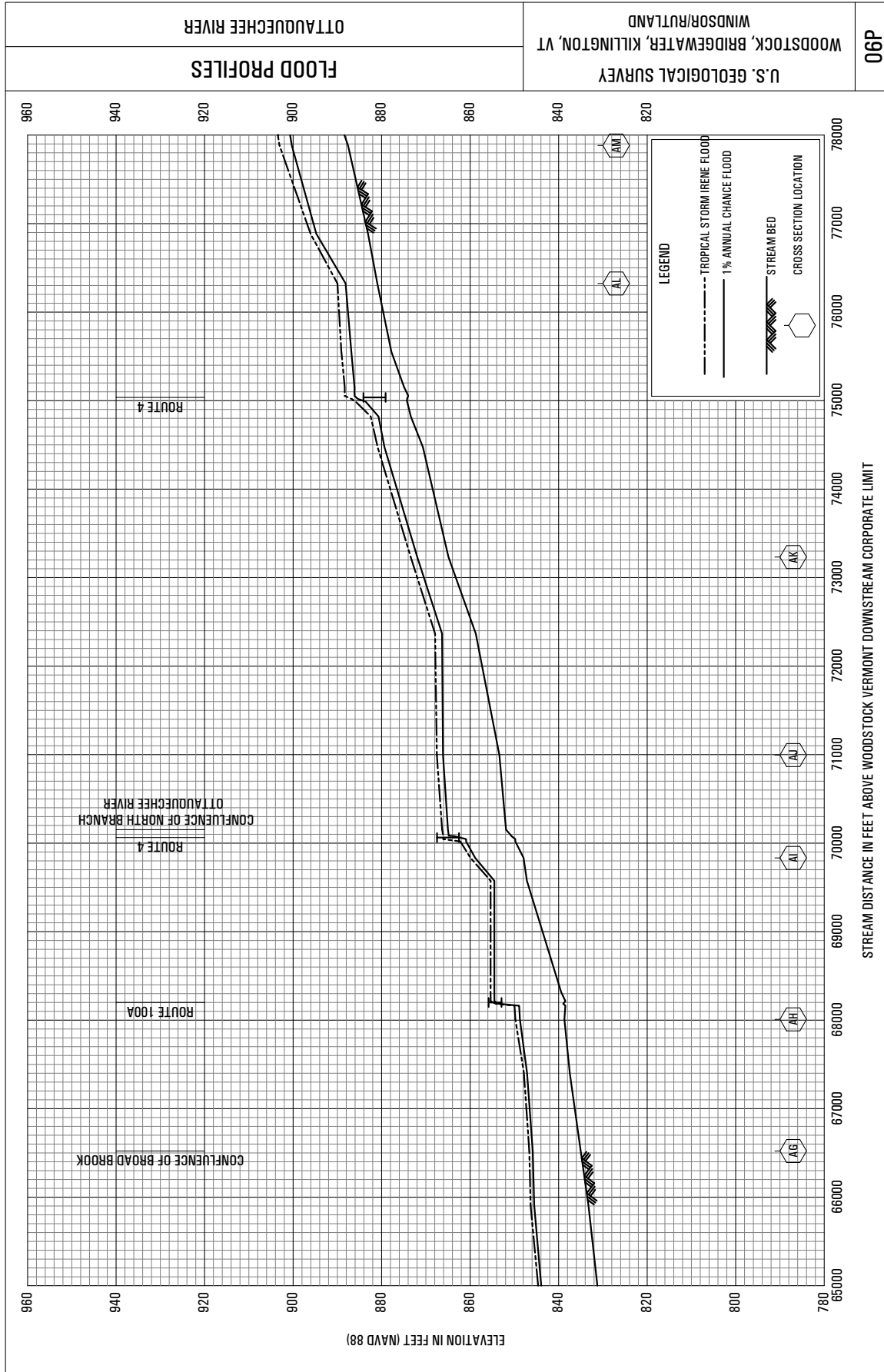
**Figure 3-3.** The 1-percent annual exceedance probability floods and the flood of tropical storm Irene of August 2011 for cross sections p through U of the Ottauquechee River in Woodstock, Bridgewater, and Killington, Vermont. NAVD 88, North American Vertical Datum of 1988; %, percent.



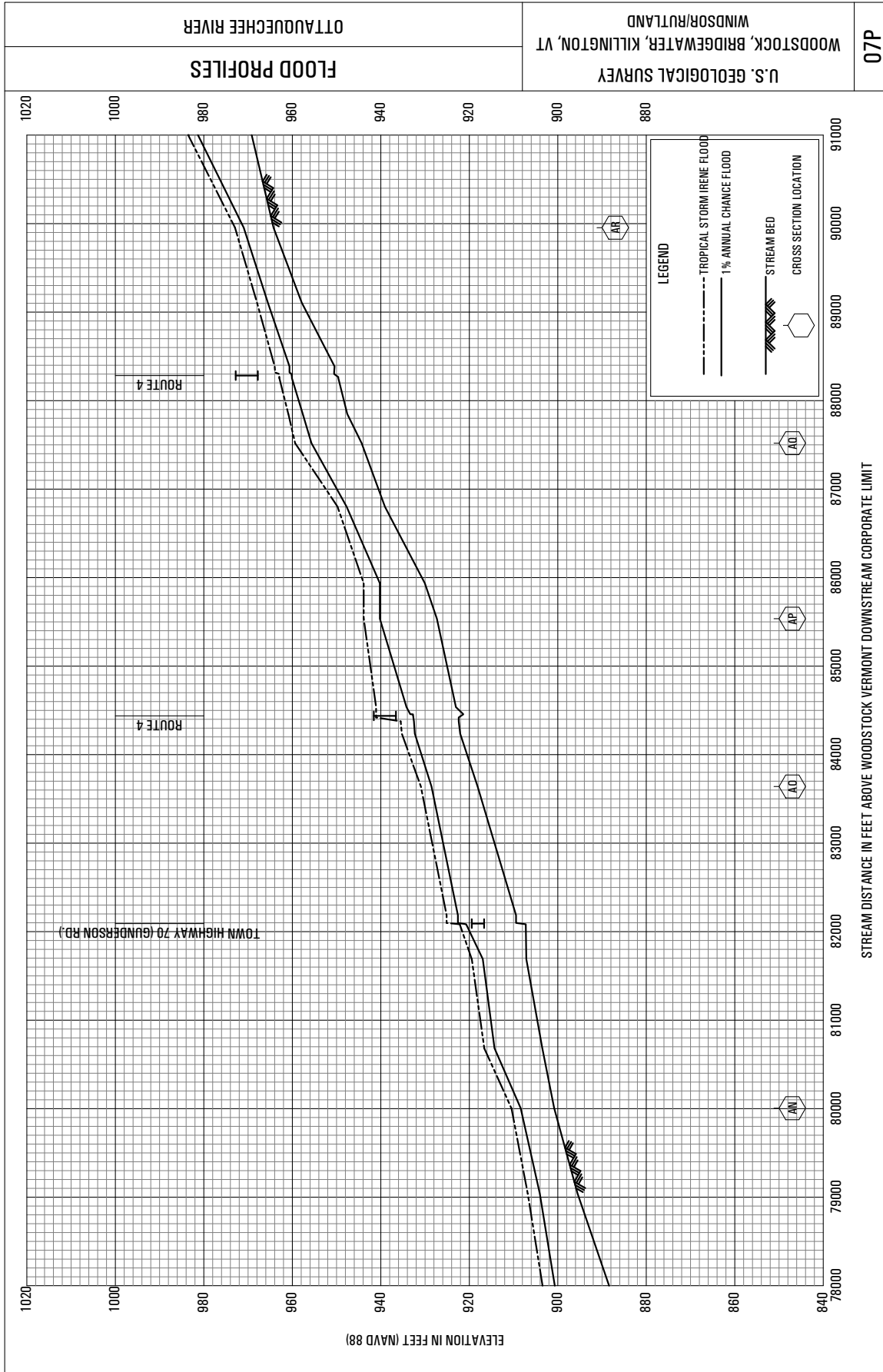
**Figure 3-4.** The 1-percent annual exceedance probability floods and the flood of tropical storm Irene of August 2011 for cross sections V through AA of the Ottauquechee River in Woodstock, Bridgewater, and Killington, Vermont. NAVD 88, North American Vertical Datum of 1988; %, percent.



**Figure 3-5.** The 1-percent annual exceedance probability floods and the flood of tropical storm Irene of August 2011 for cross sections AB through AF of the Ottauquechee River in Woodstock, Bridgewater, and Killington, Vermont. NAVD 88, North American Vertical Datum of 1988; %, percent.

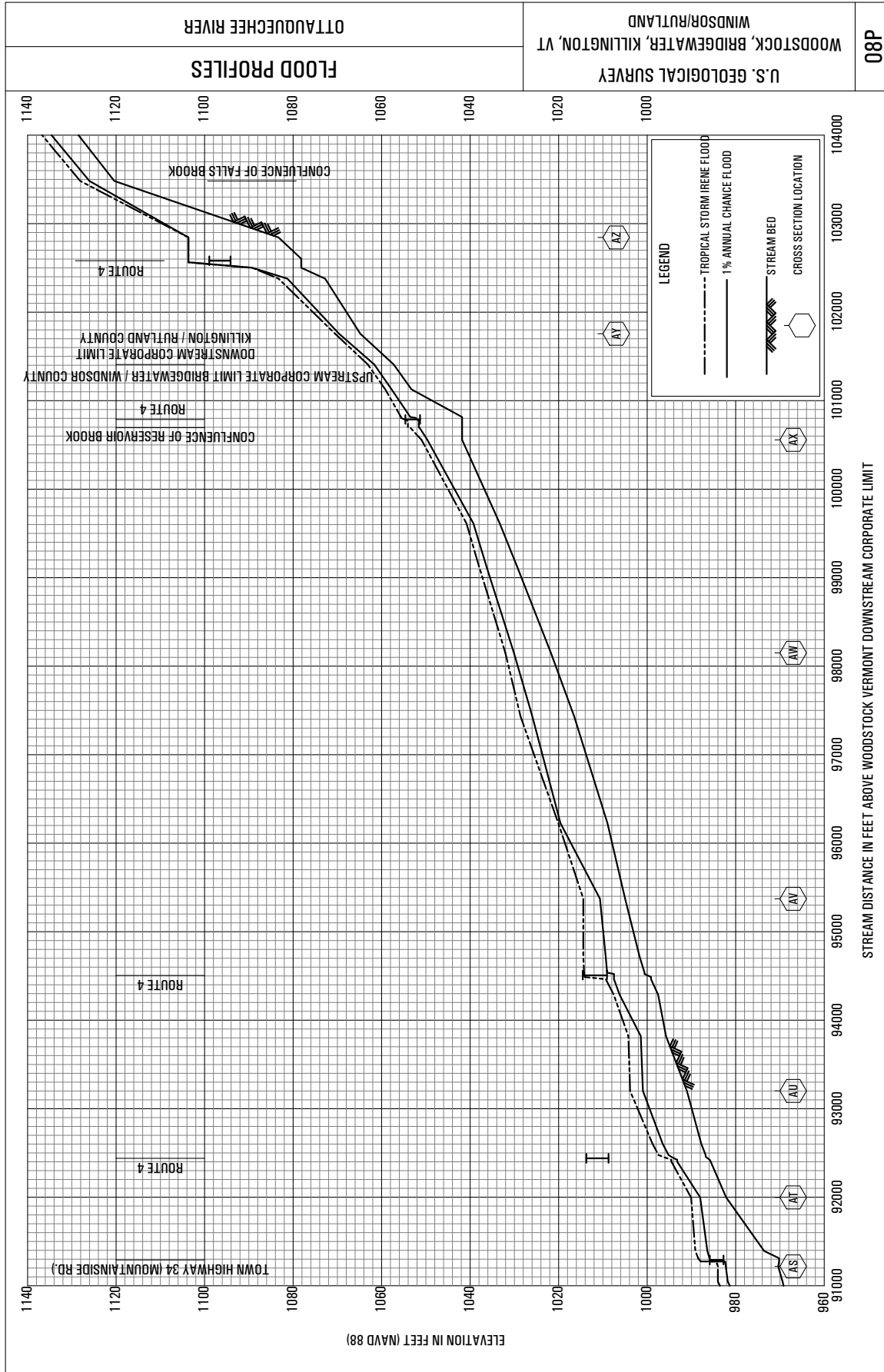


**Figure 3-6.** The 1-percent annual exceedance probability floods and the flood of tropical storm Irene of August 2011 for cross sections AG through AM of the Ottauquechee River in Woodstock, Bridgewater, and Killington, Vermont. NAVD 88, North American Vertical Datum of 1988; %, percent.

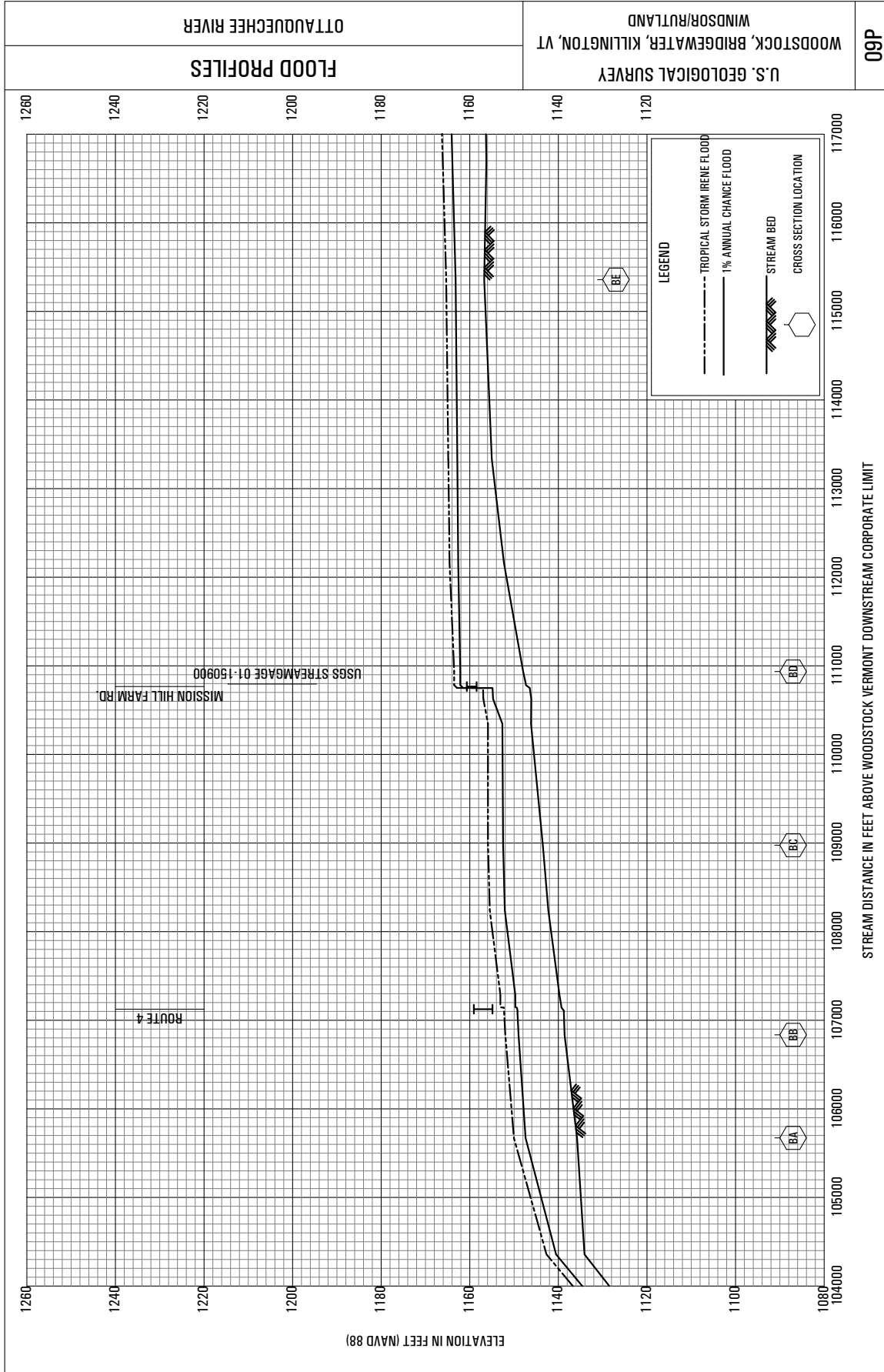


**Figure 3-7.** The 1-percent annual exceedance probability floods and the flood of tropical storm Irene of August 2011 for cross sections AN through AR of the Ottauquechee River in Woodstock, Bridgewater, and Killington, Vermont. NAVD 88, North American Vertical Datum of 1988; %, percent.

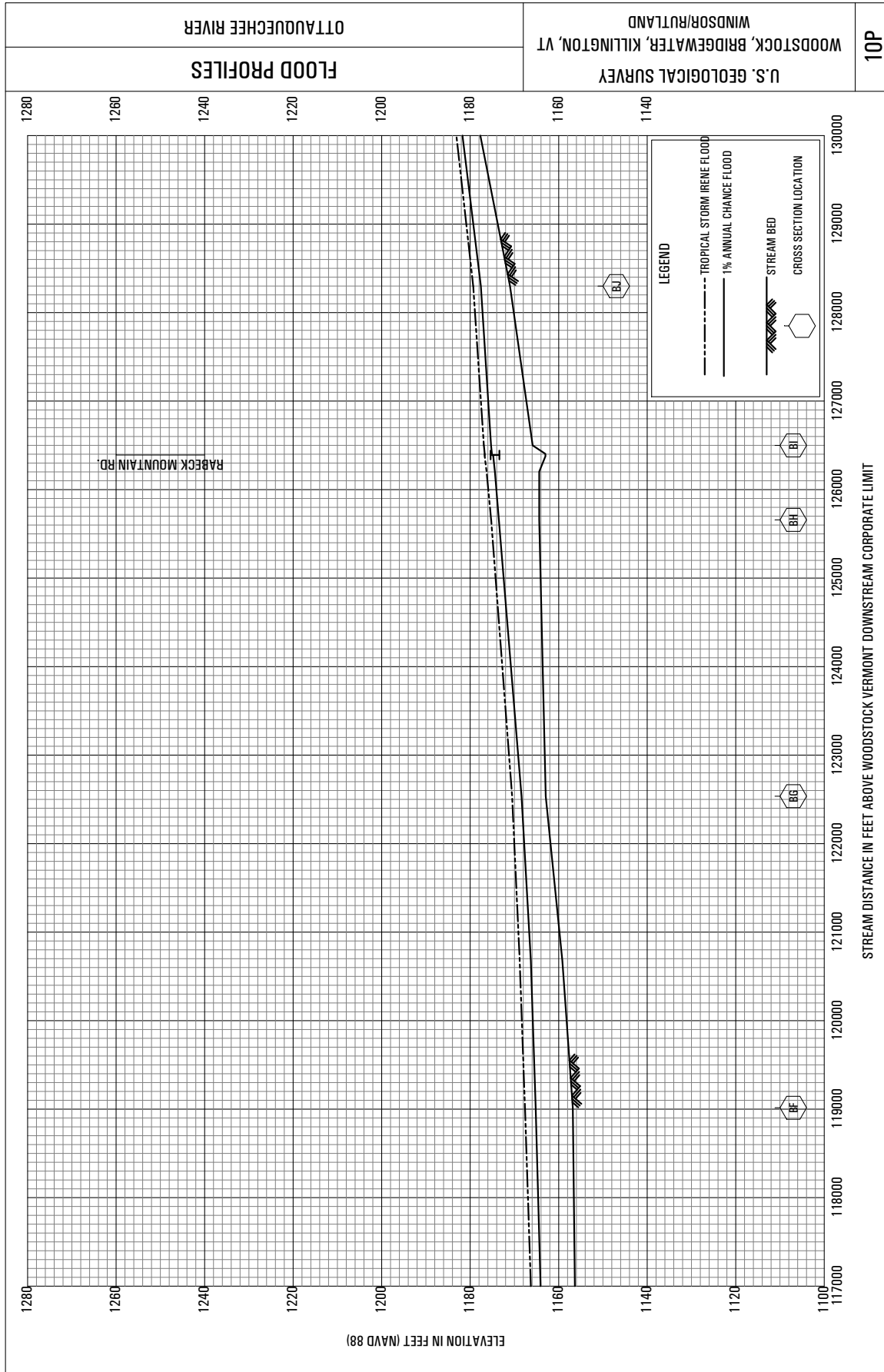




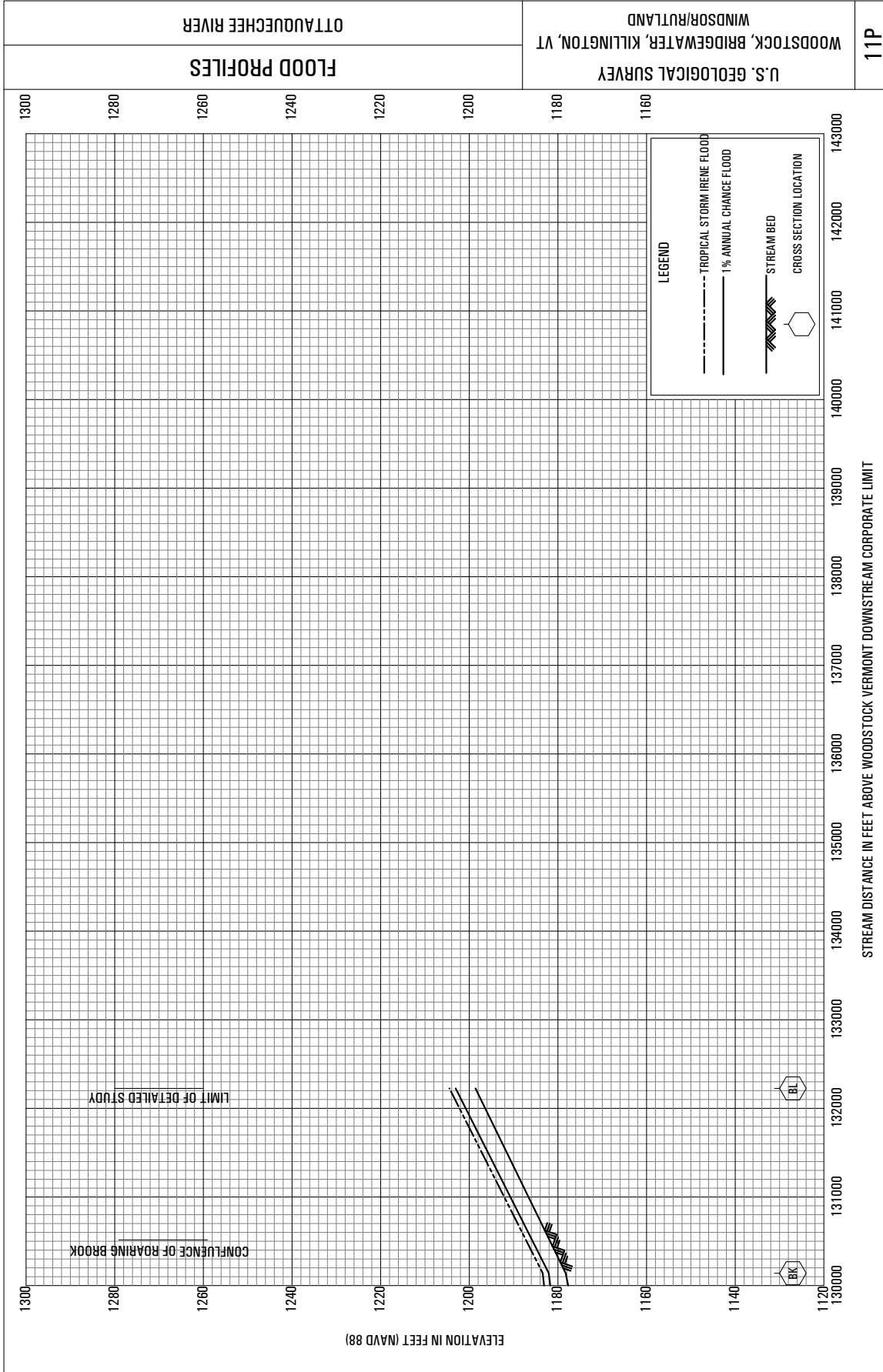
**Figure 3-8.** The 1-percent annual exceedance probability floods and the flood of tropical storm Irene of August 2011 for cross sections AS through AZ of the Ottauquechee River in Woodstock, Bridgewater, and Killington, Vermont. NAVD 88, North American Vertical Datum of 1988; %, percent.



**Figure 3-9.** The 1-percent annual exceedance probability floods and the flood of tropical storm Irene of August 2011 for cross sections BA through BE of the Ottauquechee River in Woodstock, Bridgewater, and Killington, Vermont. NAVD 88, North American Vertical Datum of 1988; %, percent.



**Figure 3-10.** The 1-percent annual exceedance probability floods and the flood of tropical storm Irene of August 2011 for cross sections BF through BJ of the Ottauquechee River in Woodstock, Bridgewater, and Killington, Vermont. NAVD 88, North American Vertical Datum of 1988; %, percent.



**Figure 3-11.** The 1-percent annual exceedance probability floods and the flood of tropical storm Irene of August 2011 for cross sections BK and BL of the Ottauquechee River in Woodstock, Bridgewater, and Killington, Vermont. NAVD 88, North American Vertical Datum of 1988; %, percent.