

(300)
76712
no. 59

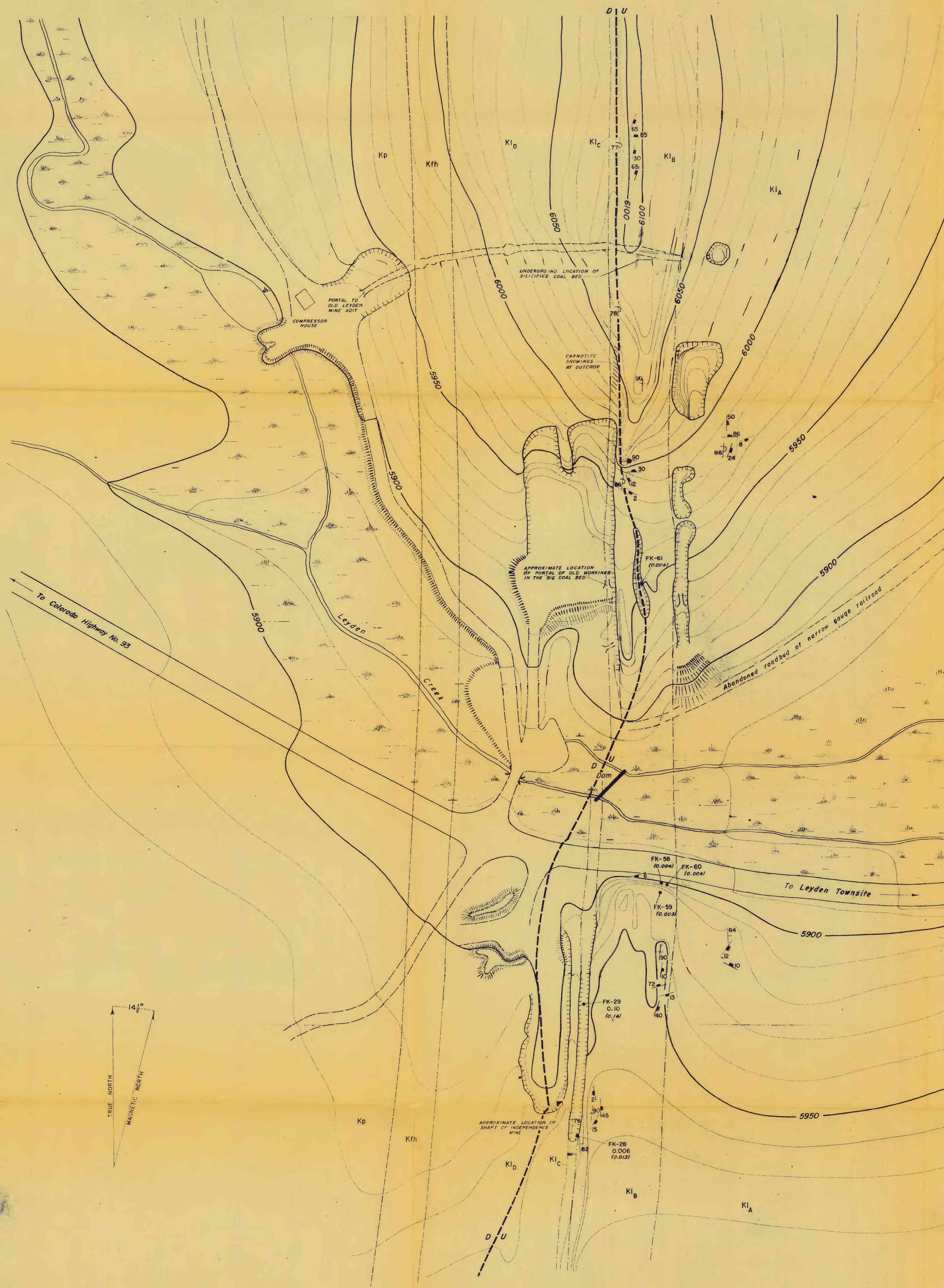

EXPLANATION

- K1A
Zone A
(Silty claystone, sandstone, coal)
 - K1B
Zone B
(Ridge-forming silicified sandstone and claystone)
 - K1C
Zone C
(Big coal bed and carbonaceous claystone.)
 - K1D
Zone D
(Claystone, sandstone, coal)
 - Kfh
Friable sandstone, claystone
 - Kp
Shale, claystone, sandstone
- CRETACEOUS
- Approximate contact
 - Lithologic zone boundary within Laramie formation
 - D U --- Inferred fault
D-Downthrown side; U-upthrown side
 - Strike and dip of beds
 - Strike and dip of overturned beds
 - Strike of vertical beds
 - Strike and dip of joint
 - Strike of vertical joint
 - Vertical shaft
 - Open cut or caved workings
 - Dump
 - Portal of adit
 - Swamp
 - Sample location, sample number, percent uranium, (percent equivalent uranium)

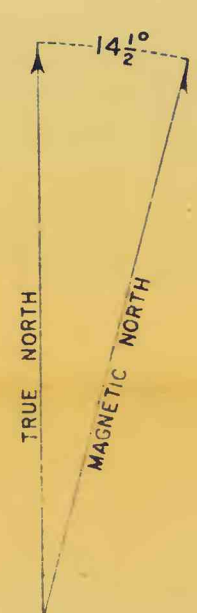

PLEASE REPLACE IN POCKET
IN BACK OF BOUND VOLUME

After figure 2, McKeown and Gude, 1951

FIGURE 26.-- GEOLOGIC MAP OF THE OLD LEYDEN COAL MINE AREA, JEFFERSON COUNTY, COLORADO

