

PLAN AND PROFILE  
 NISQUALLY RIVER, WASHINGTON

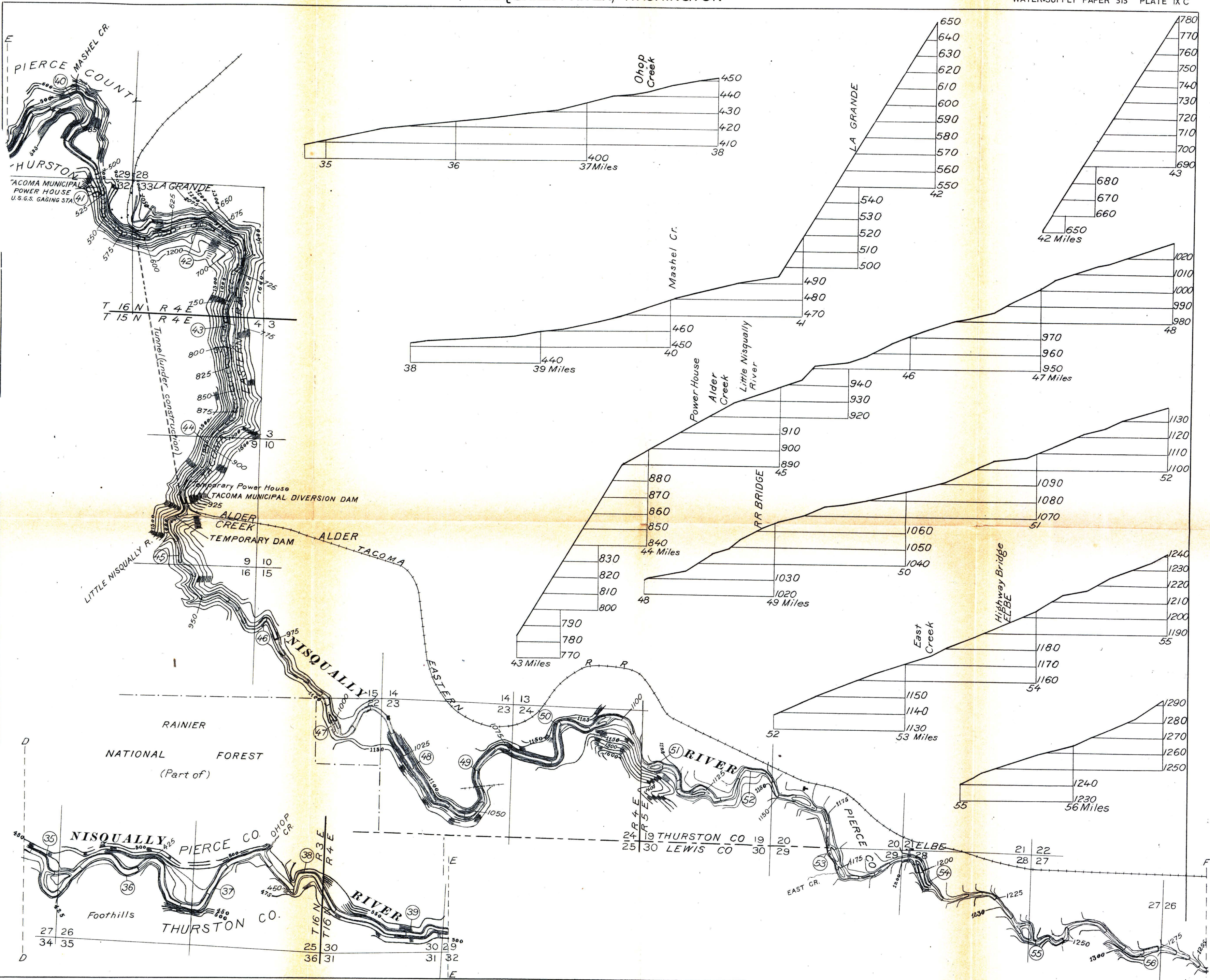

R. B. Marshall, Chief Geographer  
 T. G. Gardine, Geographer in charge  
 Topography by Bayard Knock  
 Surveyed in 1910  
 SURVEYED IN COOPERATION WITH THE STATE OF WASHINGTON

TRUE NORTH  
 MAGNETIC NORTH  
 APPROXIMATE MEAN DECLINATION 1910.

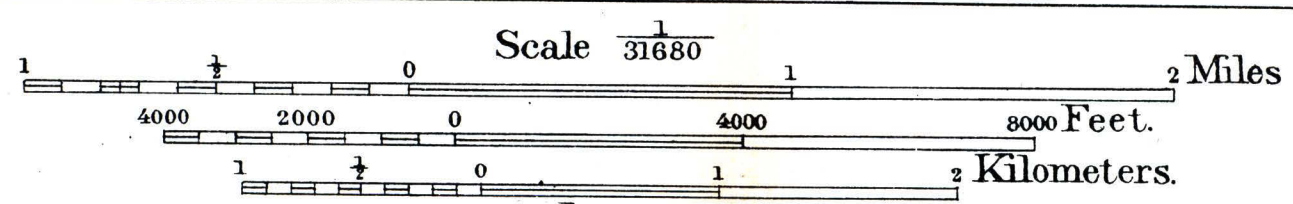

Contour interval 5 feet.  
 Datum is mean sea level.

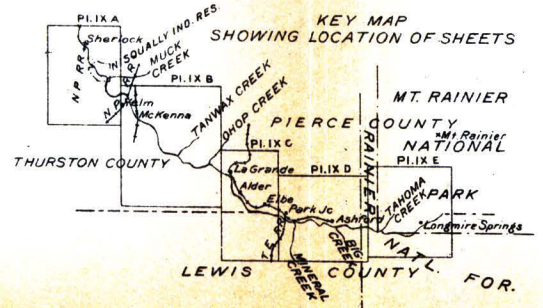

5 SHEETS