

PLAN AND PROFILE OF
 CLARK FORK,
 ST. REGIS, MONTANA, TO PEND OREILLE LAKE, IDAHO

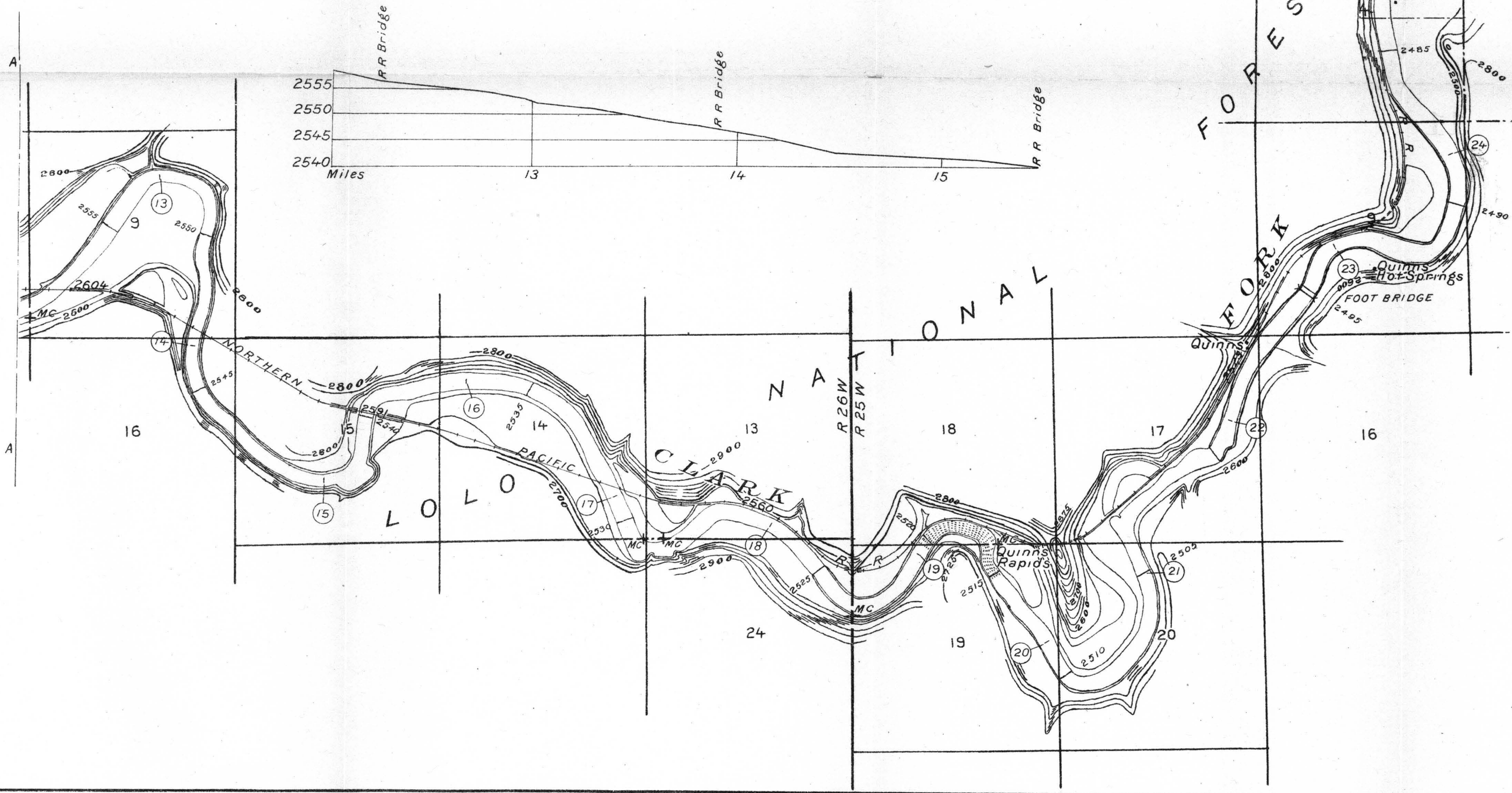

R. B. Marshall, Chief Geographer
 Sledge Tatum, Geographer in charge
 Topography by R. C. Seitz
 Surveyed in 1911

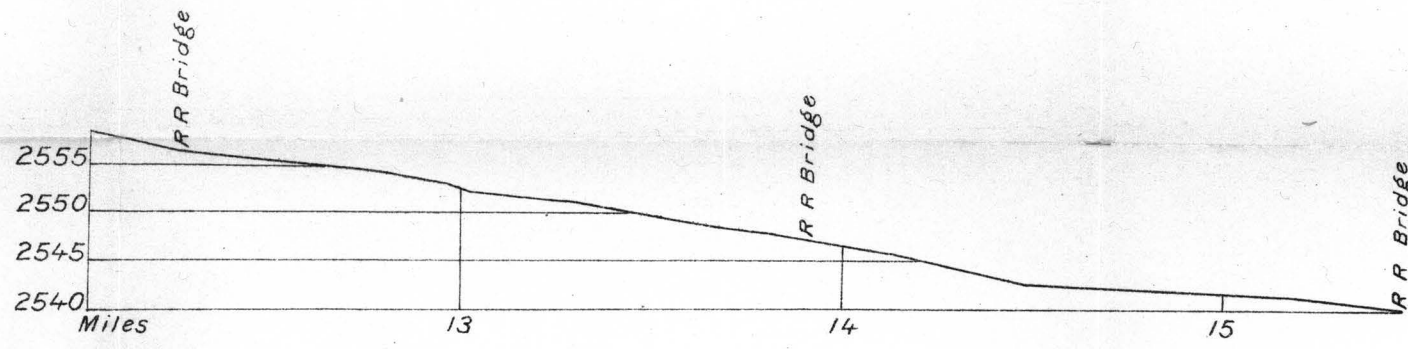
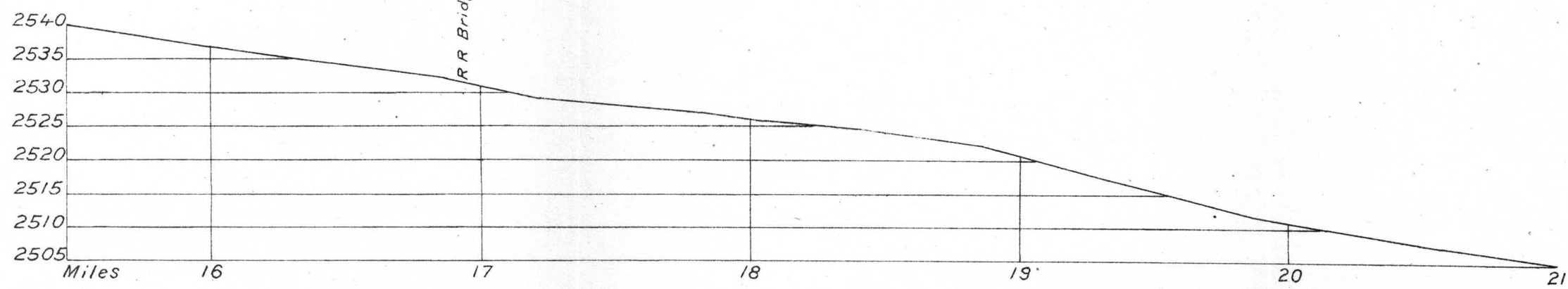
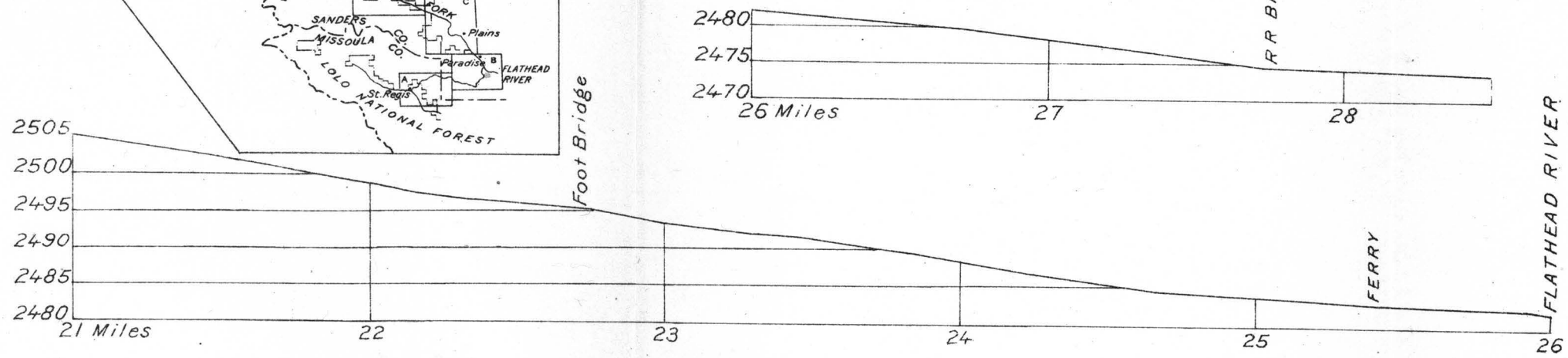
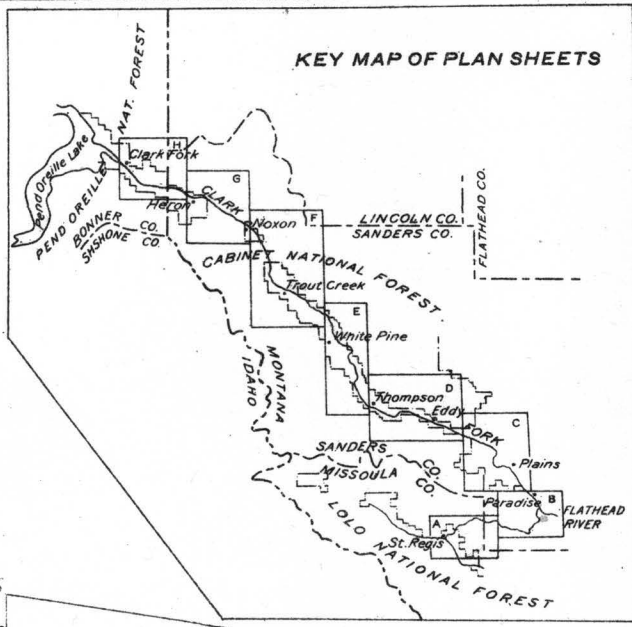
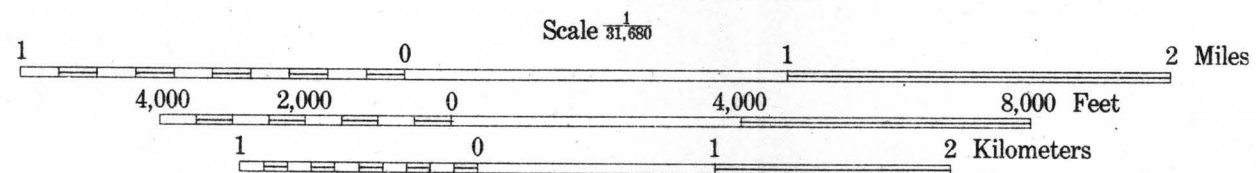
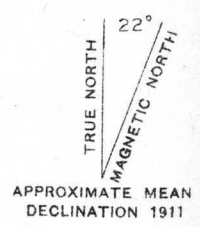

Vertical scale 1 inch = 20 feet
 Contour interval on land 25 feet
 Contour interval on river surface 5 feet
 Datum is mean sea level
 1914

DIAGRAM OF TOWNSHIP

6	5	4	3	2	1
7	8	9	10	11	12
13	14	15	16	17	18
19	20	21	22	23	24
25	26	27	28	29	30
31	32	33	34	35	36