

PLAN AND PROFILE OF
 MIDDLE FORK OF WILLAMETTE RIVER
 ABOVE OAKRIDGE, OREGON

SHEET D

WATER-SUPPLY PAPER 378, PLATE IV

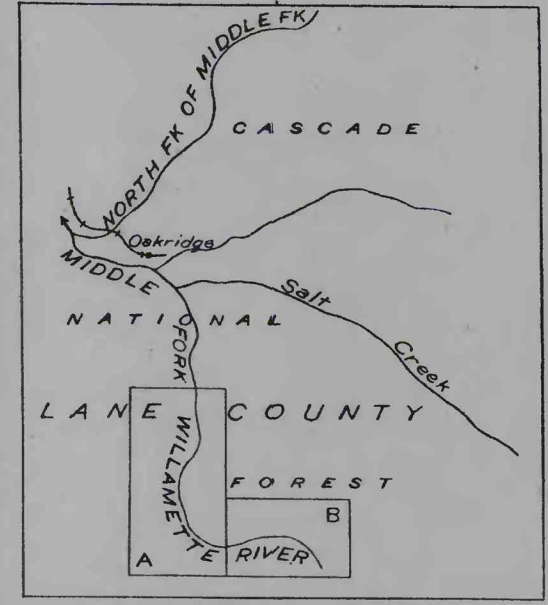
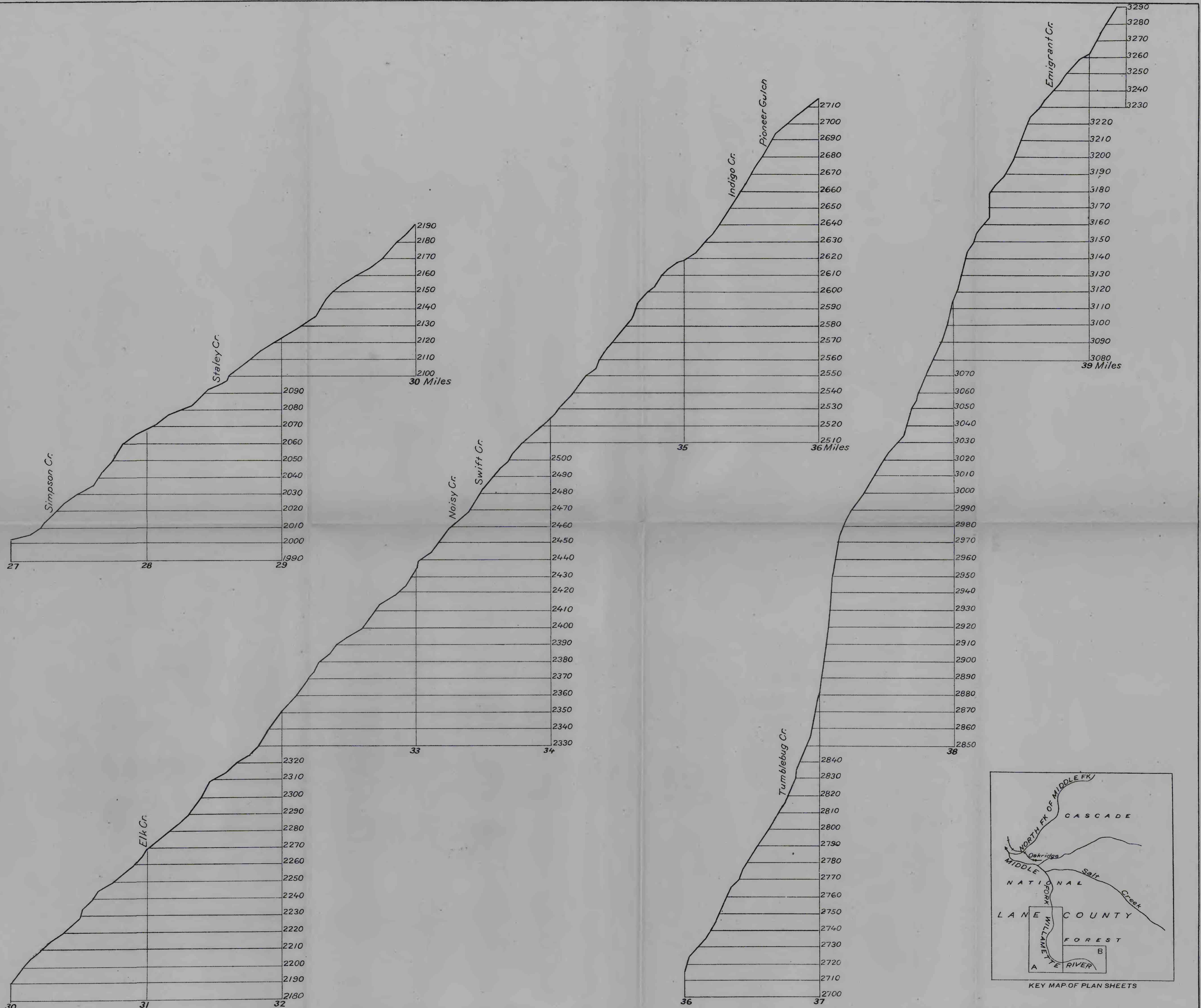

R. B. Marshall, Chief Geographer
 T. G. Gardine, Geographer in charge
 Topography by C. P. McKinley
 Surveyed in 1914
 SURVEYED IN COOPERATION WITH THE STATE OF OREGON

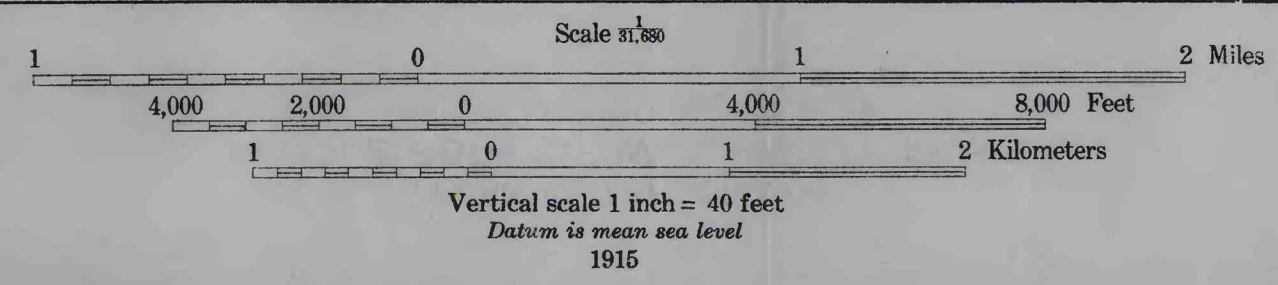

Subject to adjustment
 4 SHEETS
 (2 plans, 2 profiles)