

EXPLANATION

● 275
300-604
Well that taps Pleistocene and Recent alluvium
Upper number indicates altitude of water level in December, 1958; lower numbers indicate perforated interval, or reported depth of well

— 7 —
Water-level contour for the main water body in Pleistocene and Recent alluvium
Contours queried where uncertain. Contour interval 10 and 20 feet. Datum is mean sea level

○ 281
239-328
Well that taps a shallow, semiperched water body
Upper number indicates altitude of water level in December, 1958; lower numbers indicate perforated interval, or reported depth of well

— 10 —
Water-level contour for the shallow semiperched water body
Contours queried where uncertain. Contour interval 10 feet. Datum is mean sea level

— — — — —
Approximate southern edge of area in which wells of average depth chiefly tap the Kern River formation of Diepenbrock, 1933

▲ 304
600-1280
Well that taps undifferentiated marine and continental rocks of Tertiary age
Upper number indicates altitude of water level in December, 1958; lower numbers indicate perforated interval, or reported depth of well

□
Flowing well

△ 782
Well for which hydrograph is shown in text

.....
Ground-water barrier
Queried where uncertain

— — — — —
Canal

—————
Consolidated and semiconsolidated rocks bordering the valley

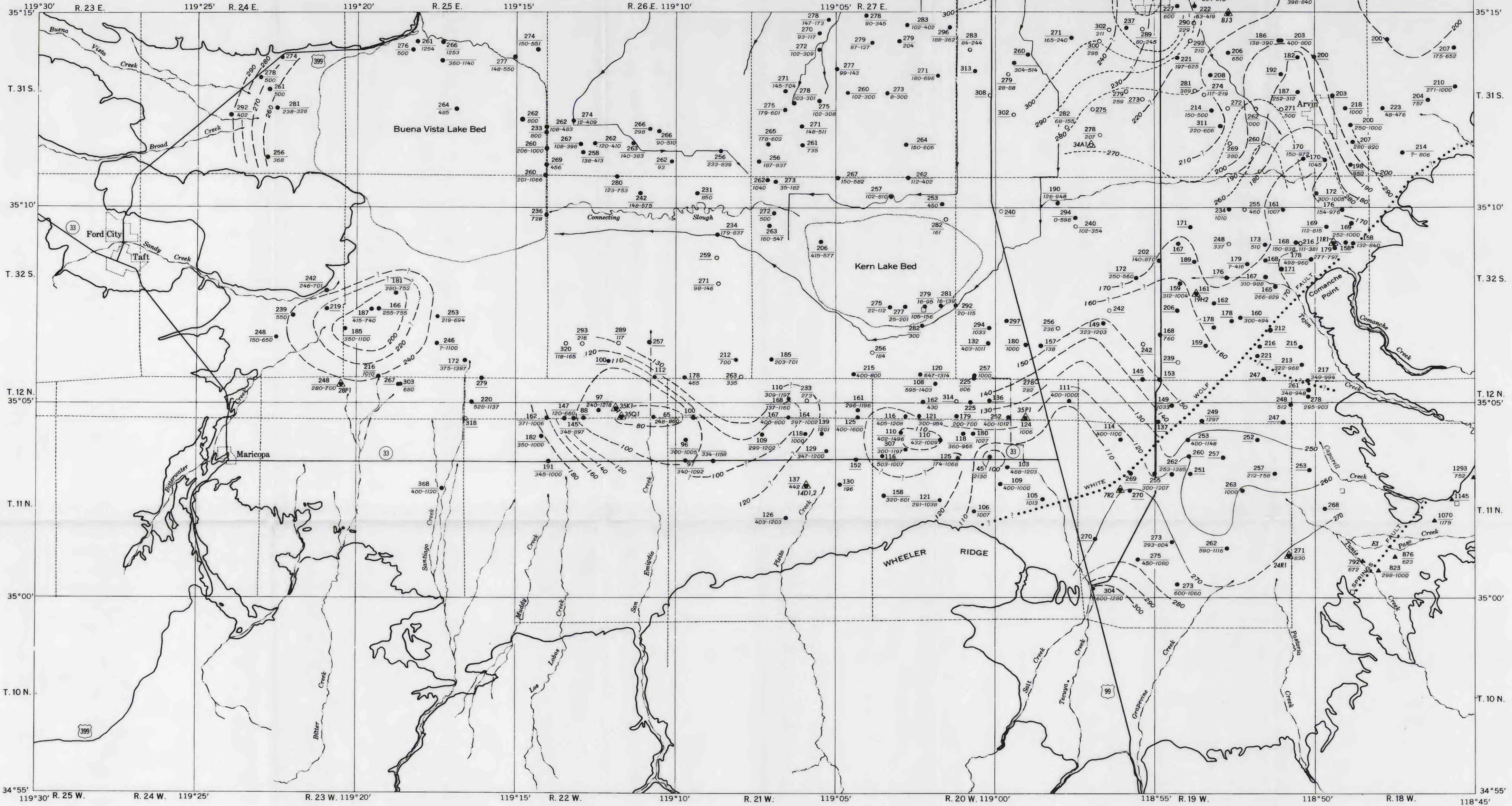

WATER-LEVEL CONTOURS FOR THE MAIN WATER BODY IN THE EDISON-MARICOPA AREA, CALIFORNIA, DECEMBER 1958

